

# Architectural Door Accessories

**ASSA ABLOY**  
Opening Solutions

## Rim Cylinder Replacement Instructions For Locking Door Pulls

Experience a safer  
and more open world

### 1. Remove Rim Cylinder

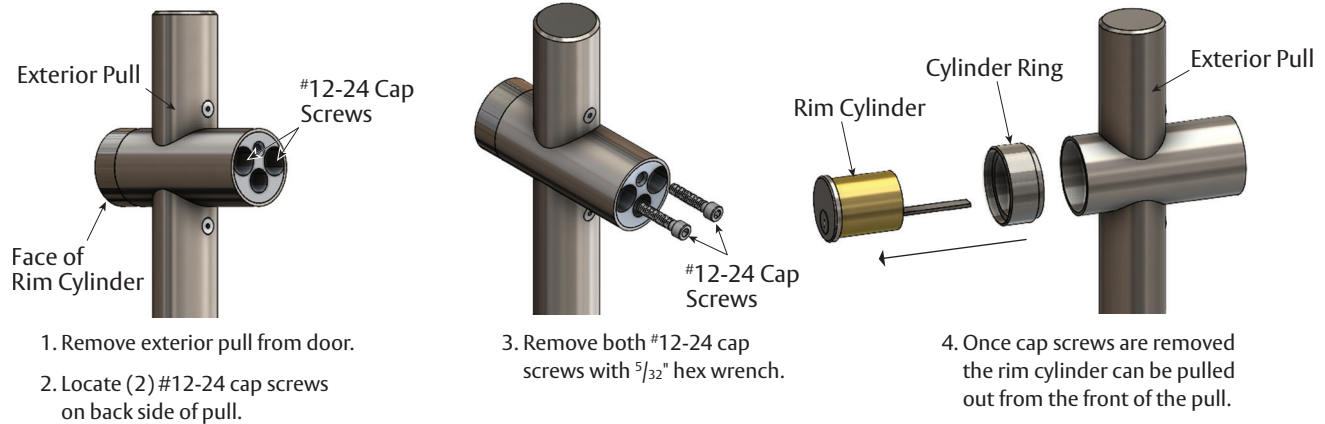

### 2. Install Replacement Rim Cylinder

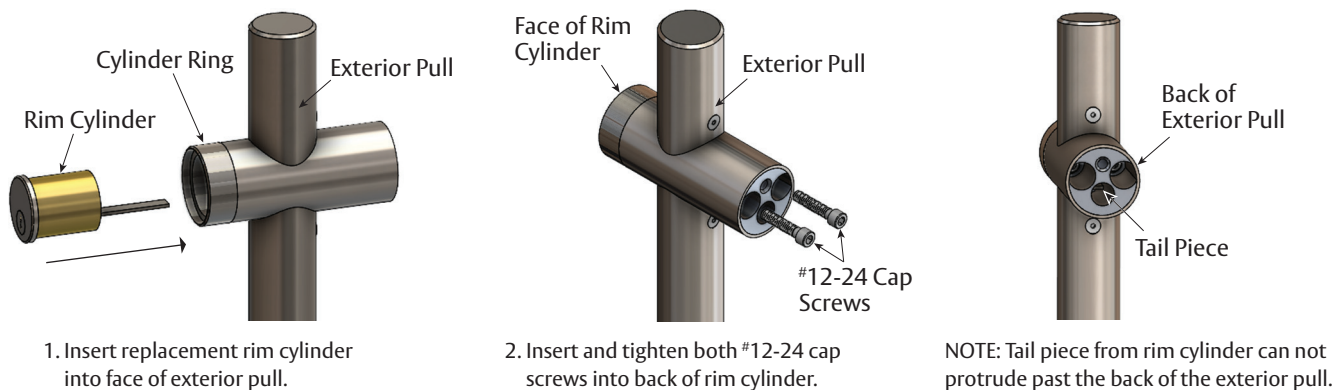

### Tail Piece Length Specifications

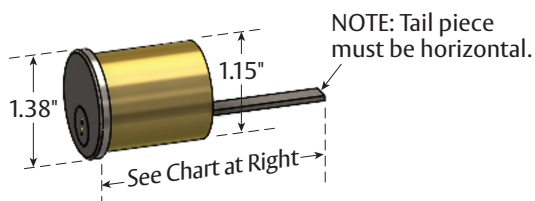

Door Thickness	Min. Length	Max. Length
$\frac{3}{8}$ "	$2 \frac{1}{8}$ "	$3 \frac{1}{8}$ "
$\frac{1}{2}$ "	$2 \frac{1}{2}$ "	$3 \frac{1}{4}$ "
$\frac{3}{4}$ "	$2 \frac{3}{4}$ "	$3 \frac{1}{4}$ "
$\frac{7}{8}$ "	3"	$3 \frac{1}{4}$ "
$1 \frac{3}{8}$ "	$2 \frac{1}{8}$ "	$3 \frac{1}{8}$ "
$1 \frac{3}{4}$ "	$2 \frac{1}{2}$ "	$3 \frac{1}{4}$ "
2"	$2 \frac{3}{4}$ "	$3 \frac{1}{4}$ "
$2 \frac{1}{4}$ "	3"	$3 \frac{1}{4}$ "
$2 \frac{1}{2}$ "	$3 \frac{1}{4}$ "	$3 \frac{1}{4}$ "

ASSA ABLOY Opening Solutions  
Architectural Accessories Group  
Rockwood, PA  
P: 800.458.2424 • F: 800.922.9212  
[www.assaabloydooraccessories.us](http://www.assaabloydooraccessories.us)

Copyright © 2010-2021, ASSA ABLOY Accessories and Door Controls Group, Inc. All rights reserved. Reproduction in whole or in part without the express written permission of ASSA ABLOY Accessories and Door Controls Group, Inc. is prohibited.

I-30120 05/21