

PEMKO HIDE SLIDE™, PATENT PENDING

Experience a safer
and more open world

Applies to the following sliding barn door system:

HIDESLIDE

- For doors up to 176lbs each
- For doors 31" to 71" wide
- For doors 1-3/4" thick (contact factory for other door thicknesses)
- 3 clearance options from door face to wall: 9/16", 1-1/16", 1-9/16"

FASTENERS:

4	#8 x 5/8" Pan Head	Bottom Wheels
52	#8 x 5/8" Flat Head	Bottom Wheel Cases, Track
4	#8 x 7/8" Pan Head	Safety Stops
2	#8 x 1-1/8" Flat Head w/plastic anchors	Bottom Guide
4	#8 x 2" Flat Head	Top Hanger

Tools Required:

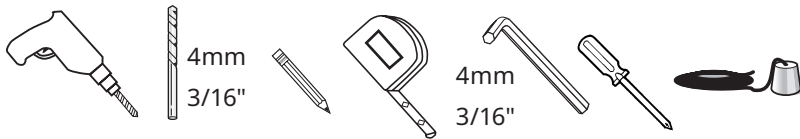

Included:

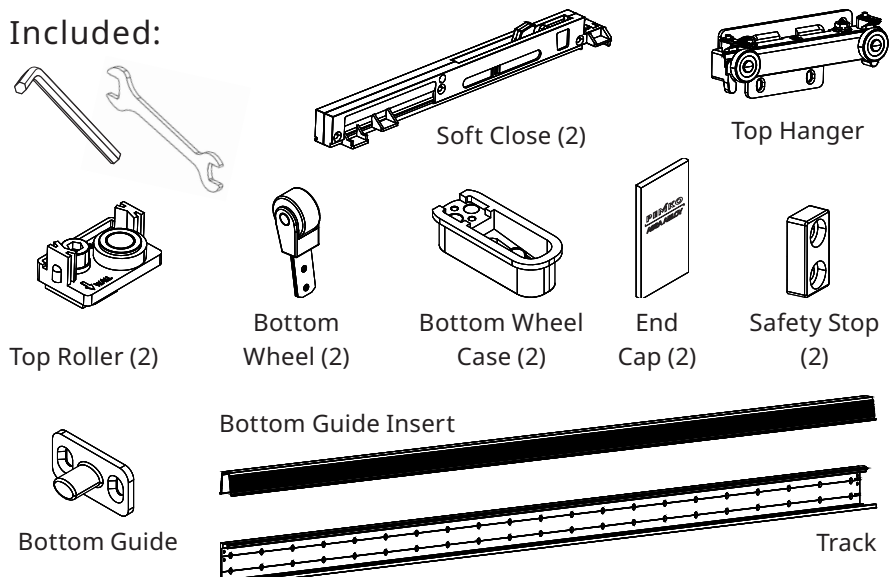

WARNING:

Top hanger must be installed into wall blocking. Questions about wall blocking type required should be directed to a structural engineer.

Read Before Instructions:



The instructions are for a 1-3/4" thick door. For other door thicknesses please consult the factory.

1. Door prep.

Verify route at top of door to fit track for desired clearance.

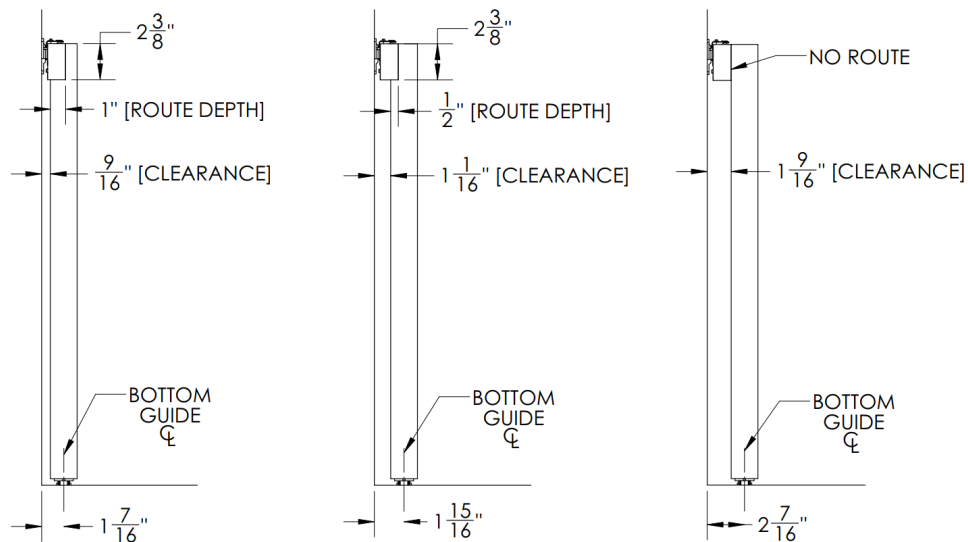

Verify route at bottom of door to fit bottom wheel cases and bottom guide insert.

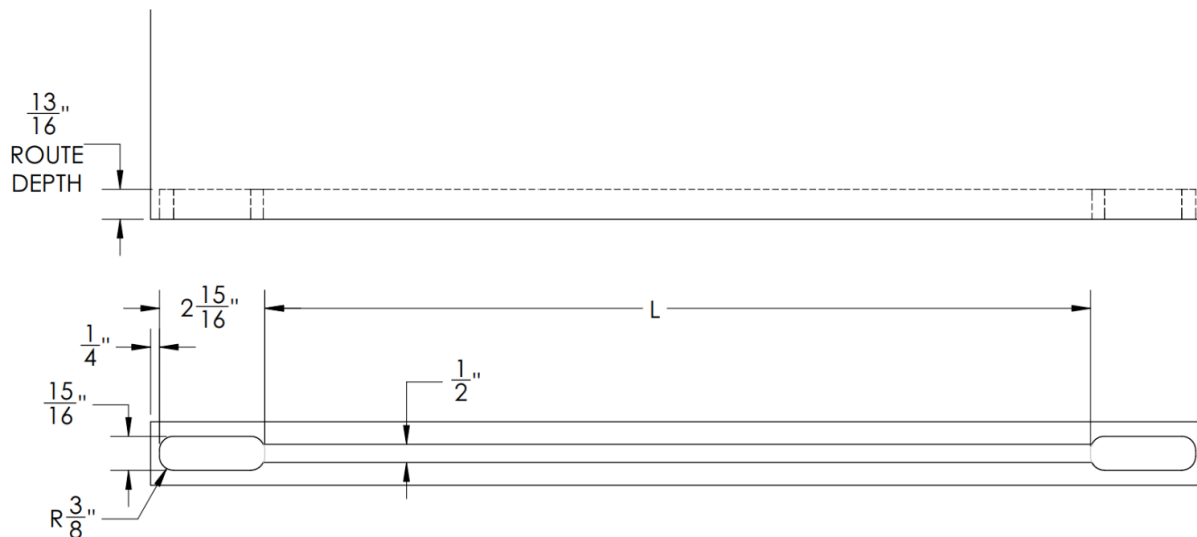

2. Prep top of door components.



Cut track to length and drill $\varnothing 4\text{mm}$ ($3/16''$) holes on track ends for safety stops.

Note: Length of track should be equal to width of door minus 6mm ($1/4''$).

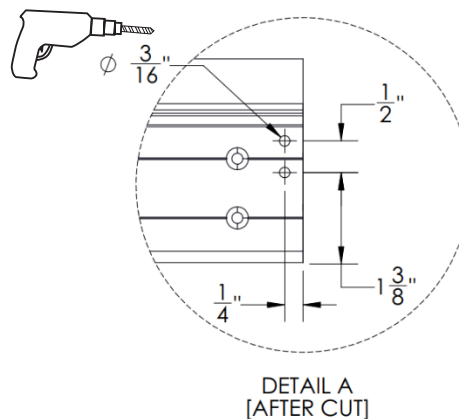

Set both soft close device triggers to "activated" position.

Insert end caps into top rollers.

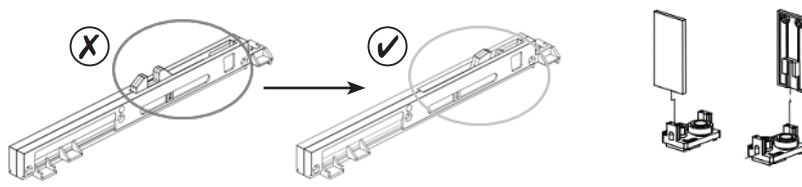

3. Install track and stops to door.

Install track in door with #8 x $5/8''$ flat head screws.

Note: Ensure track is inset $1/8''$ from each edge of door.

Install two (2) safety stops into ends of track/door using four (4) #8 x $7/8''$ pan head screws.

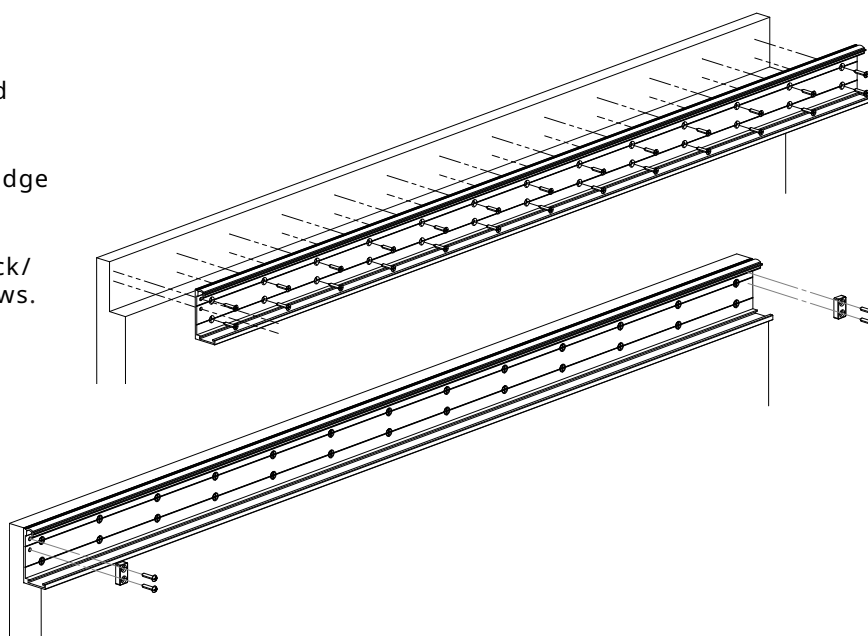

4. Install soft close devices and top rollers.

Insert two (2) soft close devices into track oriented as shown.

Insert top rollers into track as shown.

Note: Top roller wheels MUST be installed toward wall to prevent contact between door and wall. Part is imprinted to assist installation.

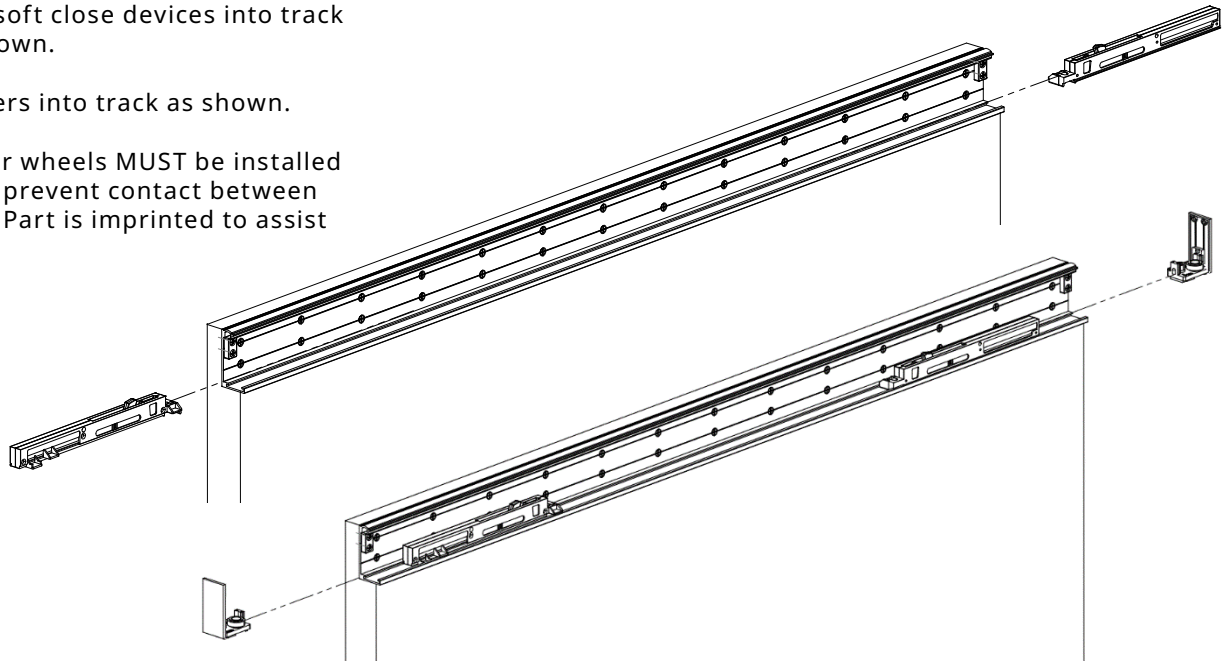

5. Install bottom guide insert into bottom of door.

Cut bottom guide insert to length as shown.

Apply a suitable adhesive to top of guide insert.

Press guide into routed channel in bottom of door.

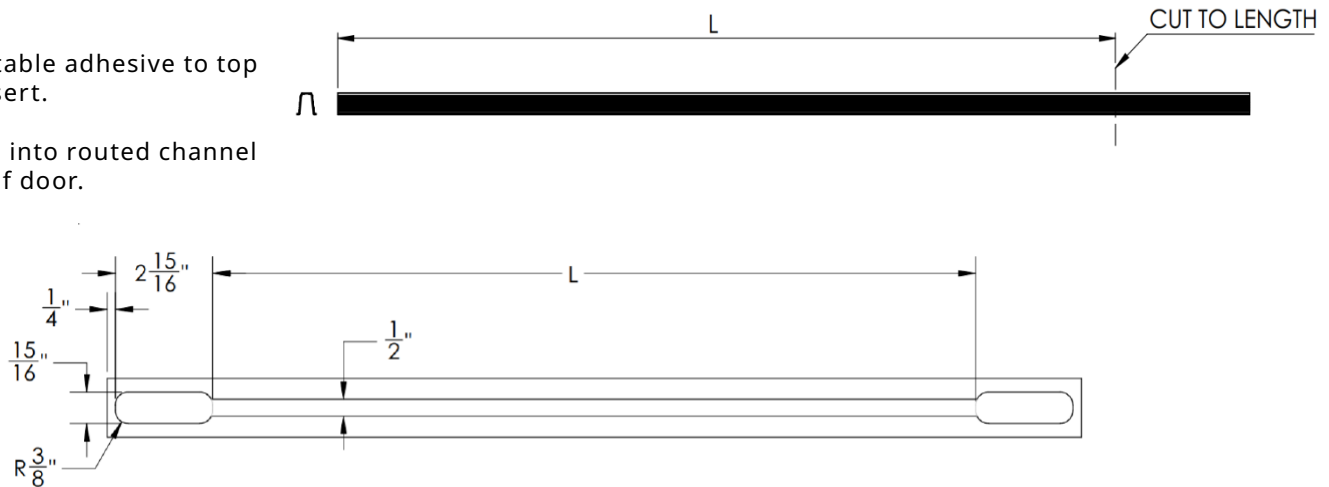

6. Install bottom wheels.

Install bottom wheel cases into routed holes on both ends of door using eight (8) #8 x 5/8" flat head screws.

Using four (4) #8 x 5/8" pan head screws, attach wheel sets to both cases.

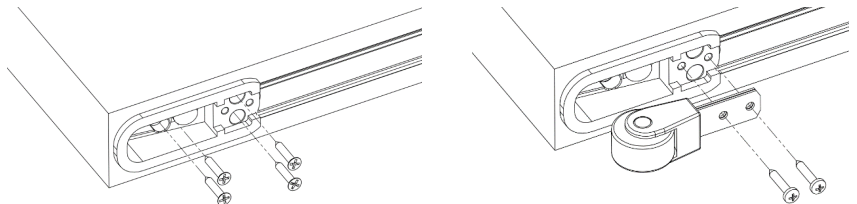

PEM/KO
ASSA ABLOY

Experience a safer
and more open world

7a. Determine vertical position of hanger.

Vertical hanger position is height of door plus 3/4". Example: If height of door is 84", vertical position of top of hanger is 84-3/4".

IMPORTANT NOTE:

If using 18/1A bottom floor track, measure door height plus 7/8" (instead of door height plus 3/4") and mark as shown.

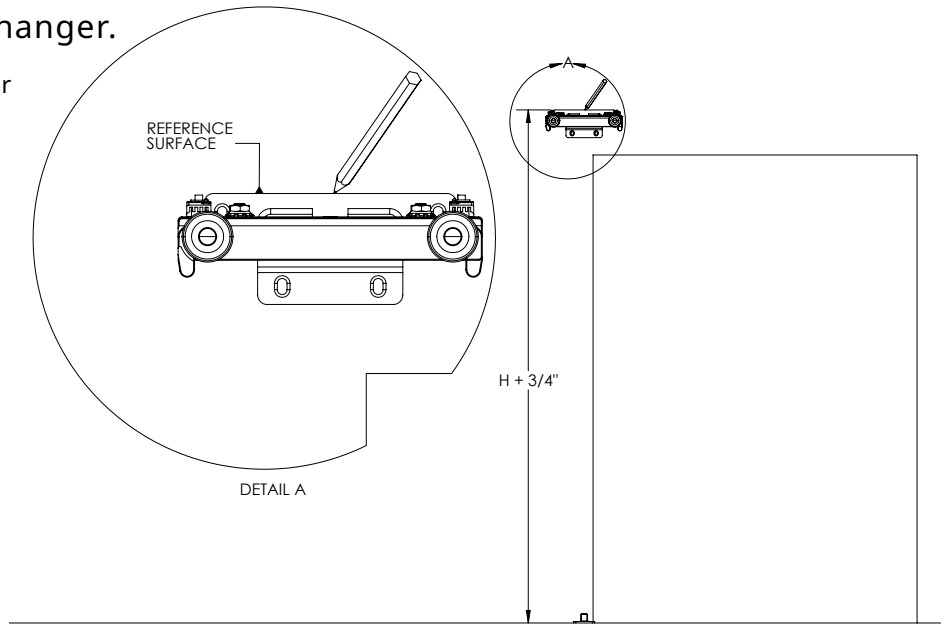

7b. Determine horizontal position of hanger.

OW = Opening Width
DW = Door Width

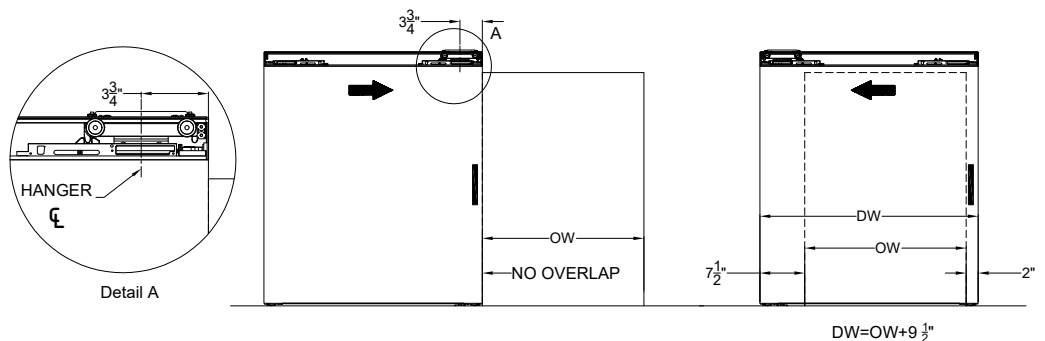
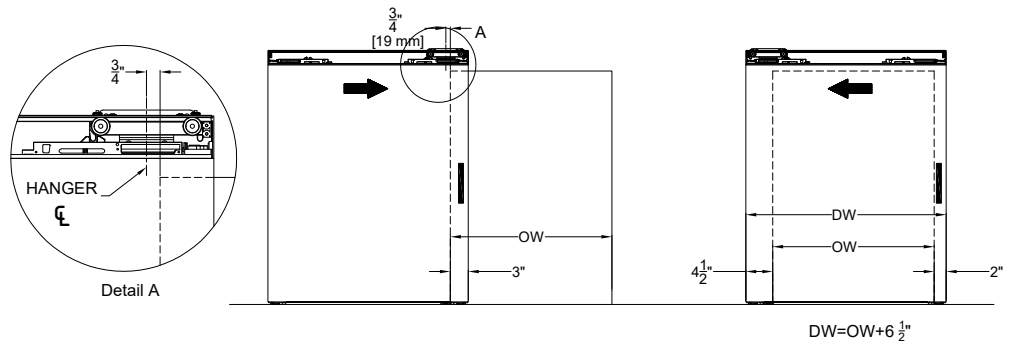
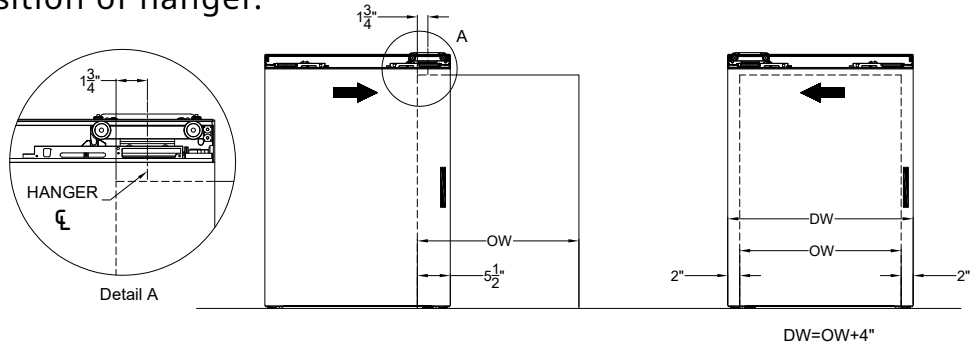

PEM/KO
ASSA ABLOY

Experience a safer
and more open world

7c. Adjust hanger down.

Using allen wrench included in kit, turn vertical adjustment bolt clockwise to lowest position.

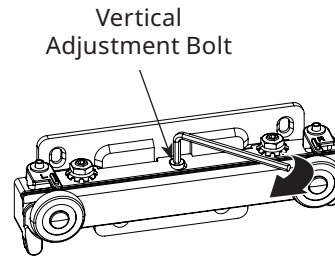

7d. Install hanger.

Using hanger as a template, hold against wall in correct position and mark four (4) holes. Be sure to mark at top of all four (4) slotted holes as shown.

Drill Ø4mm (3/16") holes and install hanger with four (4) #8 x 2" flat head screws.

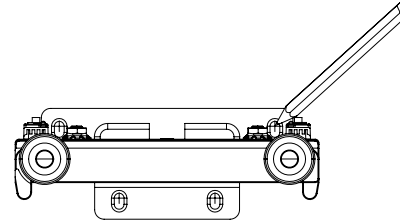

8. Install bottom guide.

Determine position of bottom guide:

Using a plumb line, align horizontal center of bottom guide with center of hanger.

Determine distance from center of bottom guide to wall:

NOTE: Distance is determined by depth of route at top of door.

Using bottom guide as a template, mark floor for two (2) holes.

Drill Ø4mm (3/16") holes and install guide using two (2) #8 x 1-1/8" flat head screws and plastic anchors.

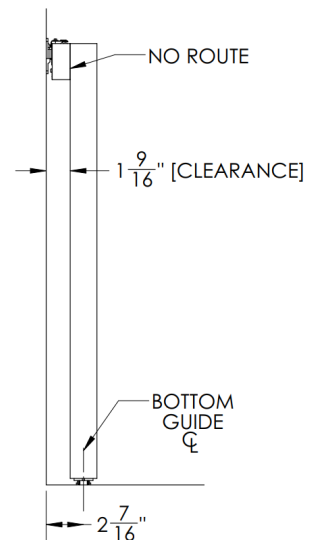
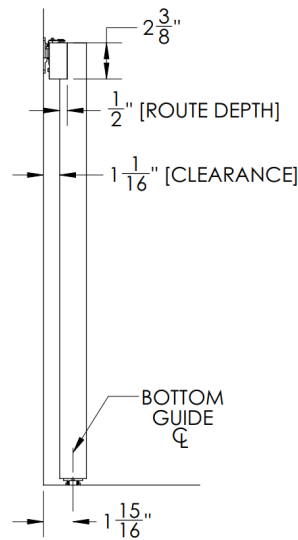
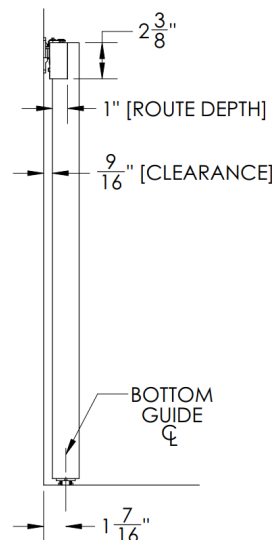
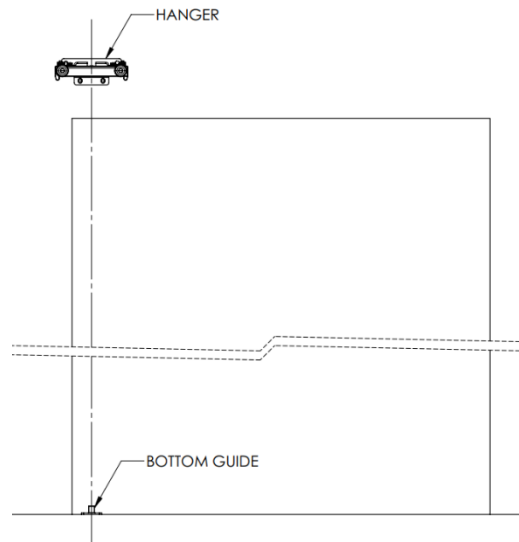

9. Hang door.

Ensure top hanger anti-rise devices are turned to be disengaged before hanging door.

Set door onto bottom guide so that guide is sliding in bottom door insert smoothly.

Tilt door toward wall until top hanger wheels are inside of track then allow weight to be held by bottom hardware.

CAUTION: There is a door tipping hazard until steps are completed to hold door vertical.

Turn hanger anti-rise devices until engaged.

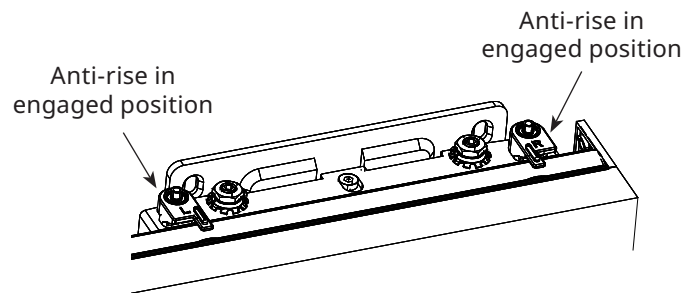
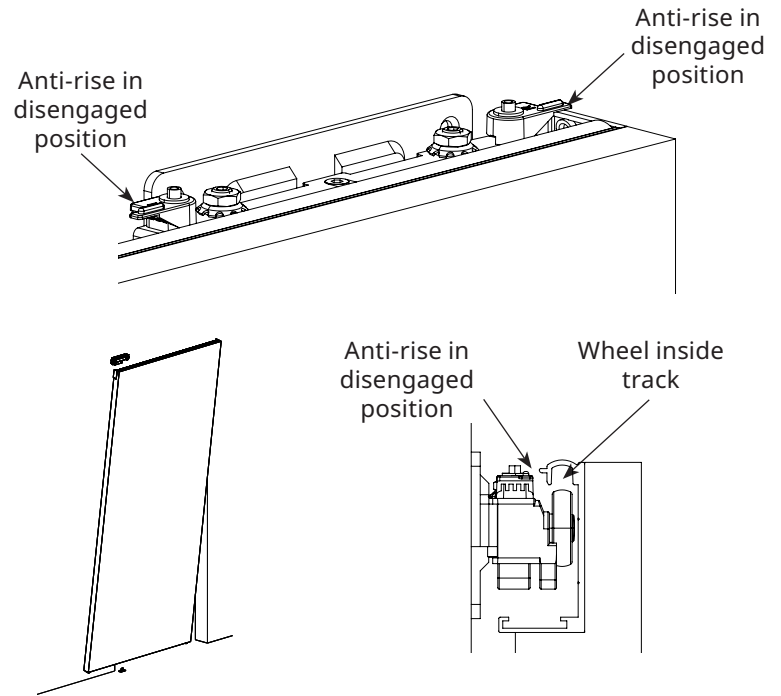

10a. Adjust hanger up.

Turn hanger vertical adjustment bolt counter clockwise to lift system until hanger wheels make good contact with track as shown. Adjust hanger up until push force is acceptable to keep door in motion.

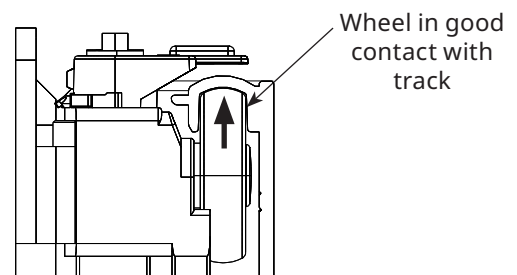
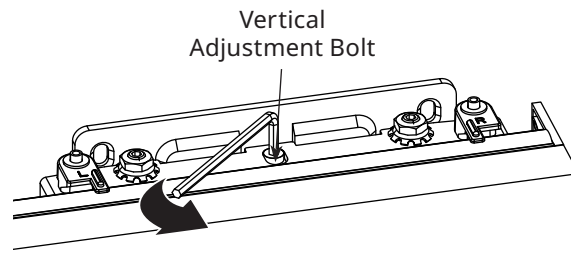

The ASSA ABLOY Group is the global leader in access solutions. Every day we help people feel safe, secure and experience a more open world.

10b. Adjust hanger tilt.

If gaps at trailing edge and leading edge of door are not consistent, adjust tilt by turning set screws clockwise until door is level.

After set screw has been adjusted, leave provided allen wrench in set screw and tighten nut with provided wrench as shown.

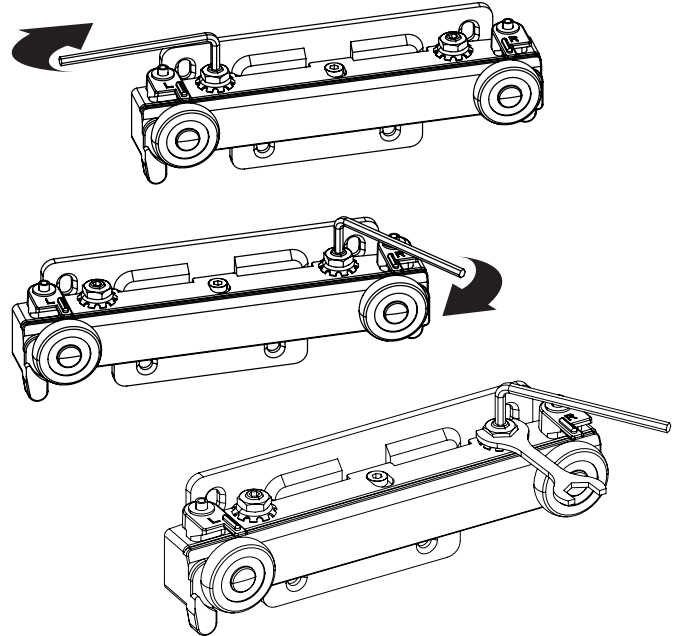

10c. Adjust door clearance.

If clearance between wall and door needs adjustment, move hanger in or out as shown.

Note: Adjustment nuts control both tilt and clearance.

After set screw has been adjusted, leave provided allen wrench in set screw and tighten nut with provided wrench as shown.

