

1. Install Lock Body

2. Install Drive Bar Cylinder

3. Tighten Drive Bar Cylinder

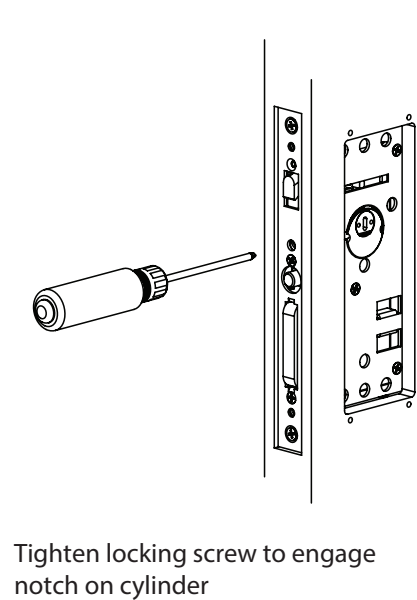
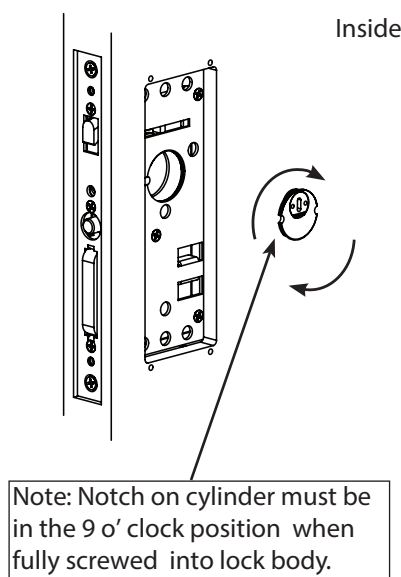
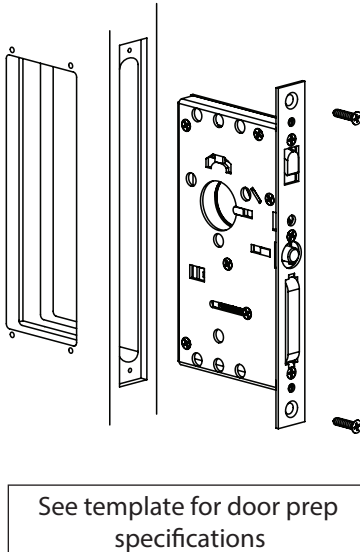

4. Mount Inside/Outside Plates

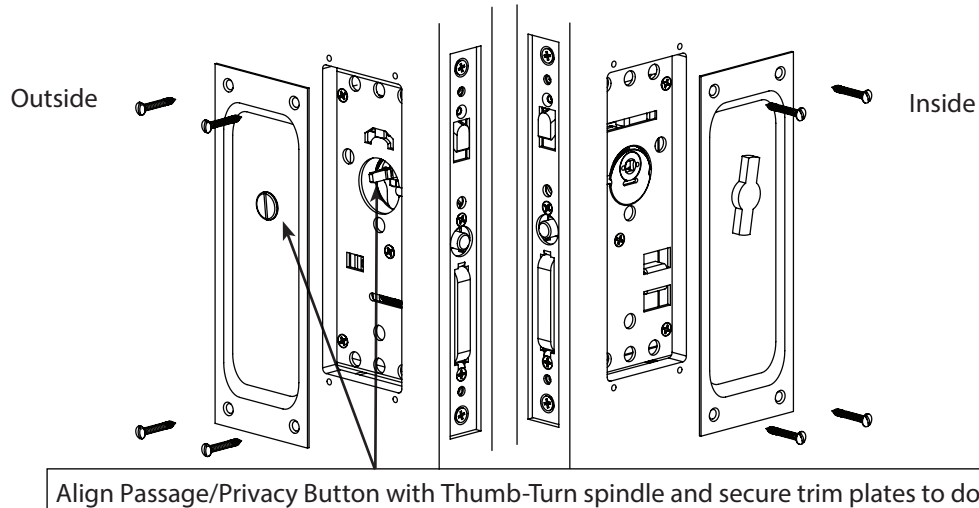

5. Install Trim Plate

6. Install Door Jamb

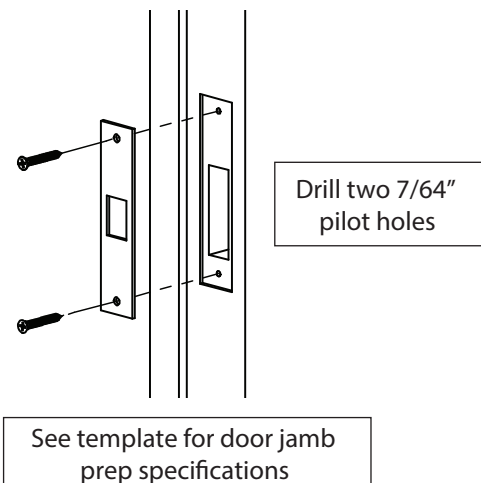
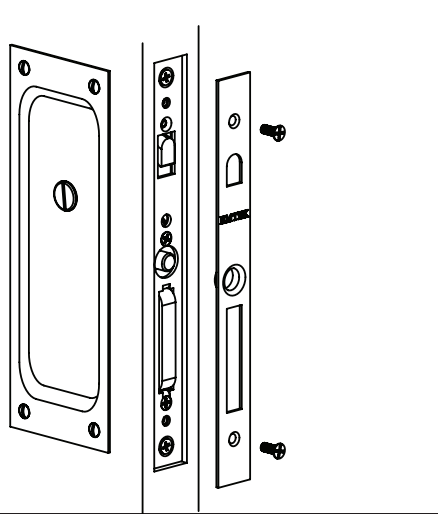

# Installation Guide - Privacy Pocket Door Mortise Lock, Modern Trim

## 1. Install Lock Body

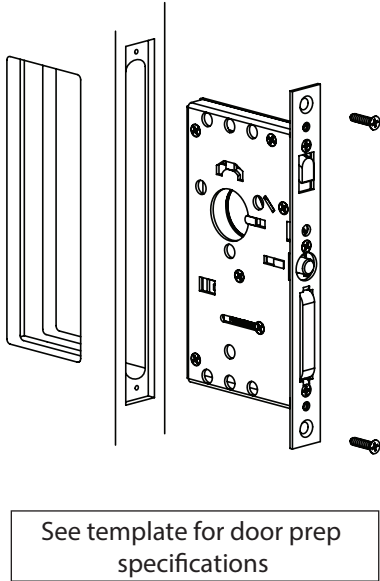

## 2. Install Drive Bar Cylinder

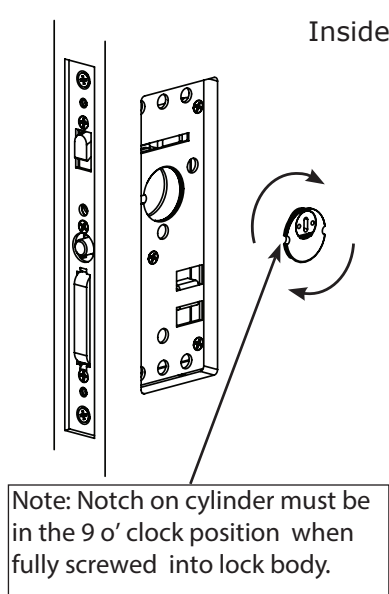

## 3. Tighten Drive Bar Cylinder

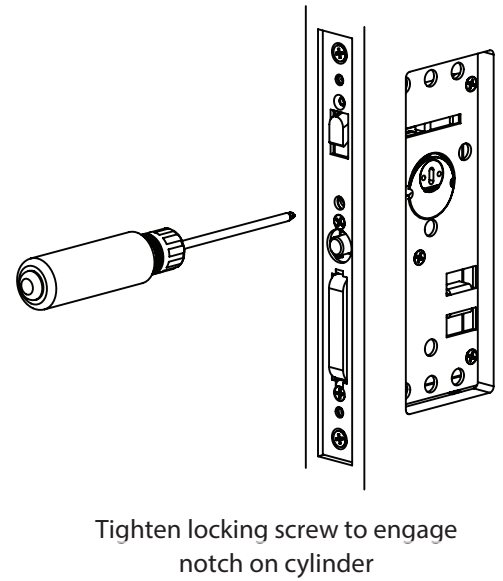

## 4. Mount Inside/Outside Plates

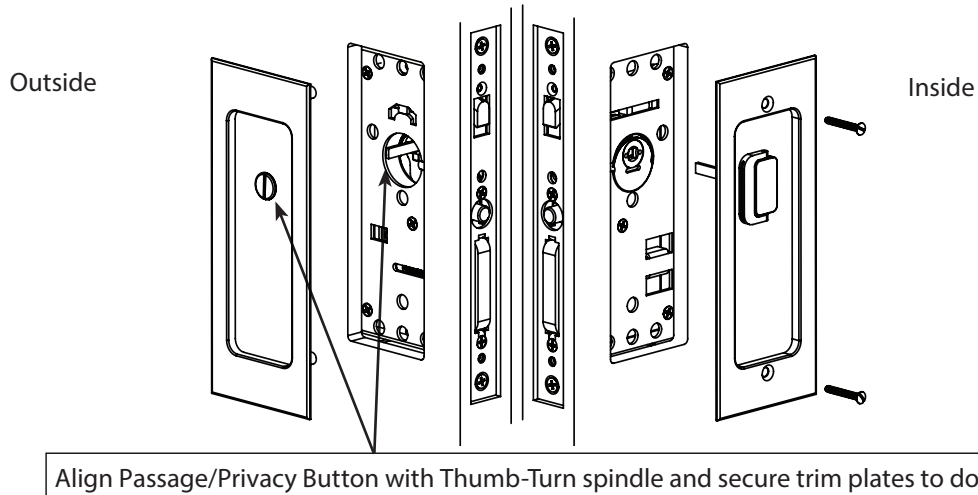

## 5. Install Trim Plate

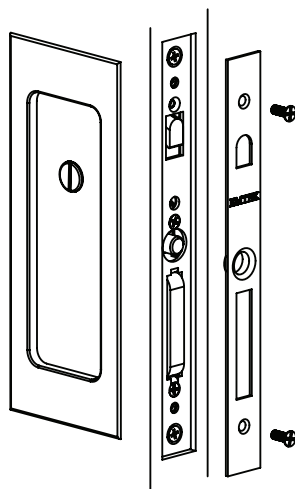

## 6. Install Door Jamb

