

INSTALLATION INSTRUCTIONS

REMOTE CONTROL FOR SPLASHDOWN FIXTURE AND 300W ECLIPSE FIXTURE

ITEM # F-LUHB/WD/RC

For use with Topaz model #'s: F-LUHB/150/50K/WD/MS, F-LUHB/200/50K/WD/MS and F-LUHB/300W/50K

ON/OFF

Press the "ON/OFF" button, light will remain on or off.
*Press "Auto Mode", "Reset" or "Scene mode" buttons to quit from this mode.



Detection area

Press the button "detection range" to set detection range as 100% / 75% / 50% / 25%.



Hold-time

Press the button "hold-time" to set hold-time as 5s / 30s / 1min / 3min / 5min / 10min / 20min / 30min.



Stand-by dimming level

Press the button "stand-by dimming level" to set the stand-by dimming level as 10% / 20% / 30% / 50%.



Stand-by period

Press the button "stand-by period" to set stand-by period as 0s / 10s / 30s / 1min / 5min / 10min / 30min / +∞.

Note: "0s" means no standby period; "+∞" means unlimited standby period.



Daylight threshold

Press the button "daylight sensor" to set daylight threshold as 2Lux / 10Lux / 30Lux / 50Lux / 80Lux / 120Lux / disable.

Note: setting to "disable" means light will be turned on once sensor detects movement, regardless of the ambient lux.

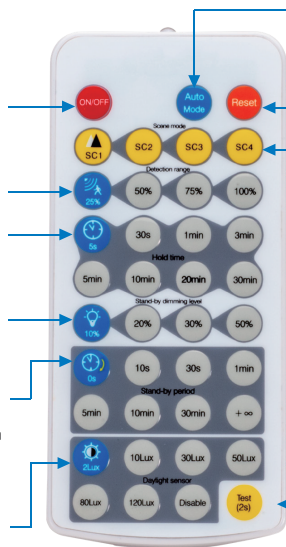

Auto Mode

Press "Auto Mode" button, the sensor starts to work and all settings remain the same before the light gets switched on/off.

Reset

Press "RESET" button, products with DIP switch will be controlled by DIP switches; otherwise all the setting will be just initial, that is 100% detection range, hold time 5S, no stand-by time and daylight threshold disabled.

Scene Mode

Scene mode	Detection area	Hold-time	Daylight threshold	Stand-by period	Stand-by dimming level
SC1	100%	30s	2Lux	1min	10%
SC2	100%	5min	10Lux	10min	10%
SC3	100%	10min	50Lux	30min	10%
SC4	100%	30min	Disable	+∞	10%

The button "Test (2s)" is for testing purpose after commissioning. When pressing this button, the sensor goes to test mode (hold time is only 2s) automatically, stand-by period and daylight sensor are disabled. This mode can be ended by pressing "reset", "Auto mode", "scene mode" or "hold time". The sensor setting is changed accordingly.

Attention

1. When using ON/OFF button, this will override any other settings.
2. Press "Auto Mode", "Scene Mode" or "Reset" buttons before setting functions Detection Range, Hold time, Daylight sensor, Standby period and Standby dimming level.
3. Press "Scene Mode" and choose one from the existing four scenes.
4. When using the remote control, light will flicker to show instruction received.
5. Every change will be automatically saved.

UFO HIGH BAY LED FIXTURE - ECLIPSE SERIES

INSTALLATION INSTRUCTIONS

Items:

F-LUHB/300W/50K

Warning

- Input voltage range is 120-277VAC, 50/60 Hz
- If input voltage exceeds this range, it may cause failure or damage to the fixture.
- Be sure to operate under correct input voltage
- Ambient operating temperature range: (-)40° to 113°F, using high bay fixture outside of this range will reduce the lifespan of the luminaire
- Installation must be carried out by a qualified electrician, in accordance with NEC and all local electrical codes
- Be sure to turn off power at the breaker or fuse before starting installation
- High bay applications require the use of a safety cable to secure fixture

Attention

Keep fixture away from corrosive substances, when cleaning, wipe with damp or dry cloth

Input Voltage	Frequency	Power	Input Current
120-277VAC	50/60Hz	300W	3.3A

1.Lock the hook.

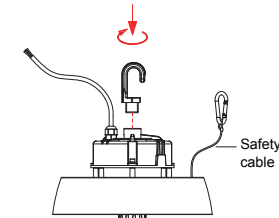

2.Tighten the screw.
(This step can be omitted if there is no screw hole.)

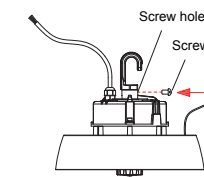

3.Hang up the light.

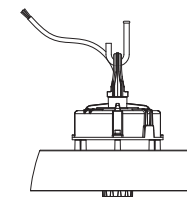

4.Use screw to lock in place

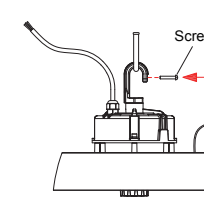

UFO HIGH BAY LED FIXTURE - ECLIPSE SERIES INSTALLATION INSTRUCTIONS

Items:
F-LUHB/300W/50K

Wiring Connection:

Turn off power at breaker, connect AC wire. black wire to L, white wire to N, and green wire to Ground.
Note: When using on 208 or 240 Volt circuit, white and black wires are used as hot leads

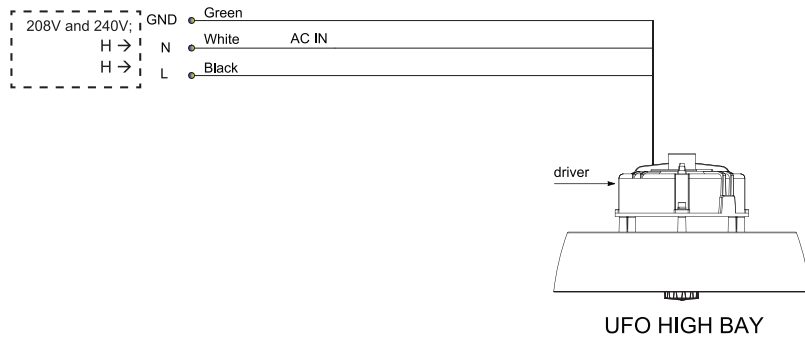

Product Dimensions

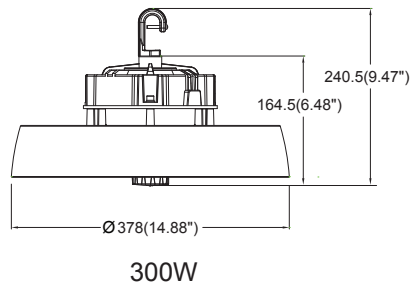

INSTALLATION INSTRUCTIONS RECEPTACLE TWIST-IN MOTION SENSOR FOR 300W ECLIPSE FIXTURE

ITEM # F-LUHB/MS/ES-87

Installation instruction for receptacle twist-in sensor

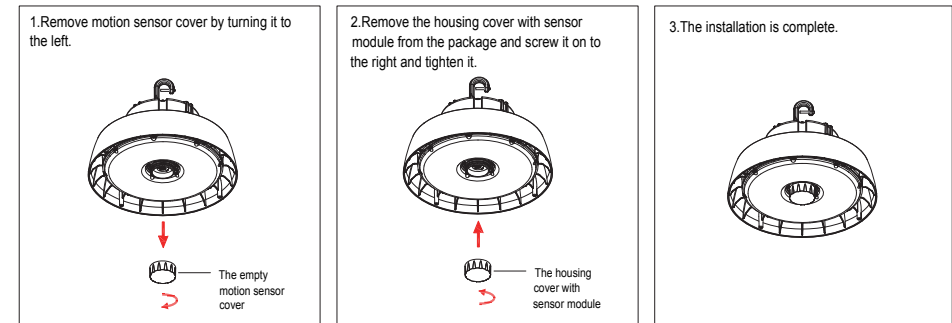

Note: The factory setting of the sensor is Detection area-100% Hold Time-1 min Stand-by dimming level- 10% Stand-by period- 10S Daylight threshold - disable.
If you need to change the setting, please use Topaz' remote control, Model#F-LUHB/WD/RC (please refer to the instruction for F-LUHB/WD/RC on page 4)

Detection Patterns

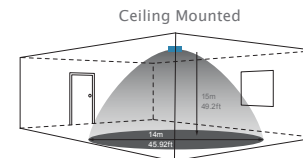

Dimensions

Unit:mm

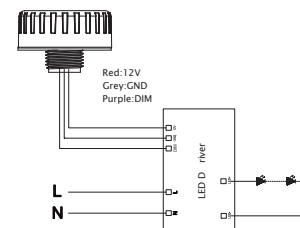

Technical data

Operating voltage	10-15VDC
Operating current	30mA±5%
Output	DIM 1-10V
Stand-by power	<0.5W
Detection area	25%/50%/75%/100%
Hold time	5s/30s/1min/3min/5min/10min/20min/30min
Daylight threshold	2Lux/10Lux/30Lux/50Lux/80Lux/120Lux/Disable
Stand-by period	0s/10s/30s/1min/5min/10min/30min/+∞
Stand-by dimming level	10%/20%/30%/50%
Microwave frequency	5.8GHz±75MHz
Microwave power	<0.3mW
Mounting height	Max.15m/49.2ft
Detection range	Max.14m/45.92ft
Operating temperature	-20°C~+60°C
IP rating	IP65

Wiring diagram

