

LED Green Exit - Battery Backup



Single or Double Face in One Unit

Energy efficient, low profile LED exit unit provides a clean & compact look. Emergency unit is OSHA compliant and contains a long lasting Ni-Cad battery backup for essential illumination during a power outage.

FEATURES

- 120/277V dual voltage operation
- Green EXIT letters - 6" height and 3/4" stroke
- High-impact, 5VA flame retardant thermoplastic ABS housing
- Ceiling, wall, or side mounting capability (canopy included)
- Test switch and AC supply indicator
- Removeable knockout chevron directional arrows
- Battery backup with accessible test button for 90 minutes of illumination during a power outage
- Suitable for damp locations
- Meets NFPA 70, NFPA 101, UL924, NEC and OSHA standards

APPLICATIONS

- Emergency lighting for office, industrial, retail and other public spaces





Job Name/Title: _____ Catalog Number _____
Contractor: _____ Notes: _____

LED Green Exit - Battery Backup

GENERAL SPECIFICATIONS

Input Voltage: 120/277V (dual voltage)
Frequency: 50/60 Hz
CRI: N/A
Dimmability: No
Avg. Rated Life: 500 uses
Wet / Damp / Dry Location: Damp
Construction: Thermoplastic
Recharge time: 24 hrs
Runtime: >/= 90 minutes
Unit Weight: 2.2 lbs
Battery Backup: Ni-Cad 2.4V 300mA
Ambient Operating Temperature: 50°F to 104°F
Energy Used in Maintenance Mode: 2.5W

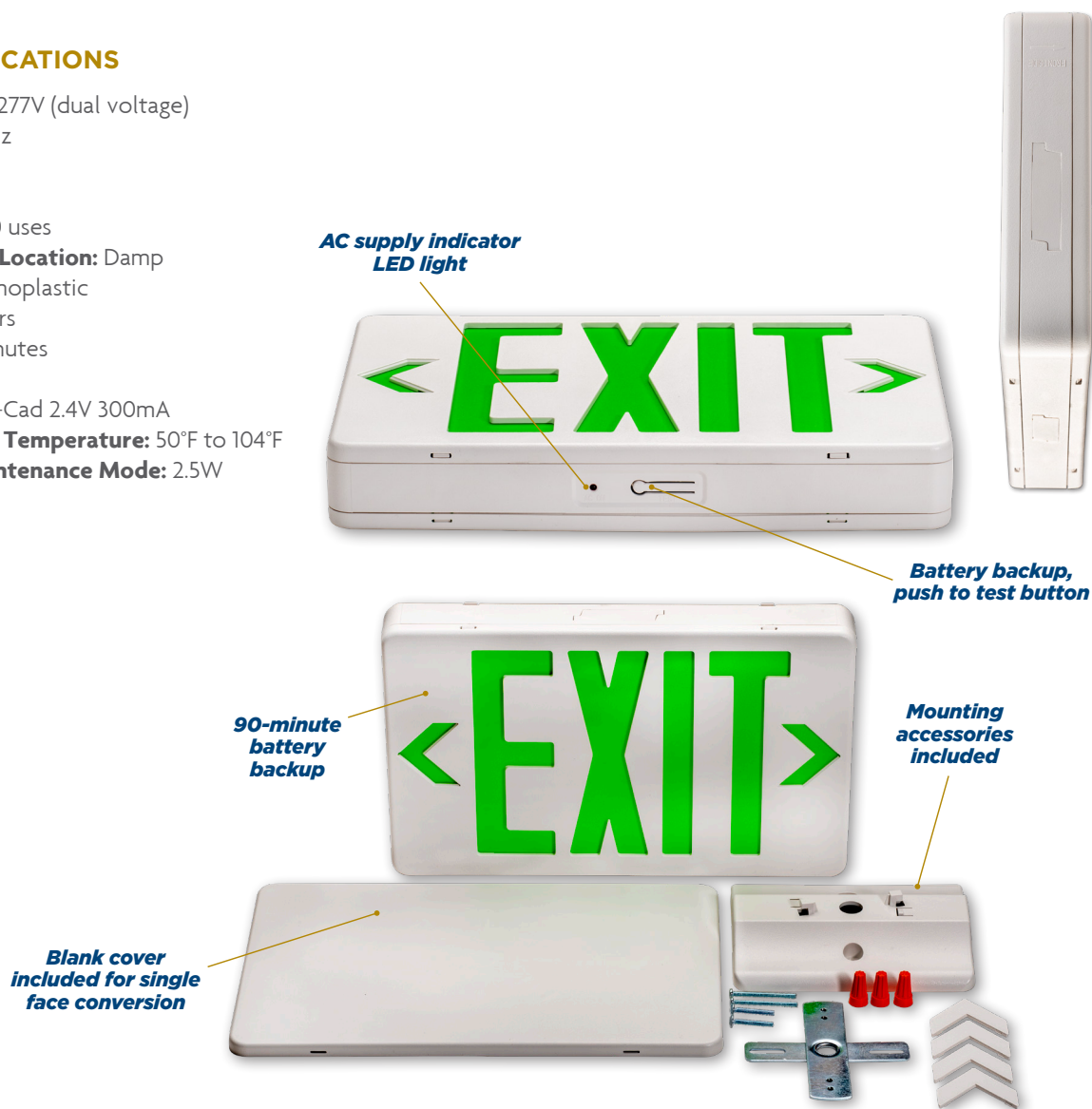

SPECIFICATIONS / ORDER INFO

Catalog Number	Order Code	UPC	Mounting	Dimensions	Pk-Qty
ES/LED/GW/B	75121	751338034655	Wall, side or ceiling	11.8" x 1.8" x 7.3"	12-PK

NOMENCLATURE

Example: ES/LED/GW/B

ES=Exit Sign / LED=LED / GW=Green Letters, White Housing / B=Battery Backup

©2019 Topaz Lighting Corp.

This device complies with Part 15 of the FCC Rules. Operation is subject to the following two conditions: (1) this device may not cause harmful interference, and (2) this device must accept any interference received, including interference that may cause undesired operation. Fixture may not be compatible with all dimmers. Visit www.topaz-usa.com for up-to-date dimmer compatibility information. Specifications subject to change without notice.