

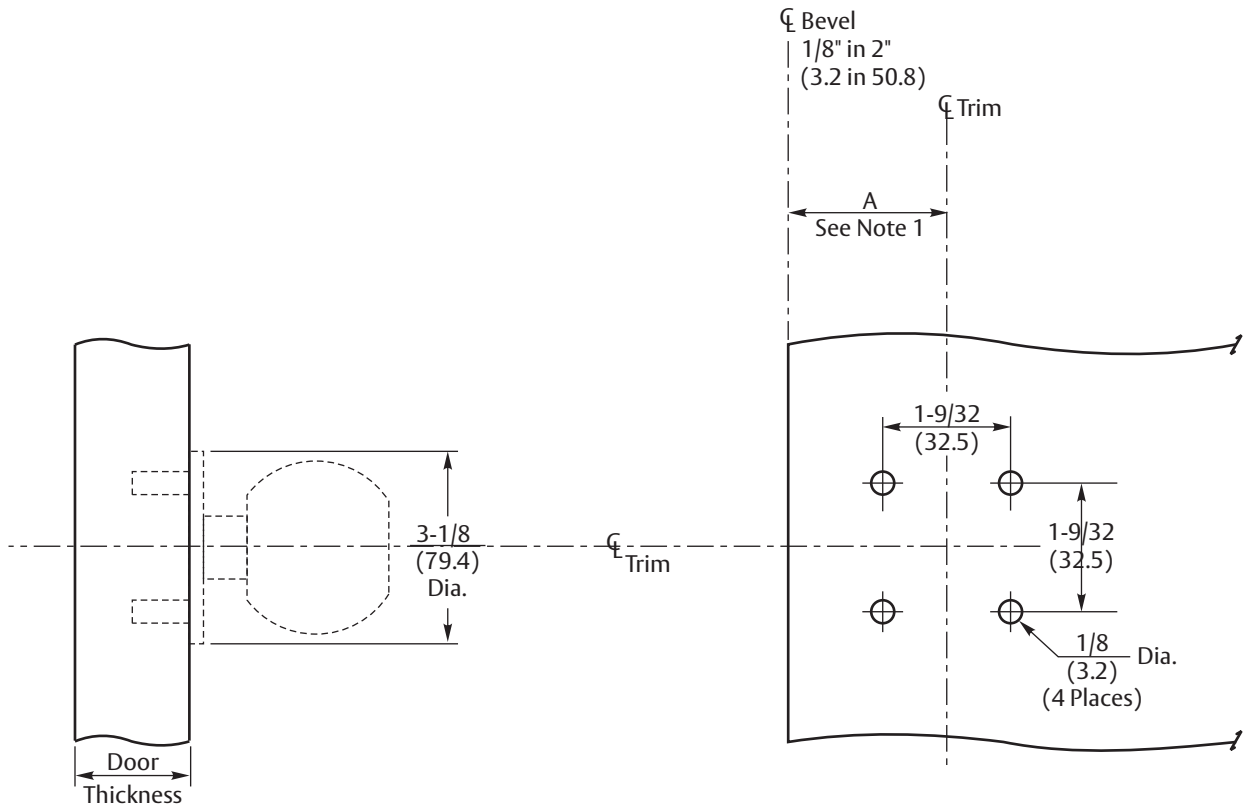

Notes:

- 1. Backset is measured from centerline of bevel which is centerpoint of door thickness.
- 2. Door prep with 2-3/4" (70) backset meets ANSI/BHMA A156.115 standards for steel doors and ANSI/BHMA A156.115W standards for wood doors.
- 3. Dimensions given in inches and (mm).



Backset Dim. "A"	
2-3/4 (69.9)	Regular
2-3/8 (60.3)	Optional

5400CK Series  
Grade 1 Knob Locks  
Dummy Trim

Wood or Metal Door Preparation (See ANSI/BHMA A156.115)



1-800-438-1951  
www.yalelocks.com

TEMPLATE NUMBER

7150-0118

DATE

03-16