

Dummy Trim Knob Lock Installation Instructions

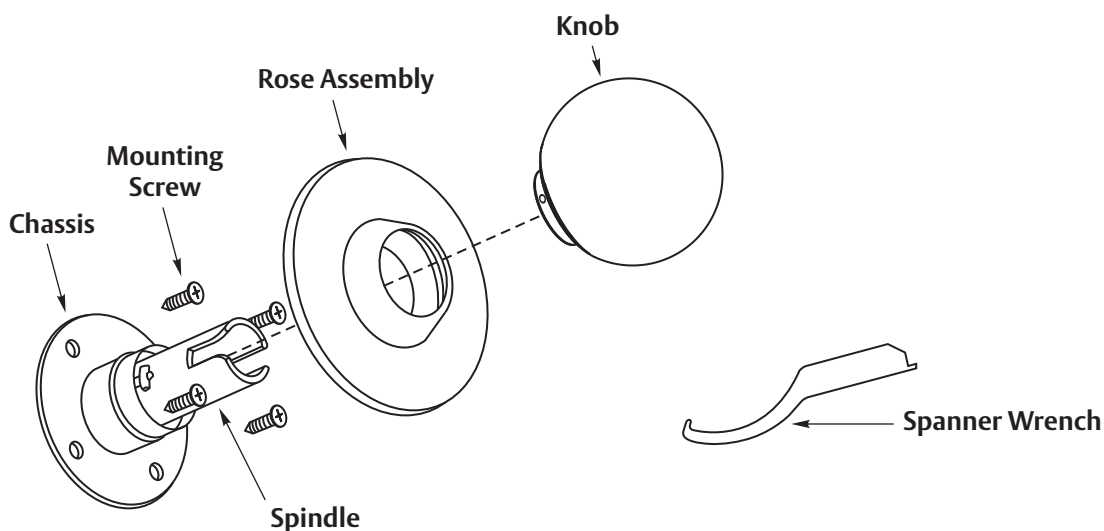

1. Place chassis at proper position on the door (knob retainer facing edge of door) and secure with mounting screws.
2. Rotate rose as desired and tighten securely by using the spanner wrench.
3. Slide knob onto spindle. With knob retainer hole in knob facing edge of door, push until retainer snaps into place.

