

STEP 1

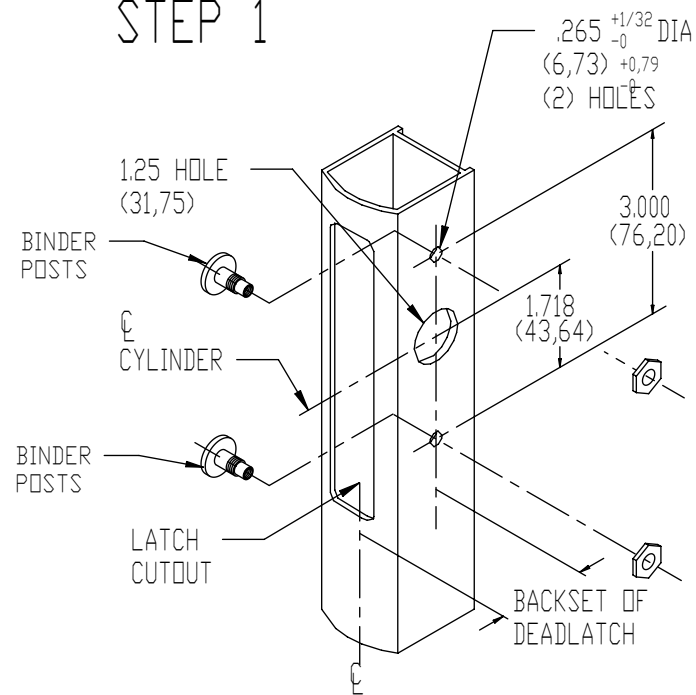

1. PREPARE STILE AS SHOWN.
2. INSERT BINDER POST THRU .265 DIA. HOLE IN STILE.
3. SECURE BINDER POST WITH 1/4-28 NUT.
(CAUTION: DO NOT OVERTIGHTEN NUT)

STEP 2

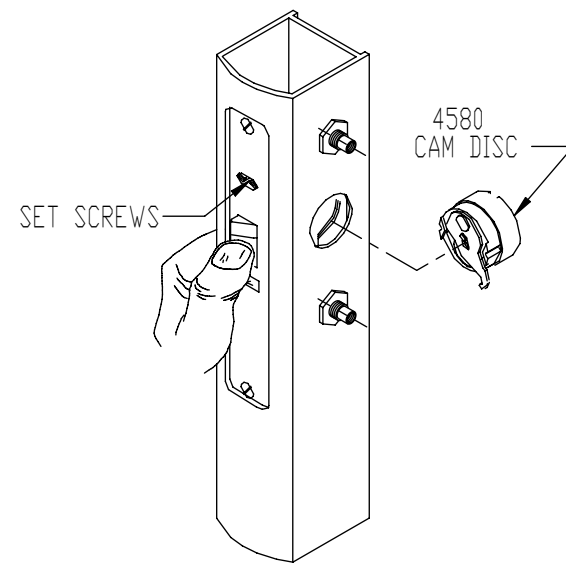

1. INSTALL 4500, 4700 AND 4900 SERIES DEADLATCH PER MOUNTING INSTRUCTIONS.
2. INSTALL 4580 CAM DISC ASSY. SECURE WITH SETSCREW.

INSTALLATION

STEP 3

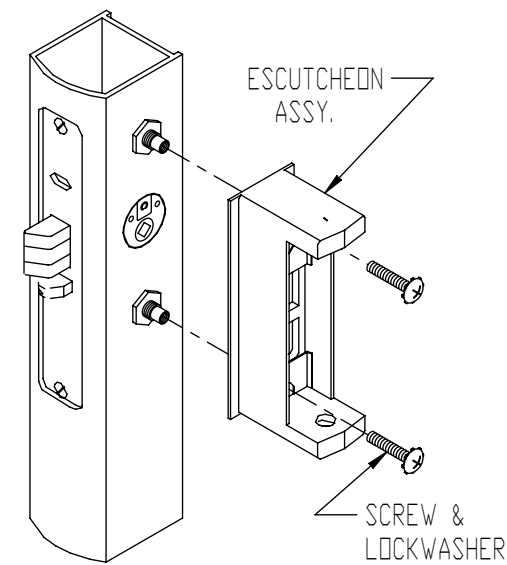

1. INSTALL ESCUTCHEON ASSY.
2. USING 8-32 SCREWS W/LOCKWASHER, SECURE ESCUTCHEON ASSY. TO BINDER POST.
IMPORTANT,
TIGHTEN THESE SCREWS SECURELY.

STEP 4

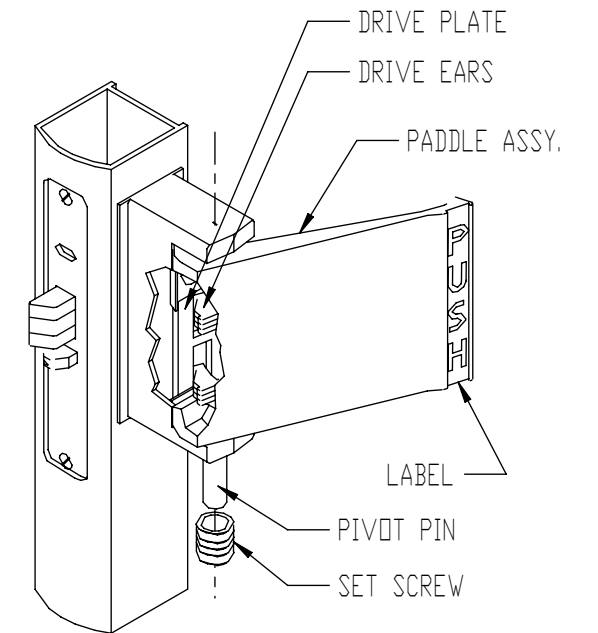

1. INSTALL PADDLE ASSY. ALIGN DRIVE EARS ON PADDLE WITH SLOT IN DRIVE PLATE.
2. INSTALL PIVOT PIN.
3. INSTALL PIVOT PIN SET SCREW. TIGHTEN SET SCREW FLUSH WITH BOTTOM OF ESCUTCHEON.

INSTRUCTIONS FOR CHANGING HAND SEE REVERSE FOR CAM DISC ASSY.

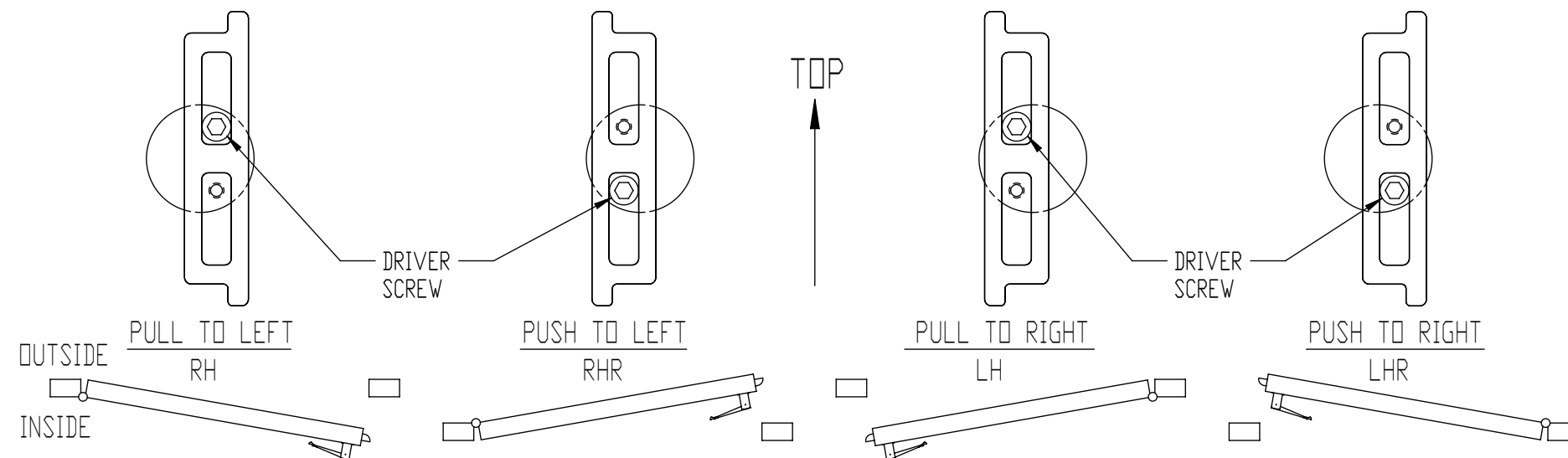

1. FIND DESIRED CONFIGURATION.
2. REMOVE KEEPERS TO SEE LOCATION OF SPRINGS & DRIVER PLATE.
3. REVERSE SPRINGS & DRIVER PLATE IF NECESSARY.
4. REMOVE DRIVER SCREW IF NECESSARY, AND PLACE IN DESIRED LOCATION.

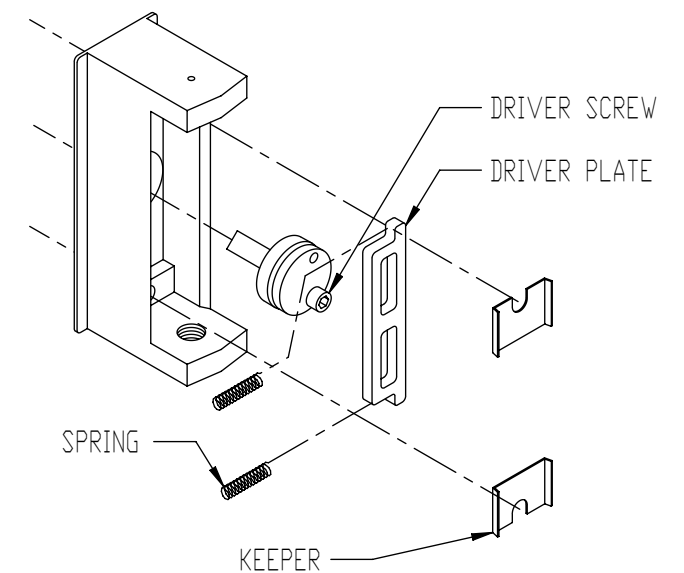

5. REPLACE KEEPERS.
6. CONFIGURE CAM DISC. (SEE REVERSE)