



**TRADEMARK
HARDWARE**

WORLD OF QUALITY HARDWARE

FALCON 2090 EXIT DEVICE

INSTALLATION

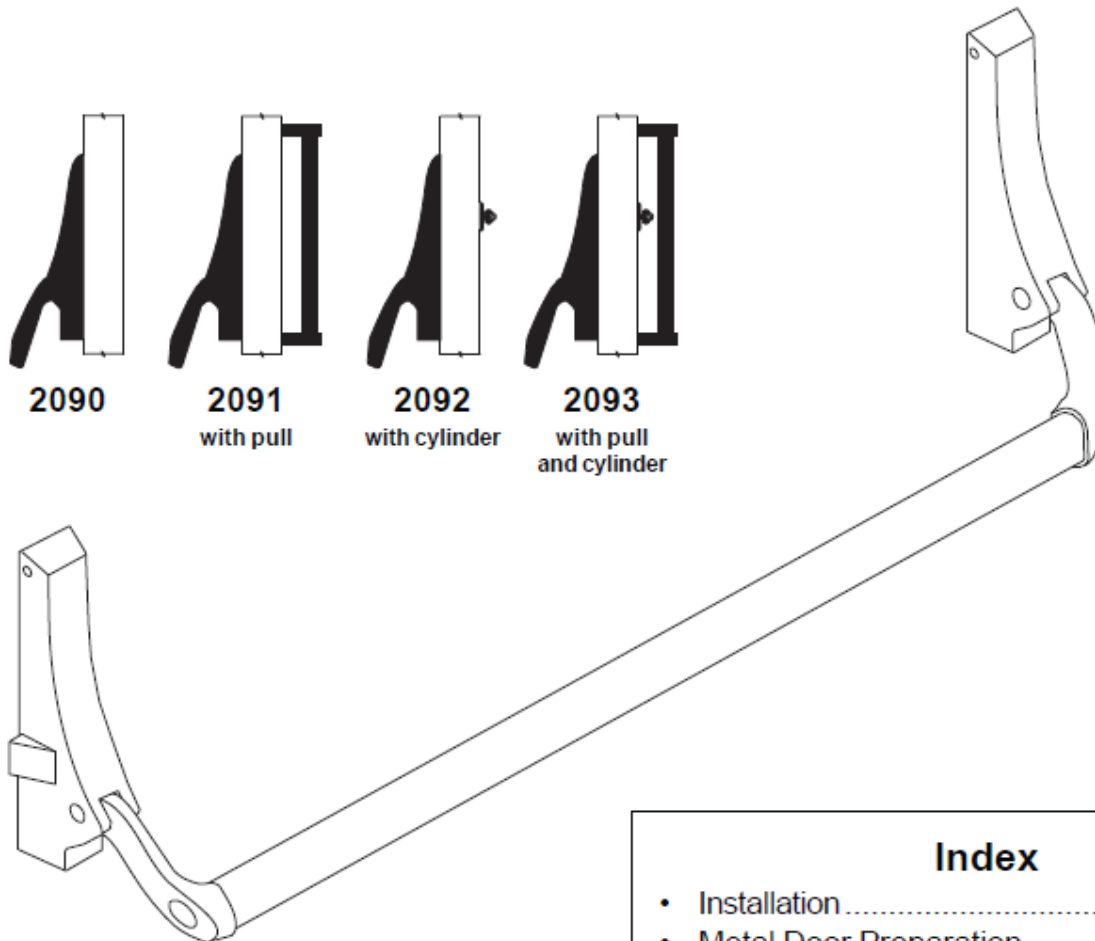

Index

- Installation 2
- Metal Door Preparation 3
- Wood Door Preparation 3
- Series 2090 Parts List 4

⚠ NOTES ⚠

1. Handing of device cannot be changed.
2. Crossbar length equals the distance between the housing vertical center lines minus 1-3/4".



www.tmhardware.com



845-388-1300



845-388-1388



sales@tmhardware.com



INSTALLATION

1. Check "Series 2090 Parts List" (see page 4).
2. Prepare door for device (see page 3).

NOTE

Dimensions on lock and lock screw holes will function with the following 5-pin tumbler rim cylinders: Corbin, Lockwood, Schlage, Welch, Yale.

For other brands, refer to lock maker's template.

3. **Aluminum and hollow metal doors:** Install housing mounting studs in door.

Wood door: Install assembly plates in door cutouts.

4. Install cylinder if used. If required, cut tailpiece (Figure 1). Cylinder screw heads must be flush with door surface.
5. If cylinder is used, set pinion cam on back of active housing for hold-back (HB) or night latch (NL) operation (Figure 2).

Hold-back (HB): Turning key one complete rotation retracts latch bolt. If key is removed in this position, latch bolt stays retracted. Returning key to original position before removing allows latch bolt to extend.

To set for hold-back: Turn pinion cam until latch bolt starts to retract, then turn pinion cam the other way as far as it will go. Leave pinion cam in this position.

Night latch (NL): Turning key as far as it will go retracts latch bolt. Key must be returned to original position to be removed, leaving the door locked.

To set for night latch: Turn pinion cam until latch bolt starts to retract. Leave pinion cam in this position.

6. Install active housing over mounting studs and tighten set screws (Figure 3).
7. Check lever arm operation to ensure that all parts move freely. If cylinder is used, check that the cylinder functions correctly for either hold-back or night latch.
8. Install crossbar and inactive housing (Figure 4). Tighten inactive housing set screws and fasten crossbar with Taptite screws (item No. 16 in "Series 2090 Parts List," page 4).
9. Prepare frame for strike and install strike (see bottom of page 4).

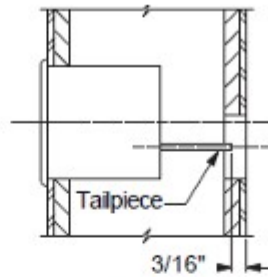

Figure 1

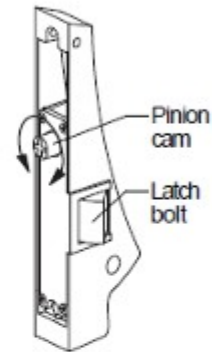

Figure 2



Figure 3

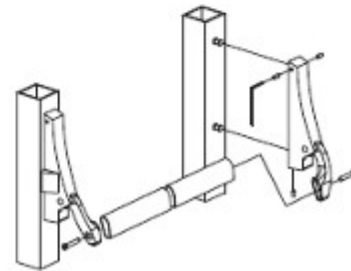

Figure 4



FALCON 2090 EXIT DEVICE



**TRADEMARK
HARDWARE**

WORLD OF QUALITY HARDWARE

INSTALLATION

METAL DOOR PREPARATION

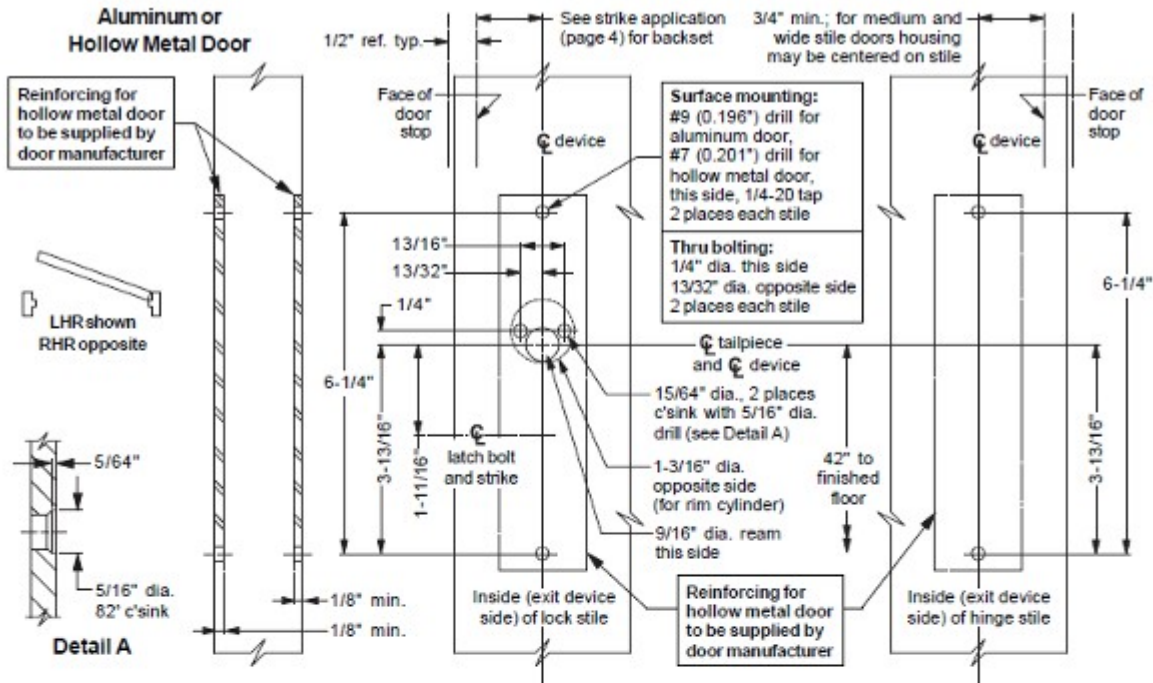

WOOD DOOR PREPARATION

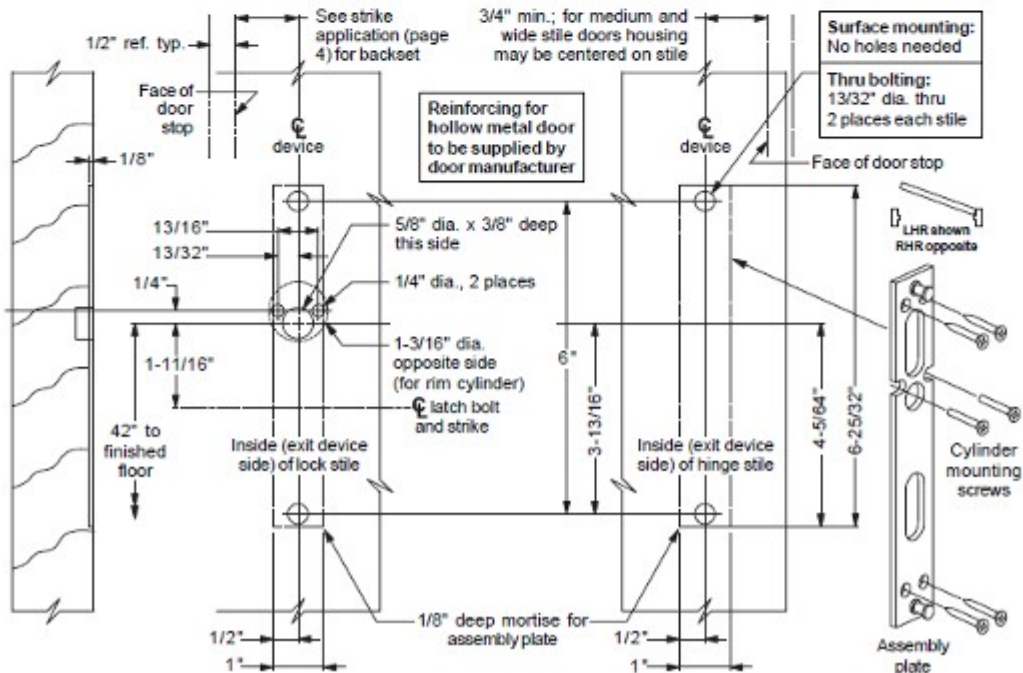

www.tmhardware.com



845-388-1300



845-388-1388



sales@tmhardware.com

FALCON 2090 EXIT DEVICE



**TRADEMARK
HARDWARE**

WORLD OF QUALITY HARDWARE

INSTALLATION

SERIES 2090 PARTS LIST

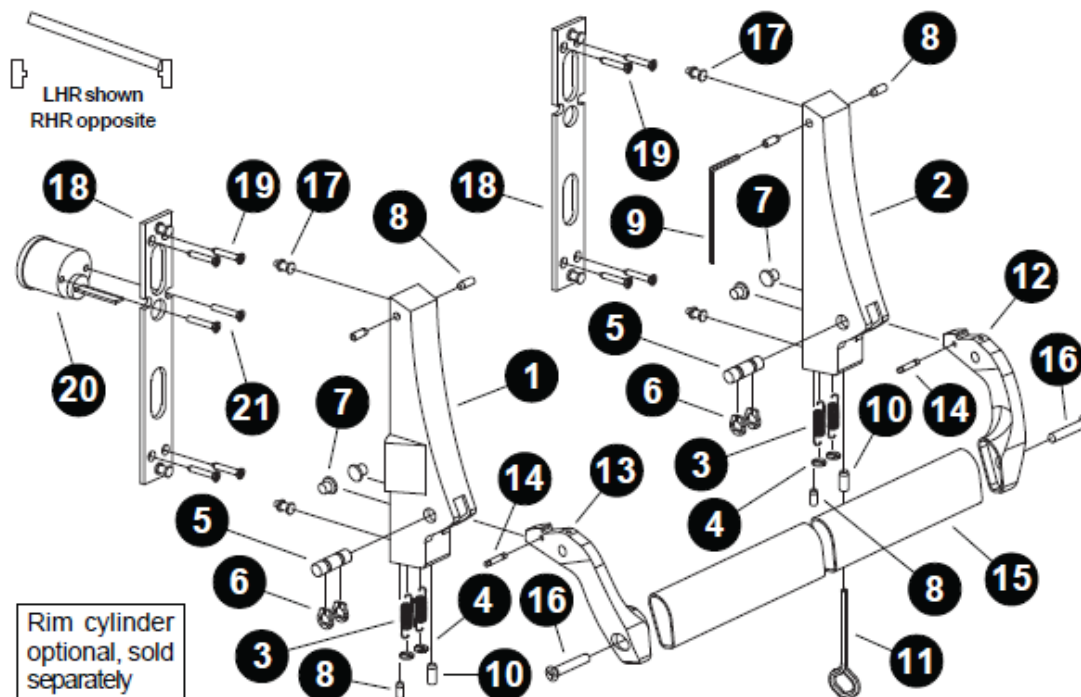

Item	Qty.	Description	Item	Qty.	Description	Item	Qty.	Description
1	1	Housing, active (RHR or LHR)	8	6	1/4-20 x 3/8" socket head set screw	15	1	Crossbar
2	1	Housing, inactive (RHR or LHR)	9	1	1/8" Allen wrench	16	2	1/4-20 x 1" Tapite
3	4	Tension spring	10	2	7/16-14 x 3/4" socket head set screw	17	4	Housing mounting stud (metal doors)
4	2	Spring retainer	11	1	Dogging key	18	2	Assembly plate (for wood doors)
5	2	Axle pin	12	1	Lever arm, LH	10	8	#10 x 1" FPHSMS (for wood doors)
6	4	Retaining ring	13	1	Lever arm, RH	20	1	Rim cylinder
7	4	Axle bushing	14	2	Spring pin	21	2	Rim cylinder screws

SD36 Strike (standard)

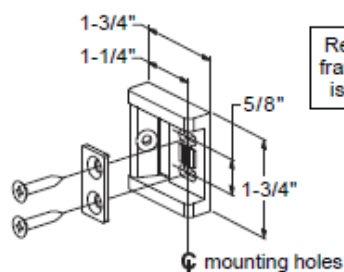

SD35 Strike (optional)

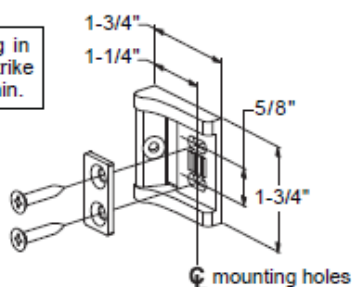

Double Doors with STK45 Strike

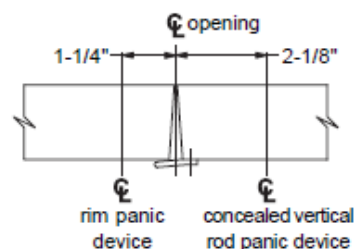

Surface Mounted Strike

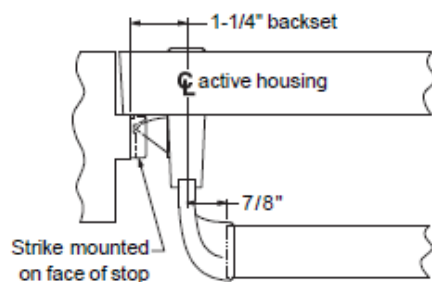

Mortised Strike

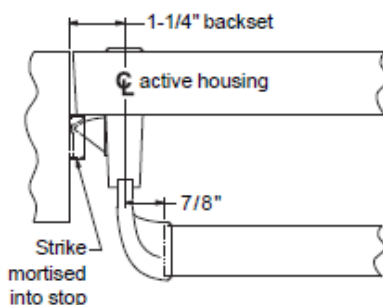

Double Doors with RM70 Mullion

