



Sliding door system for modern furniture design:
SlideLine M



TRADEMARK
HARDWARE
WWW.TMHARDWARE.COM

Your contact:

Hettich Marketing- und Vertriebs GmbH & Co. KG

Gerhard-Lüking-Str. 10

32602 Vlotho

Germany

P.O. Box 1743



32591 Vlotho

Phone: +49 5733 798 0

Fax: +49 5733 798 201

E-mail: info@de.hettich.com

Internet: www.hettich.com

| | SlideLine M, overlay | SlideLine M, inset |
|-------------------|---|--|
| |  |  |
| Page | 4 – 5 | 24 – 25 |
| Description | Bottom running sliding door system with one runner | Bottom running sliding door system with one or two runners |
| Number of runners | 1 | 2 |
| Door action | Horizontal | Horizontal |
| Door position | Overlay | Inset |
| Door weight | ► 30 kg max. | ► 30 kg max. |
| Door material | Wood Aluminium Glass | Wood Aluminium Glass |
| Door width mm | 300 – 1800 | 300 – 1800 |
| Door height mm | up to 2000 | up to 2000 |
| Silent System | Soft closing, soft opening, soft colliding | Soft closing, soft opening, soft colliding |

Everyone does it: Slide it. Love it.

People like to keep it simple. On their tablet PCs. On their smartphones. The revolutionary aesthetic appeal of virtual sliding fascinates millions: gentle, flowing movement, simply at the touch of a finger. But sliding in the real world's right on trend too. Truly practical cars have a sliding door; a sliding roof provides fresh air and a feeling of freedom, and at home we slide panel curtains and doors as room dividers or on furniture.

Are you open to new trends? Because if you are, new doors are about to open for you too. In this case they open to the side. Whether for the bedroom, living room or kitchen furniture – Hettich gives you innovative sliding door systems that go perfectly with your furniture.

Are you open to a new love? Welcome to Hettich.





Ergonomics

Benefits that come with sliding doors

Sliding doors show what they're made of in everyday use. In terms of ergonomics and convenience, most consumers think sliding doors are better. And for good reasons: open sliding doors don't get in the way where space is at a premium.

Open doors on wall units are not likely to leave you injured. Sliding doors are also easy to open without stretching or dodging out the way.

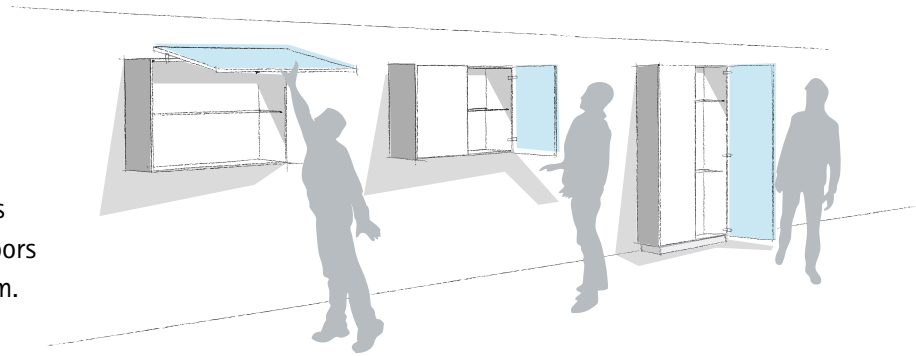

Design

Being creative with sliding doors

Sliding doors provide the key to picking up on modern, spacious interior design and continuing it in furniture. Large surface doors open the way to purist interior design.

Modern sliding door systems create a look that impresses with narrow reveals that can also be kept to a minimum with large surface fronts. Easy precision adjustment provides superb finished results with perfect gap alignment.

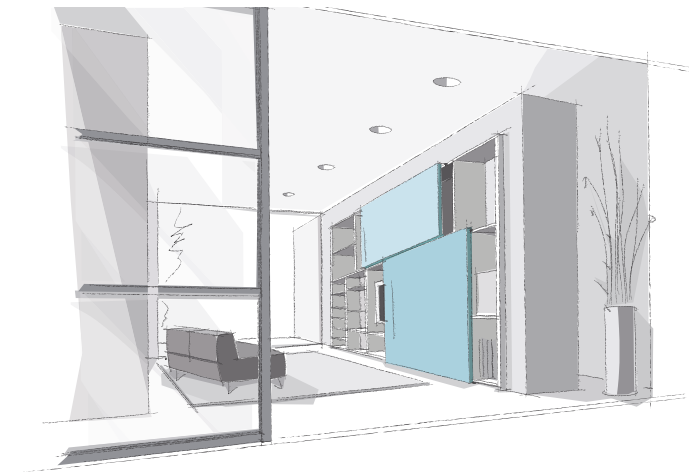

Functionality

What good cabinet doors need to do

When it comes to cabinet doors, it's the practical aspects most consumers attach importance to, particularly to ease of opening and closing. The benefit of linear movement provided with sliding doors should be combined with low forces needed to open them. Also appreciated is the convenience of Silent System for soft, gentle and silent closing.

The perfect sliding door system is also expected to come with outstanding running performance and give quality you can rely on.

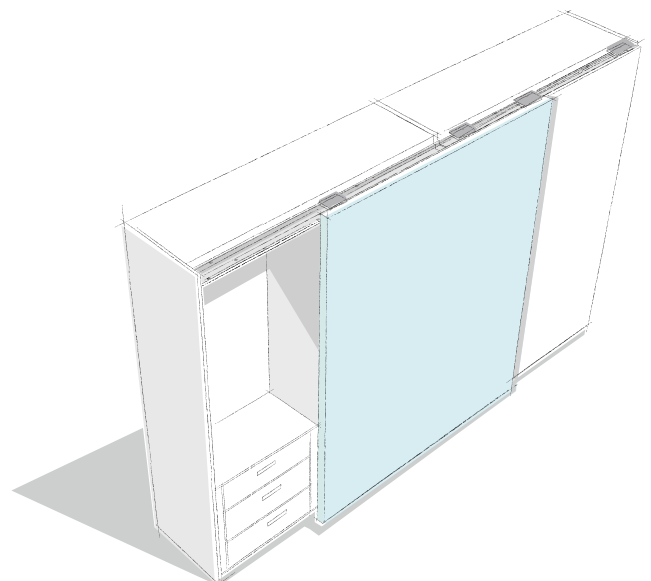

Sliding door system / bottom running

- ▶ SlideLine M / overlay door position
- ▶ All the benefits at a glance



**TRADEMARK
HARDWARE**
WWW.TMHARDWARE.COM



Design upgrade for furniture. SlideLine M upgrades the practical value and design of furniture. Living room units and shelf systems. Kitchen wall units and bathroom furniture. And, of course, office cabinets too. The versatile system is suitable for all common furniture constructions. Wooden, glass or aluminium framed doors weighing up to 30 kg can be installed quickly and easily. Profiles are available for several shelf thicknesses. Sliding doors running one

in front of the other in one profile are also easy to produce. The Silent System is integrated on the running component and slows down door running action in closing, opening and colliding direction.



Including a feel of luxury: Silent System lets doors open and close quietly and gently. Where several sliding doors run side by side in one profile, they can even be slowed down as they move towards each other.



Tool-less fast installation: the SlideLine M system makes easy, fast work of installing sliding doors.



Spot on: perfectly align sliding doors – with the integrated height adjuster (+/- 2 mm).



Fast and easy: profiles are simple screw mounted to the assembled carcass.

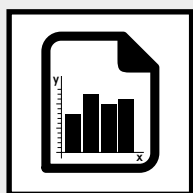

Performance summary

6 – 7

- ▶ Technical details in brief
- ▶ Door sizes
- ▶ Silent System
- ▶ Operating principle



System components

8 – 13

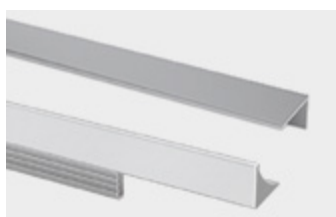

Accessories

31 – 32

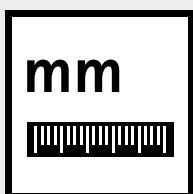

Planning dimensions

14 – 19



Installation

20 – 23



Accessories

38 – 52



Technical information

- ▶ Calculating door weights
- ▶ Design advice sliding door systems
- ▶ Quality criteria

38 – 39

40 – 42

43



For further information, go to <https://www.hettich.com/short/7acc07>

- ▶ Detailed installation instructions
- ▶ CAD data
- ▶ Assembly video

Technical details in brief

- ▶ 1-track, bottom running sliding door system
- ▶ Overlay door position
- ▶ Wooden, glass or aluminium framed doors
- ▶ Door weight up to 30 kg
- ▶ Door height up to 2000 mm
- ▶ Door width from 300 - 1800 mm
- ▶ Shelf thicknesses 15, 16, 18, 19, 22, 25 mm
- ▶ +/- 2 mm height adjustment
- ▶ Silent System in closing, opening and colliding direction
- ▶ Tool-less fast installation of the front panel
- ▶ Tested to EN 15706, Level 1 or 3

Door format and door weight

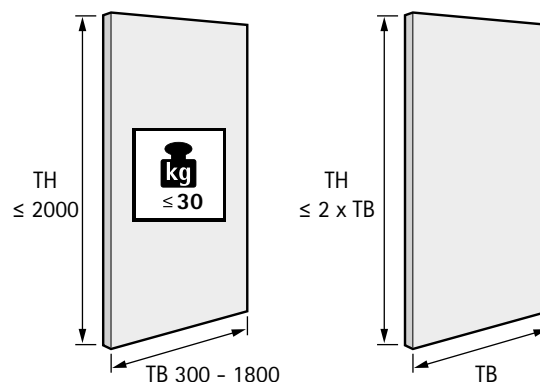

| | | | | | | | | | | |
|------|-----|-----|------|------|------|------|------|------|-----|------|
| TB | 300 | 400 | 500 | 600 | 700 | 800 | 900 | 1000 | ... | 1800 |
| TH ≤ | 600 | 800 | 1000 | 1200 | 1400 | 1600 | 1800 | 2000 | ... | 2000 |



see page 38 - 39

Door material

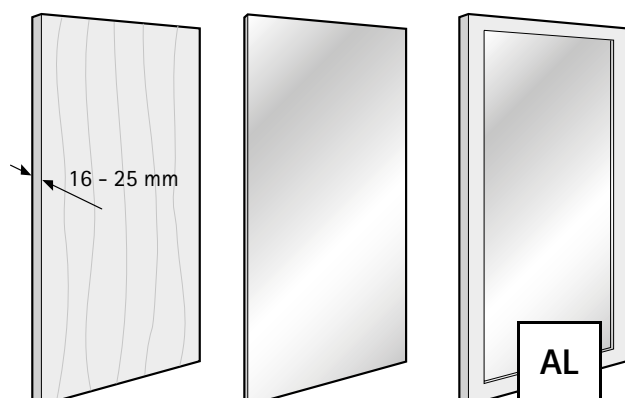

Number of door wings and door position

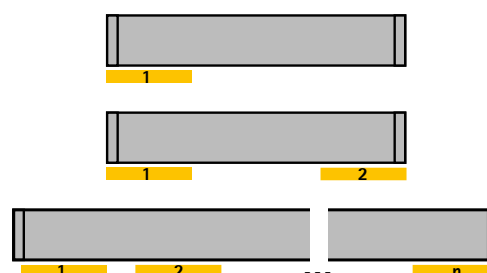

Silent System

| | 1-door | with several doors |
|----------------|--------|--------------------|
| Soft closing | | |
| Soft opening | | |
| Soft colliding | | |

- ▶ SlideLine M / overlay door position
- ▶ Performance summary



Operating principle / SlideLine M with Silent System

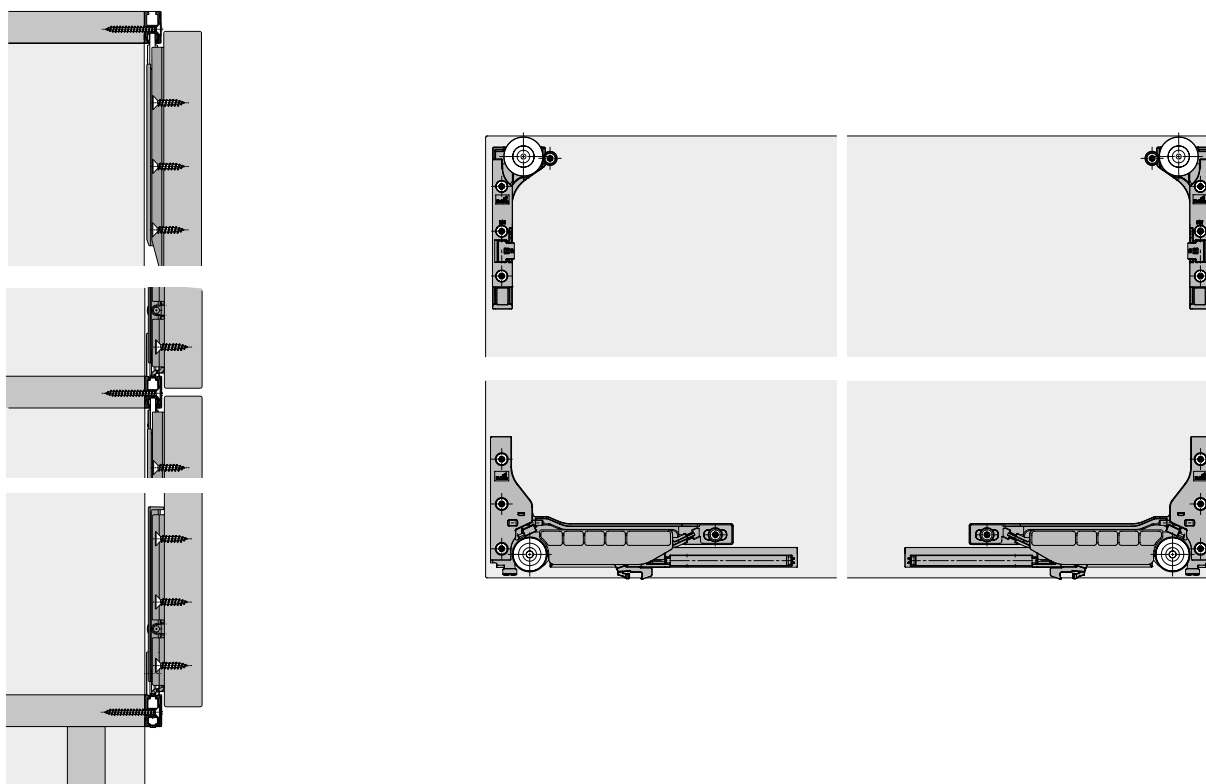

Operating principle / SlideLine M without Silent System

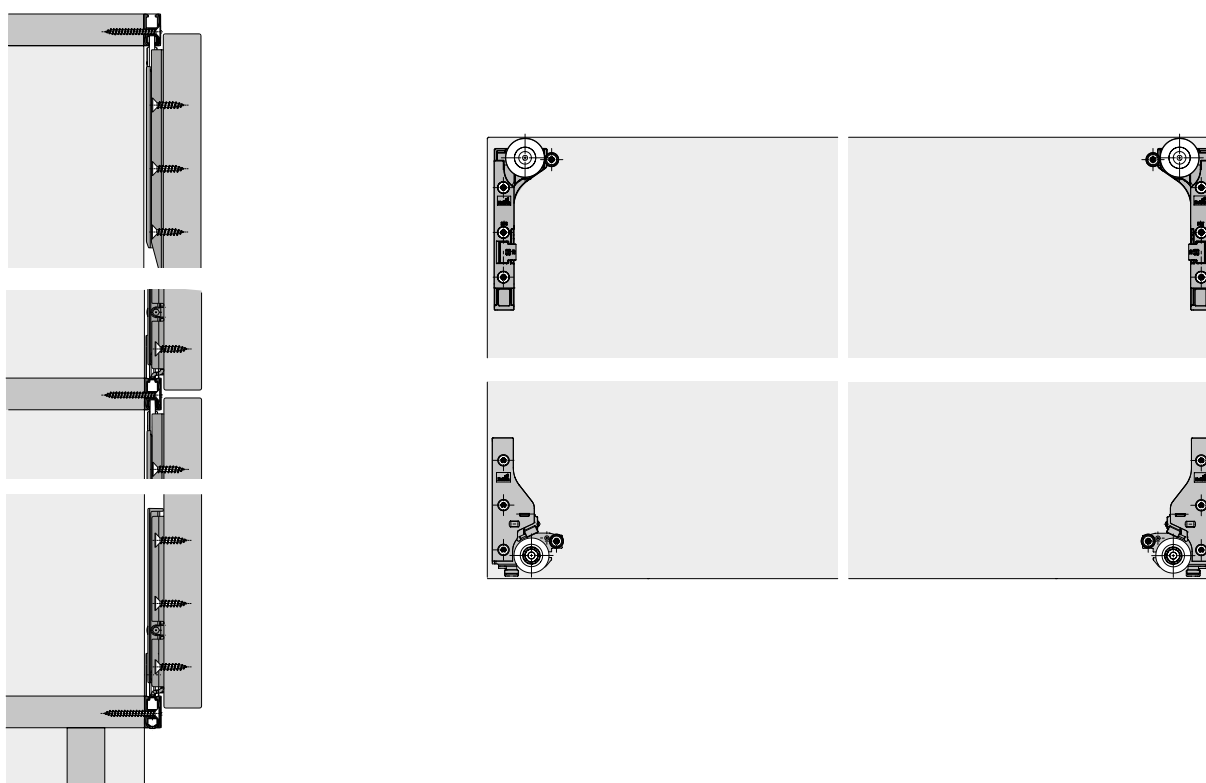

- ▶ SlideLine M / overlay door position
- ▶ System components

Set of fittings for doors with Silent System (soft closing, soft opening and soft colliding)



- ▶ Set contains all the components required for 1 sliding door framed in wooden or 55 mm aluminium profiles with Silent System
- ▶ The set of fittings can be used without an additional upgrade set
- ▶ Suitable sheet metal screws must be used for installing the running and guide components on the 55 mm aluminium frame

Set comprises:

- ▶ 2 running components with Silent System
- ▶ 2 guide components
- ▶ 2 activators
- ▶ 2 end stops, top
- ▶ 2 guide bushes
- ▶ 1 Silent System in colliding direction
- ▶ 1 1.5 mm hexagon socket spanner
- ▶ Fixing screws for wooden doors

Advice:

- ▶ Please order profiles separately

| Door weight per door (max) | Door type | Minimum door width in mm | Order no. | PU |
|----------------------------|---|--------------------------|------------------|-------|
| 10 | Wooden door, 55 mm aluminium framed door | 450 | 9 201 921 | 1 set |
| 30 | Wooden door, 55 mm aluminium framed door | 450 | 9 156 338 | 1 set |

Set of fittings for doors without Silent System



- ▶ Set contains all the components required for 1 sliding door framed in wooden or 55 mm aluminium profiles without Silent System
- ▶ The set of fittings can be used without an additional upgrade set
- ▶ Suitable sheet metal screws must be used for installing the running and guide components on the 55 mm aluminium frame

Set comprises:

- ▶ 2 running components without Silent System
- ▶ 2 guide components
- ▶ 2 end stops, bottom
- ▶ 2 end stops, top
- ▶ 4 guide bushes
- ▶ 1 1.5 mm hexagon socket spanner
- ▶ Fixing screws for wooden doors

Advice:

- ▶ Please order profiles separately

| Door type | Minimum door width in mm | Order no. | PU |
|--|--------------------------|------------------|-------|
| Wooden door, 55 mm aluminium framed doors | 300 | 9 156 339 | 1 set |



**TRADEMARK
HARDWARE**
WWW.TMHARDWARE.COM

Upgrade set for glue mounted glass doors with Silent System



- ▶ Set contains all the upgrade components required for glue mounting 1 glass sliding door without Silent System
- ▶ For use with 2-component adhesive
- ▶ Supplied without adhesive
- ▶ Mounting adapter material: zinc alloy to DIN EN 12844-ZP5

Set comprises:

- ▶ 2 adhesive mounting adapters for guide components
- ▶ 2 adhesive mounting adapters for running components with Silent System
- ▶ 6 overrun strips
- ▶ 1 special tool

Advice:

- ▶ Please order profiles separately
- ▶ Set of fittings for doors with Silent System must be ordered separately

| Door type | Minimum door width in mm | Order no. | PU |
|--------------------|--------------------------|------------------|-------|
| Glass sliding door | 450 | 9 184 566 | 1 set |

Upgrade set for screw mounted 6 mm glass doors with Silent System

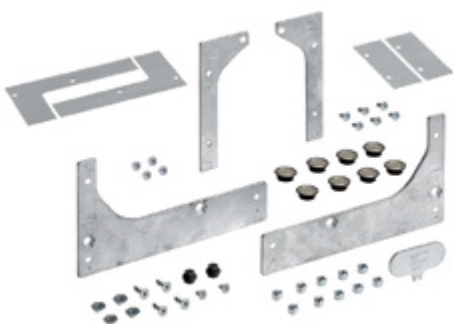

- ▶ Set contains all the upgrade components required for screw mounting 1 glass sliding door with Silent System
- ▶ Suitable for 6 mm glass sliding doors

Set comprises:

- ▶ 2 screw on mounting adapters for guide components
- ▶ 2 screw on mounting adapters for running components with Silent System
- ▶ 8 discs for running and guide components, including washers, bushings and cover caps
- ▶ 2 guide bushes
- ▶ 4 cover films
- ▶ 1 special tool
- ▶ Fixing screws

Advice:

- ▶ Please order profiles separately
- ▶ Set of fittings for doors with Silent System must be ordered separately

| Door type | Minimum door width in mm | Order no. | PU |
|-------------------------|--------------------------|------------------|-------|
| 6 mm glass sliding door | 450 | 9 184 595 | 1 set |

Upgrade set for screw mounted 6 mm glass doors without Silent System

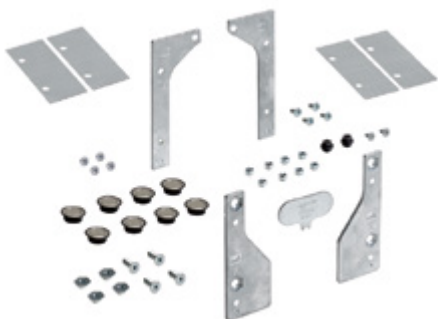

- ▶ Set contains all the upgrade components required for screw mounting 1 glass sliding door without Silent System
- ▶ Suitable for 6 mm glass sliding doors

Set comprises:

- ▶ 2 screw on mounting adapters for guide components
- ▶ 2 screw on mounting adapters for running components without Silent System
- ▶ 8 discs for running and guide components, including washers, bushings and cover caps
- ▶ 2 guide bushes
- ▶ 4 cover films
- ▶ 1 special tool
- ▶ Fixing screws

Advice:

- ▶ Please order profiles separately
- ▶ Set of fittings for doors without Silent System must be ordered separately

| Door type | Minimum door width in mm | Order no. | PU |
|-------------------------|--------------------------|------------------|-------|
| 6 mm glass sliding door | 300 | 9 184 596 | 1 set |

- ▶ SlideLine M / overlay door position
- ▶ System components

Upgrade set for 19 mm aluminium frame doors with Silent System

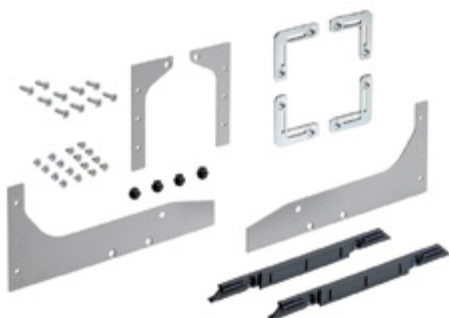

- ▶ Set contains all the upgrade components required for installing one 19 mm aluminium framed door with Silent System

Set comprises:

- ▶ 2 guide component mounting adapters
- ▶ 2 mounting adapters for running components with Silent System
- ▶ 4 L shaped corner gussets
- ▶ 4 screw on blocks
- ▶ 4 guide bushes
- ▶ Fixing screws

Advice:

- ▶ Please order profiles separately
- ▶ Set of fittings for doors with Silent System must be ordered separately

Page reference:

Please refer to page 20 for the cross section of suitable aluminium frame profiles.

| Door type | Colour | Minimum door width in mm | Order no. | PU |
|-----------------------------|--------|--------------------------|------------------|-------|
| 19 mm aluminium framed door | silver | 450 | 9 184 626 | 1 set |
| 19 mm aluminium framed door | black | 450 | 9 184 703 | 1 set |

Upgrade set for 19 mm aluminium frame doors without Silent System

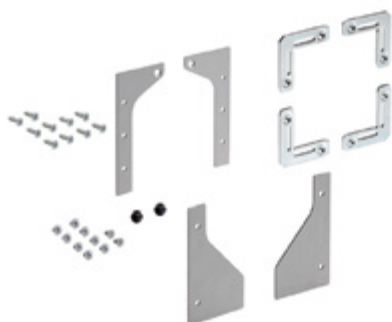

- ▶ Set contains all the upgrade components required for installing one 19 mm aluminium framed door without Silent System

Set comprises:

- ▶ 2 guide component mounting adapters
- ▶ 2 mounting adapters for running components without Silent System
- ▶ 4 L shaped corner gussets
- ▶ 2 guide bushes
- ▶ Fixing screws

Advice:

- ▶ Please order profiles separately
- ▶ Set of fittings for doors without Silent System must be ordered separately

Page reference:

Please refer to page 20 for the cross section of suitable aluminium frame profiles.

| Door type | Colour | Minimum door width in mm | Order no. | PU |
|-----------------------------|--------|--------------------------|------------------|-------|
| 19 mm aluminium framed door | silver | 300 | 9 184 629 | 1 set |
| 19 mm aluminium framed door | black | 300 | 9 184 706 | 1 set |



**TRADEMARK
HARDWARE**
WWW.TMHARDWARE.COM

Sliding door system / bottom running

- ▶ SlideLine M / overlay door position
- ▶ System components

Profile sets: 2 profiles

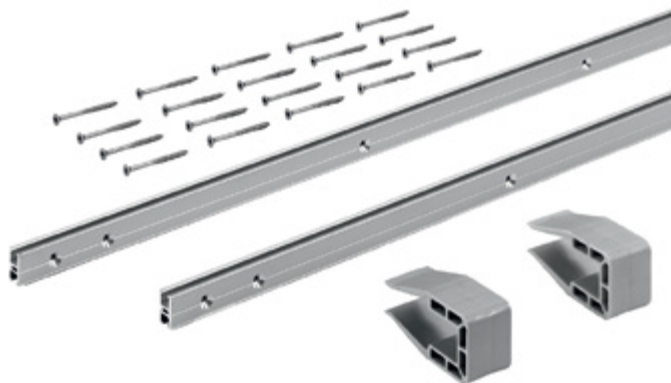

- ▶ Profiles can be shortened as required
- ▶ If long enough, profiles can be cut into two and used as top and bottom runner profiles
- ▶ Coloured sets contain twice as many end caps

Set comprises:

- ▶ 2 runner profiles, aluminium, silver anodized, predrilled
- ▶ 2 mounting clips
- ▶ Fixing material

Advice:

- ▶ Coloured sets for concealing the runner profiles with a coloured cover must be ordered separately

| Profile height mm | Shelf thickness in mm | Length mm | Order no. | PU |
|-------------------|-----------------------|-----------|------------------|-------|
| 16 | 15, 16 | 2500 | 9 209 165 | 1 set |
| 16 | 15, 16 | 4000 | 9 209 166 | 1 set |
| 18 | 18, 19 | 2500 | 9 209 167 | 1 set |
| 18 | 18, 19 | 4000 | 9 209 218 | 1 set |
| 22 | 22 | 2500 | 9 209 219 | 1 set |
| 22 | 22 | 4000 | 9 209 220 | 1 set |
| 25 | 25 | 2500 | 9 209 221 | 1 set |
| 25 | 25 | 4000 | 9 209 222 | 1 set |

Profile sets: 1 profile

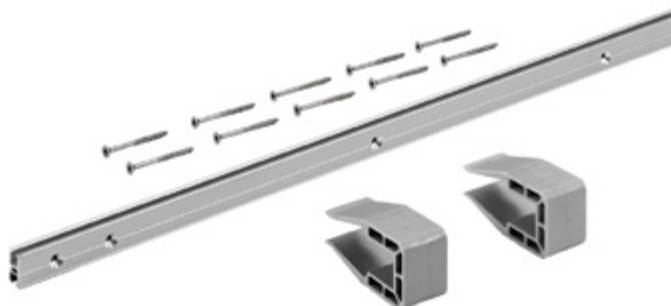

- ▶ Single profiles set as upgrade for furniture applications with doors running across each other
- ▶ Profiles can be shortened as required
- ▶ If long enough, profiles can be cut into two and used as top and bottom runner profiles
- ▶ Coloured sets contain twice as many end caps

Set comprises:

- ▶ 1 aluminium runner profile, silver anodized, predrilled
- ▶ 2 mounting clips
- ▶ Fixing screws

Advice:

- ▶ Coloured sets for concealing the runner profiles with a coloured cover must be ordered separately

| Profile height mm | Shelf thickness in mm | Length mm | Order no. | PU |
|-------------------|-----------------------|-----------|------------------|-------|
| 16 | 15, 16 | 2500 | 9 209 223 | 1 set |
| 16 | 15, 16 | 4000 | 9 209 224 | 1 set |
| 18 | 18, 19 | 2500 | 9 209 225 | 1 set |
| 18 | 18, 19 | 4000 | 9 209 226 | 1 set |
| 22 | 22 | 2500 | 9 209 228 | 1 set |
| 22 | 22 | 4000 | 9 209 229 | 1 set |
| 25 | 25 | 2500 | 9 209 230 | 1 set |
| 25 | 25 | 4000 | 9 209 231 | 1 set |



TRADEMARK
HARDWARE
WWW.TMHARDWARE.COM

- ▶ SlideLine M / overlay door position
- ▶ System components



Coloured sets for concealing the runner profiles with a coloured cover

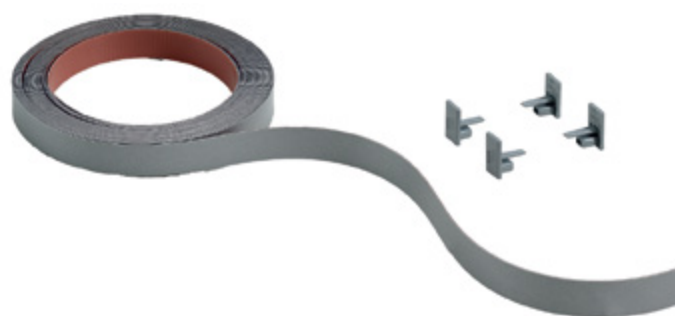

- ▶ Set contains all the components required for concealing 1 runner profile with a coloured cover

Set comprises:

- ▶ 1 ABS decorative profile for gluing on
- ▶ 2 end caps
- ▶ 2 end caps (replacement)

Advice:

- ▶ For each profile set: 2 profiles, please order 2 coloured sets separately
- ▶ For each profile set: 1 profile, please order 1 coloured set separately

| Profile height mm | Colour | Length mm | Order no. | PU |
|-------------------|-----------|-----------|------------------|-------|
| 16 | silver | 2500 | 9 209 232 | 1 set |
| 16 | silver | 4000 | 9 209 268 | 1 set |
| 16 | black | 2500 | 9 209 269 | 1 set |
| 16 | black | 4000 | 9 209 271 | 1 set |
| 16 | white | 2500 | 9 209 272 | 1 set |
| 16 | white | 4000 | 9 209 273 | 1 set |
| 16 | champagne | 2500 | 9 209 274 | 1 set |
| 16 | champagne | 4000 | 9 209 275 | 1 set |
| 18 | silver | 2500 | 9 209 277 | 1 set |
| 18 | silver | 4000 | 9 209 278 | 1 set |
| 18 | black | 2500 | 9 209 279 | 1 set |
| 18 | black | 4000 | 9 209 280 | 1 set |
| 18 | white | 2500 | 9 209 281 | 1 set |
| 18 | white | 4000 | 9 209 283 | 1 set |
| 18 | champagne | 2500 | 9 209 284 | 1 set |
| 18 | champagne | 4000 | 9 209 285 | 1 set |
| 22 | silver | 2500 | 9 209 286 | 1 set |
| 22 | silver | 4000 | 9 209 287 | 1 set |
| 22 | black | 2500 | 9 209 308 | 1 set |
| 22 | black | 4000 | 9 209 309 | 1 set |
| 22 | white | 2500 | 9 209 310 | 1 set |
| 22 | white | 4000 | 9 209 311 | 1 set |
| 22 | champagne | 2500 | 9 209 312 | 1 set |
| 22 | champagne | 4000 | 9 209 313 | 1 set |
| 25 | silver | 2500 | 9 209 399 | 1 set |
| 25 | silver | 4000 | 9 209 400 | 1 set |
| 25 | black | 2500 | 9 209 402 | 1 set |
| 25 | black | 4000 | 9 209 403 | 1 set |
| 25 | white | 2500 | 9 209 404 | 1 set |
| 25 | white | 4000 | 9 209 405 | 1 set |
| 25 | champagne | 2500 | 9 209 406 | 1 set |
| 25 | champagne | 4000 | 9 209 407 | 1 set |

Spacer profile

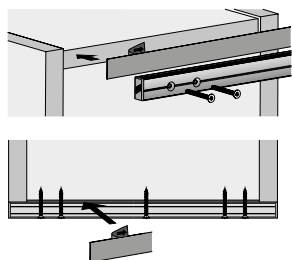

- ▶ For use with set back shelves
- ▶ Prevents deflection of the runner profiles
- ▶ Simply sticks onto shelf between side and centre panels
- ▶ Positively connected solution without gap between shelf and profile
- ▶ Supplied on 15 m roll
- ▶ Easily shortened
- ▶ Thickness 1 mm
- ▶ Colour: grey

| Profile height mm | Shelf thickness in mm | Order no. | PU |
|-------------------|-----------------------|-----------|-------|
| 16 | 16 - 19 | 9 200 421 | 1 ea. |
| 22 | 22 - 25 | 9 200 422 | 1 ea. |

Spacers

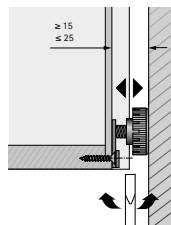

- ▶ For depth compensation in the lower section of the rear panel
- ▶ Depth compensation from 15 - 25 mm
- ▶ Self adhesive for easy installation; can be additionally secured by screws
- ▶ Black plastic

| Order no. | PU |
|-----------|-----------|
| 0 020 784 | 1/100 ea. |

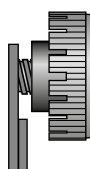
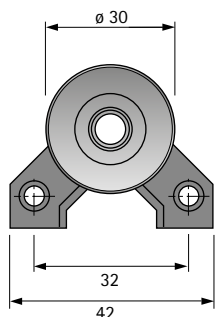

Spacer rings

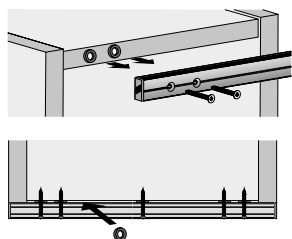

- ▶ For use with set back shelves
- ▶ Prevents deflection of the runner profiles
- ▶ Easy glue mounting on the rear of the profile
- ▶ Ring diameter 16 mm
- ▶ Thickness 1 mm
- ▶ Plastic, colourless

Set comprises:
▶ 30 spacer rings

- Advice:
- ▶ Guide value for quantity required:
 - ▶ Profile set, 2,500 mm, with 2 profiles, approx. 38 spacer rings
 - ▶ Profile set, 4,000 mm, with 2 profiles, approx. 54 spacer rings
 - ▶ Alternatively, the spacer profile can be used for evenly set back shelves

| Order no. | PU |
|-----------|------------|
| 9 206 405 | 1/200 sets |

Intended Use

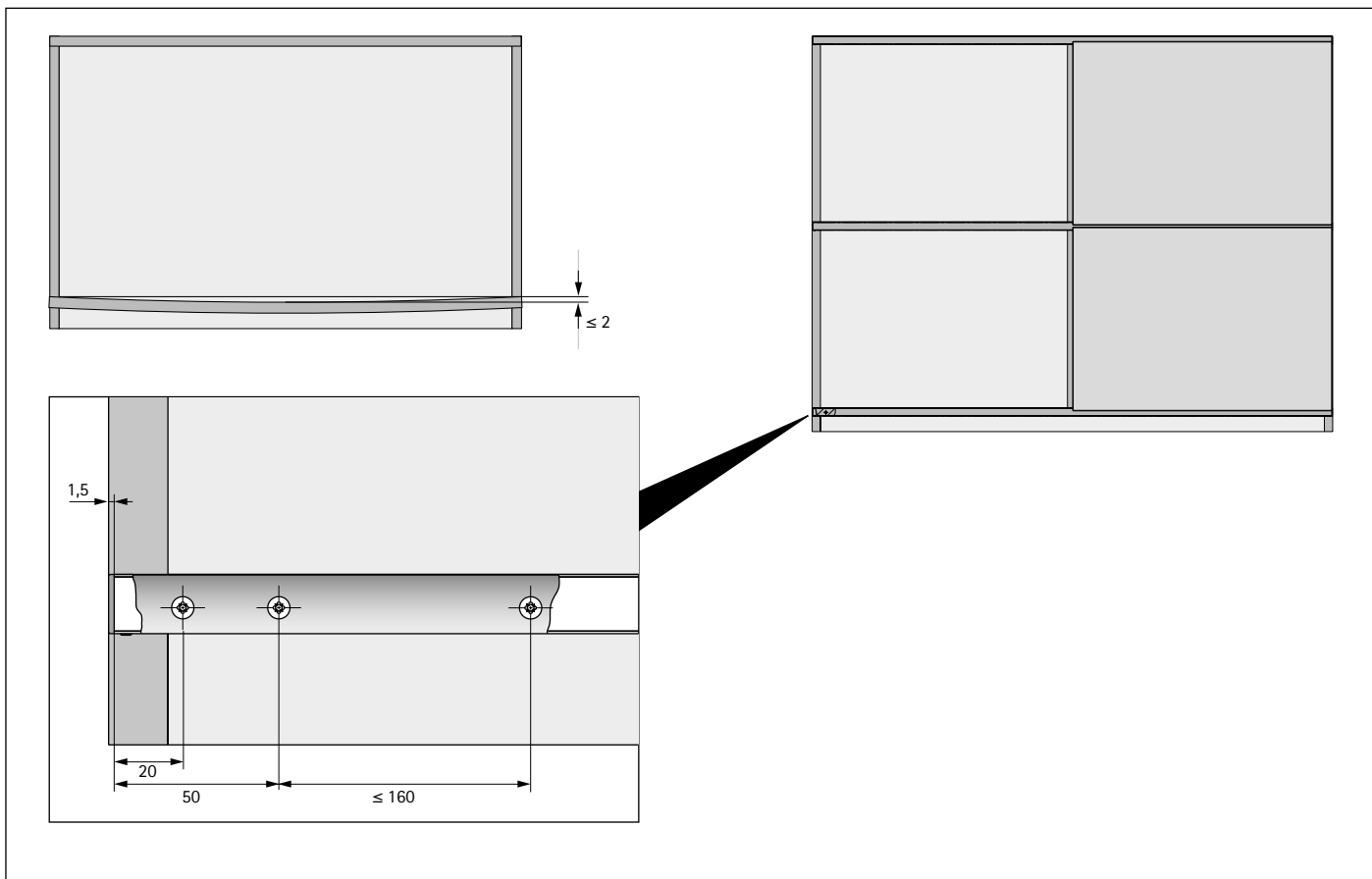

Intended use

The SlideLine M furniture fitting is intended for application in furniture and use in dry indoor environments where it is protected from the elements. The version of the fitting with Silent System meets the requirements under DIN EN 15706 Level 3. The version of the fitting without Silent System meets the requirements under DIN EN 15706 Level 1.

Technical specifications

| | | |
|----------------------------|--|---------|
| Door weight: | up to 30 kg | |
| Door size: | Min. | Max. |
| Width: | 300 mm | 1800 mm |
| Height: | 300 mm | 2000 mm |
| Max. height H for width W: | $H \leq 2 B$ | |
| Shelf thicknesses: | 15 mm, 16 mm, 18 mm, 19 mm, 22 mm, 25 mm | |
| Height adjustment: | +/- 2.0 mm | |

When constructing furniture, it is important to note that the sliding door must be no higher than twice its width. Up to this relative height, SlideLine M meets the above-stated quality and safety requirements under DIN EN 15706. If the specified maximum relative height is exceeded, the furniture construction must undergo a function and safety test as defined in the relevant furniture standard.

Under DIN EN 15706 Level 1, the version of the fitting without Silent System is approved for use if it passes the 2 kg closing test specified there. If a higher load capacity is to be reached, e.g. on the grounds of requirements defined in a relevant furniture standard, this must be ensured by the fabricator in terms of furniture design (e.g. inset installation).



Safety risk

The SlideLine M sliding door fitting is only suitable for applications in which the design of furniture and its dimensional accuracy are capable of ensuring that the top and bottom runners always remain parallel (i.e. also in the case where there is a particularly heavy load on a shelf to which a runner is connected, for example) with a tolerance of no more than +/- 1 mm from the specified distance between both runners. Any failure to meet this requirement, e.g. as a result of sag in the panel to which the bottom runner is mounted, presents a safety risk (door falling out of the runner) that may cause personal injury. The stops must be securely mounted in the profile or safety could be put at risk (from door coming off at side) which may result in personal injury.

- SlideLine M / overlay door position
- Planning dimensions



Installation dimensions wooden door with Silent System / 55 mm aluminium framed door

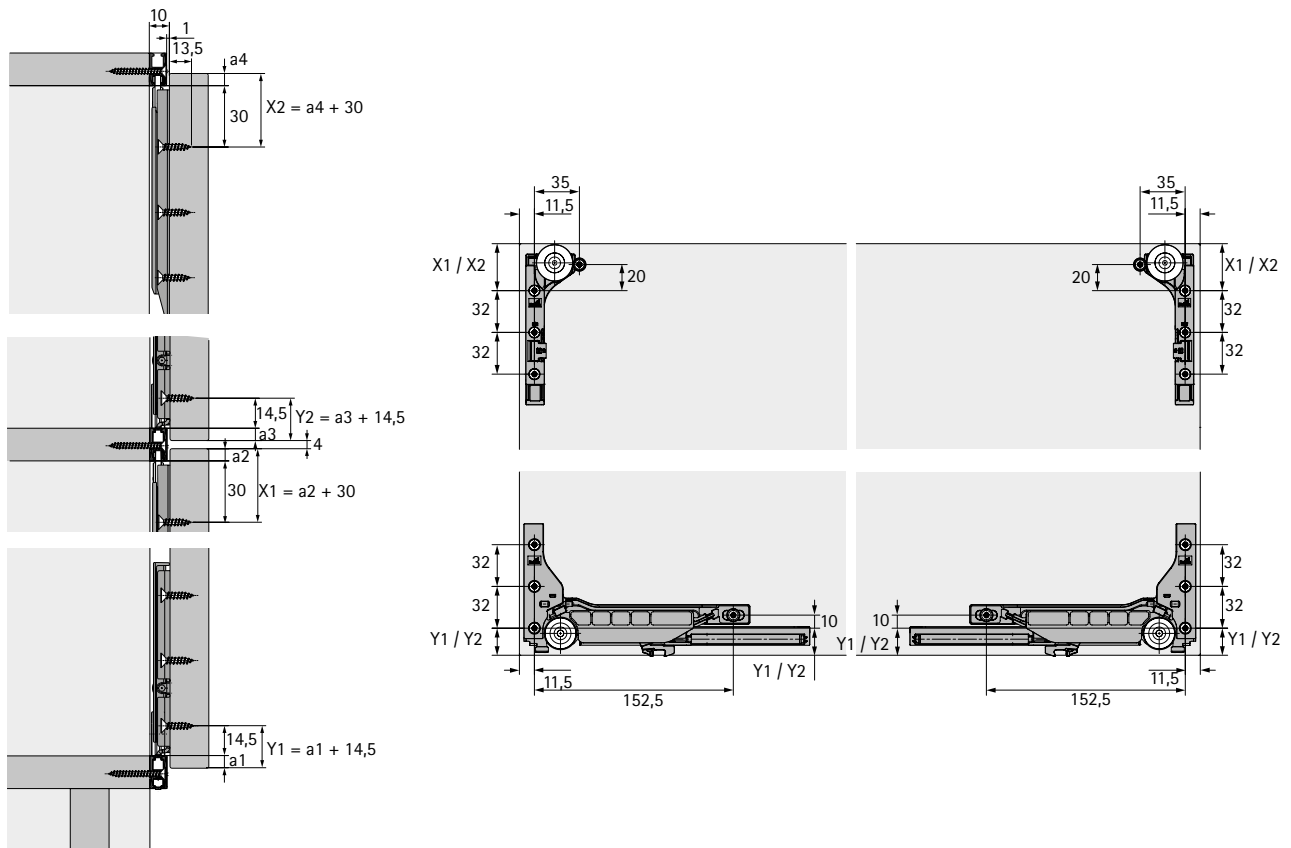

Installation dimensions for wooden door / 55 mm aluminium frame door without Silent System

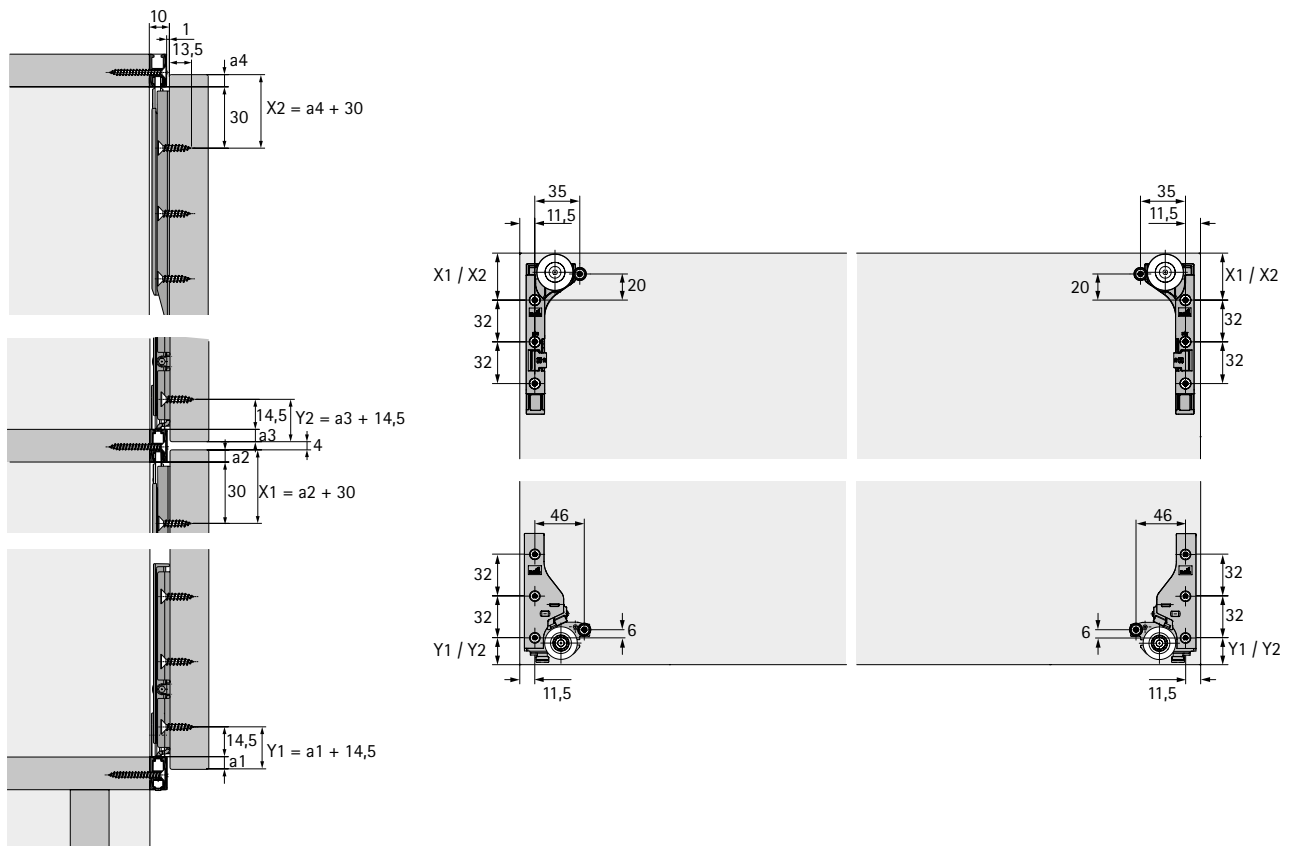

- ▶ SlideLine M / overlay door position
- ▶ Planning dimensions



Installation dimensions for glue mounted glass door with Silent System

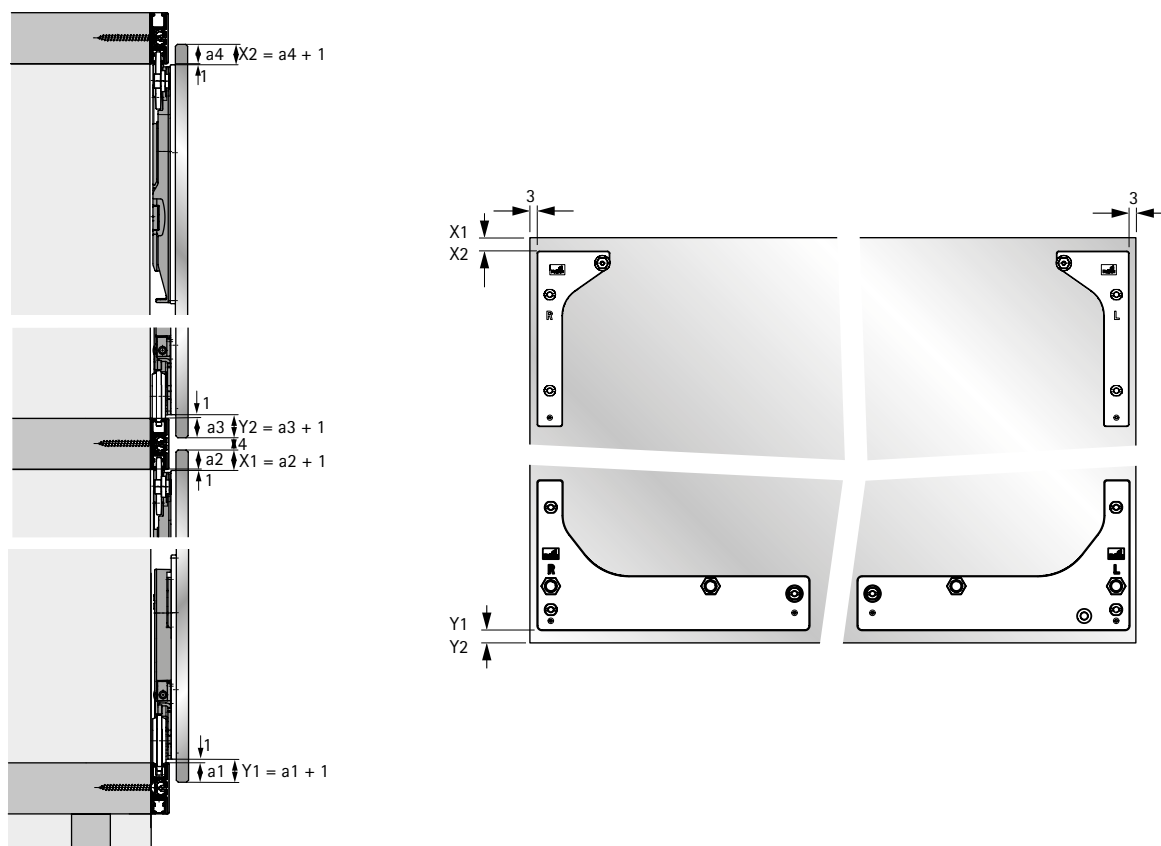

Sliding door system / bottom running

- SlideLine M / overlay door position
- Planning dimensions



**TRADEMARK
HARDWARE**
WWW.TMHARDWARE.COM

Installation dimensions for screw mounted glass door with Silent System

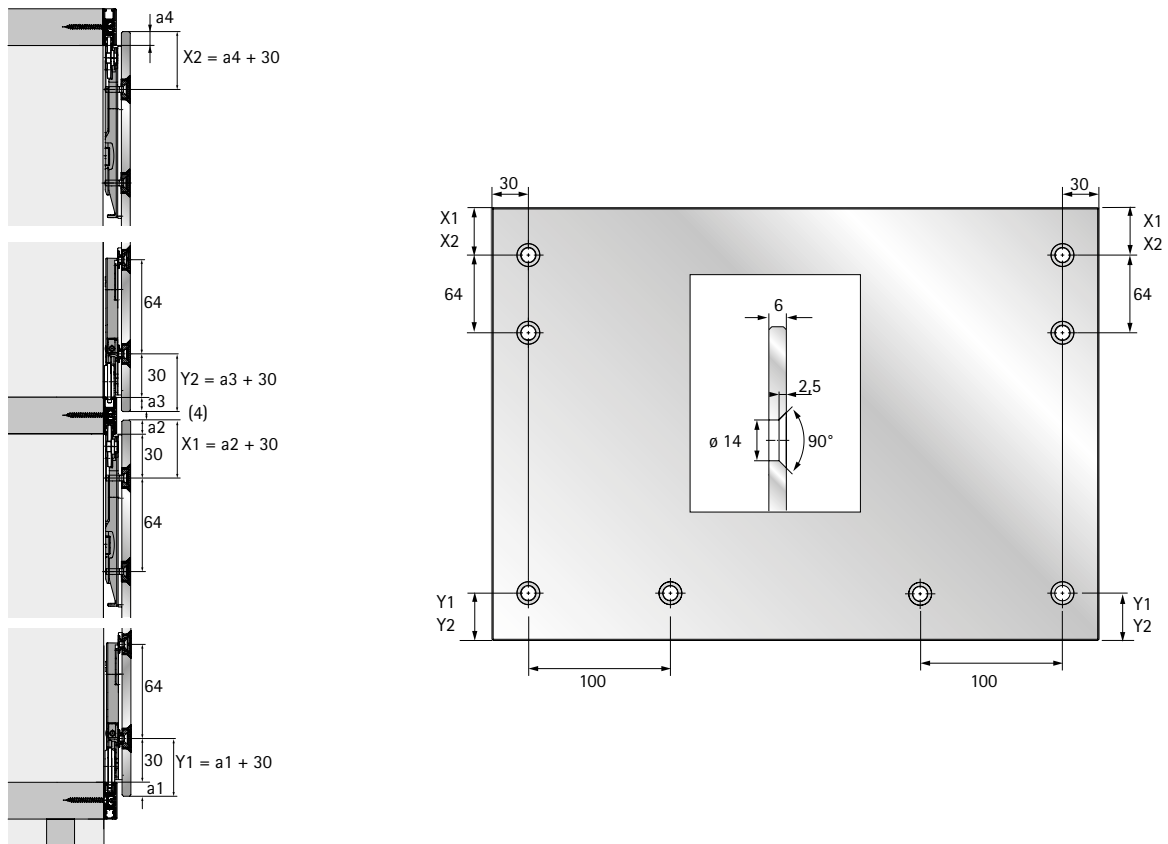

Installation dimensions for screw mounted glass door without Silent System

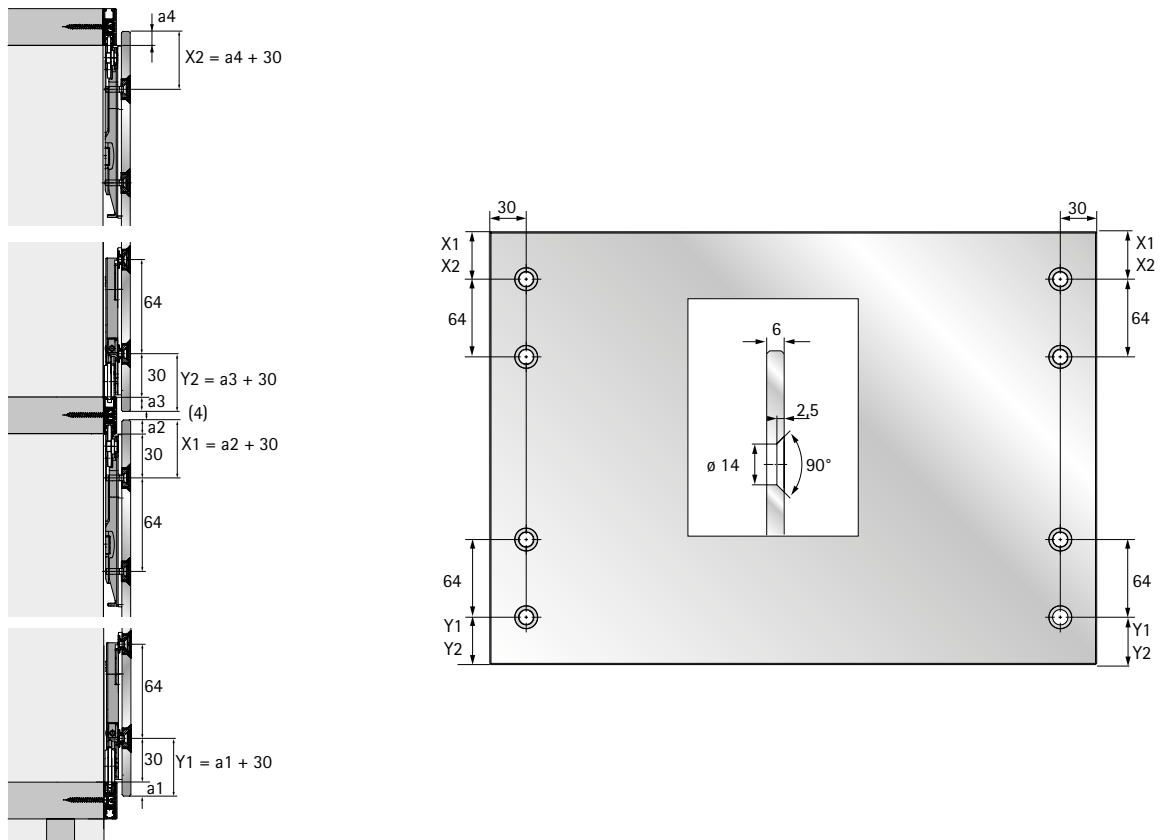

- ▶ SlideLine M / overlay door position
- ▶ Planning dimensions



Installation dimensions for 19 mm aluminium framed doors with Silent System

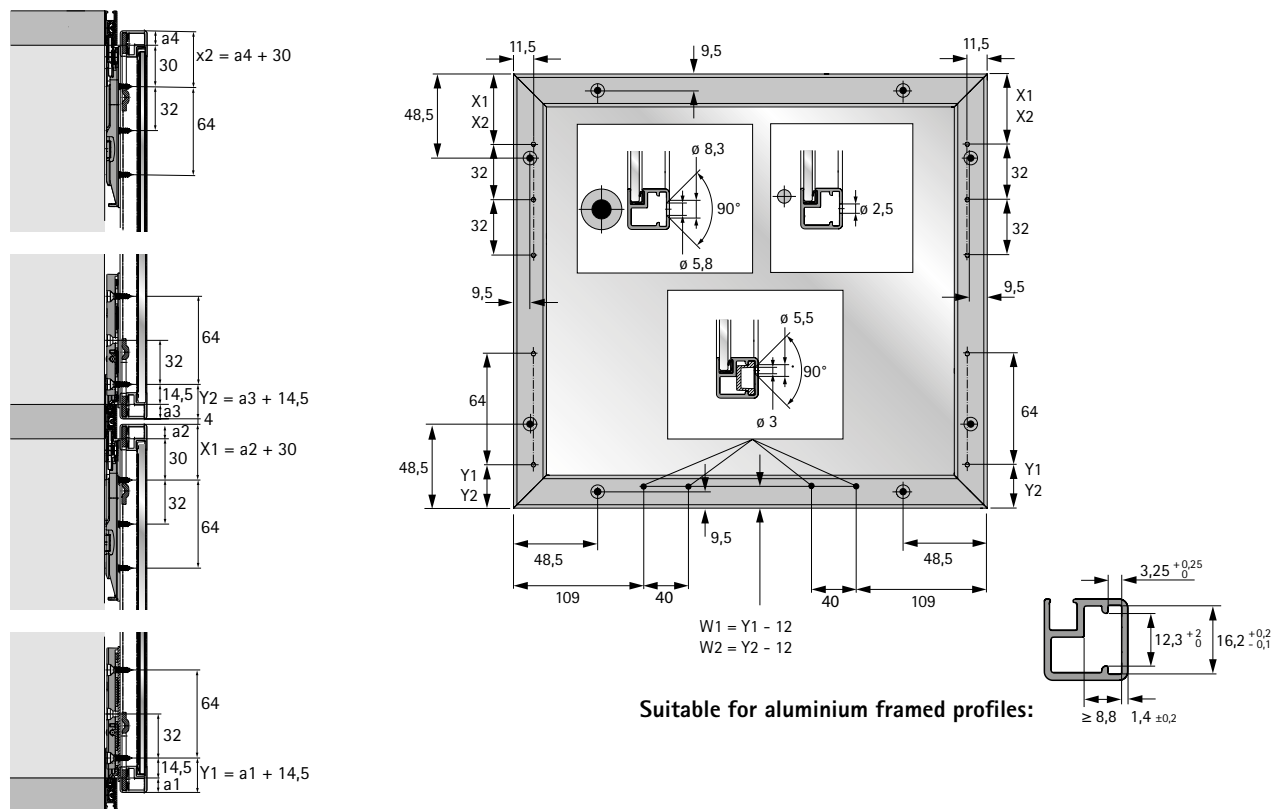

Installation dimensions for 19 mm aluminium frame door without Silent System

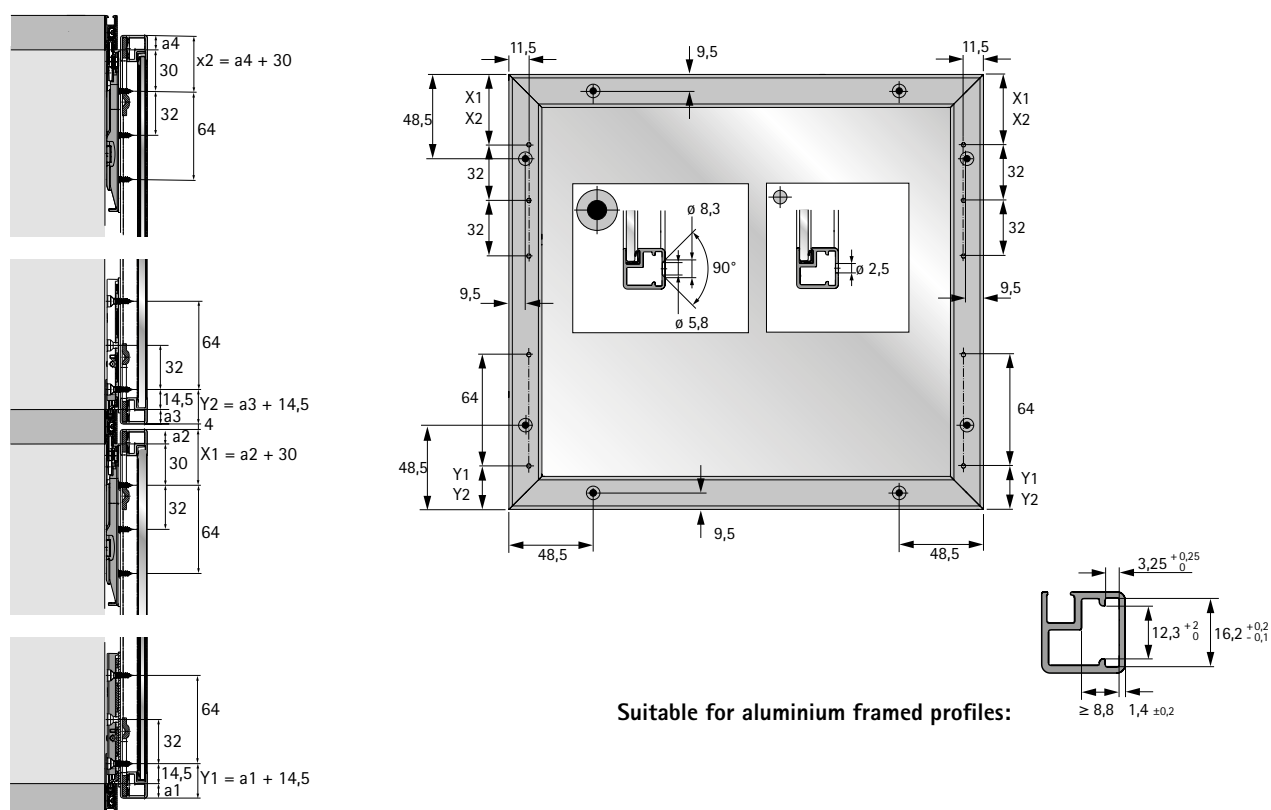

- ▶ SlideLine M / overlay door position
- ▶ Planning dimensions



Soft colliding for two or more doors

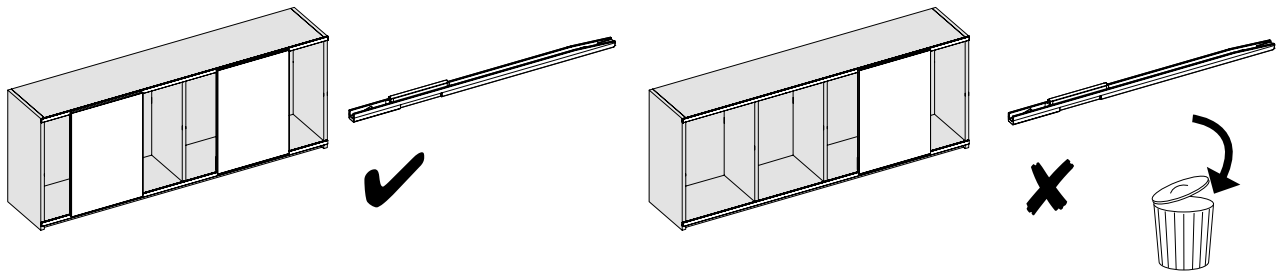

If two or more sliding doors run in one plane, they can be slowed down by soft colliding as they move towards each other.

Installation dimensions for soft colliding

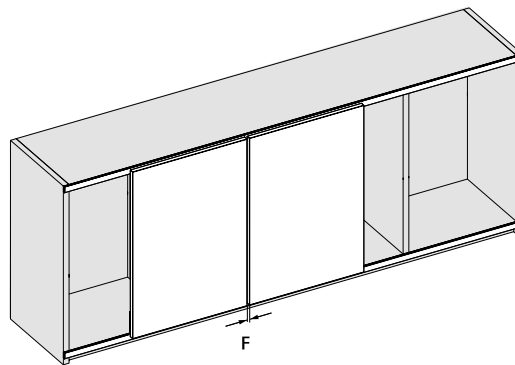

The centre reveal F between two wooden doors can be influenced by the position of drill holes B1 and B2 for the running and guide components. Use of the standard drilling pattern produces a centre reveal of $F = 10$ mm.

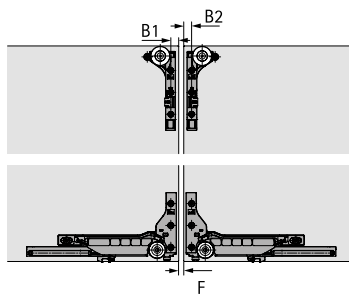

| Centre reveal F mm | Drilling position B1 mm | Drilling position B2 mm |
|-------------------------|----------------------------|----------------------------|
| 10 | 11,5 | 11,5 |
| 8 | 12,5 | 12,5 |
| 6 | 13,5 | 13,5 |
| 4 | 14,5 | 14,5 |
| 2 | 15,5 | 15,5 |

Depending on door width, door height and closing speed, door tops may collide if the centre reveal is < 10 mm. For this reason, Hettich recommends a centre reveal F of 10 mm for aluminium framed doors and glass doors.

Installing the soft colliding element for two or more doors

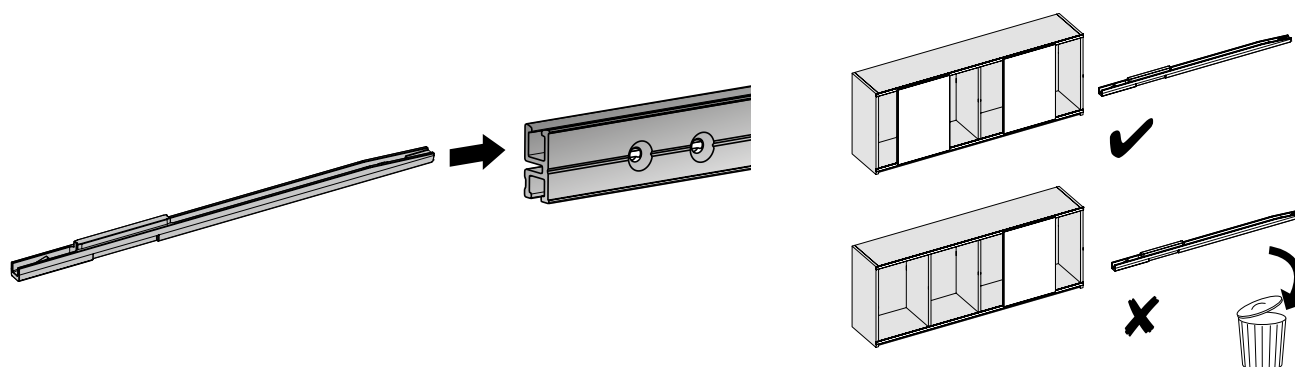

Installing activators and end stops in the runner profile

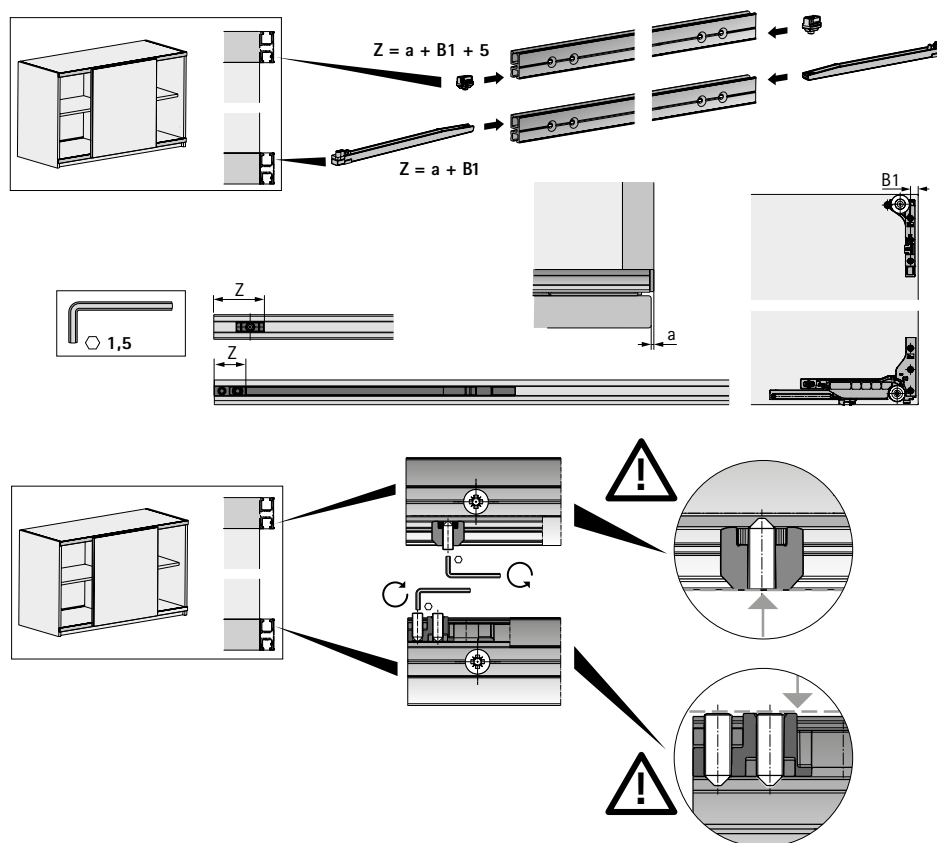

Installing end caps

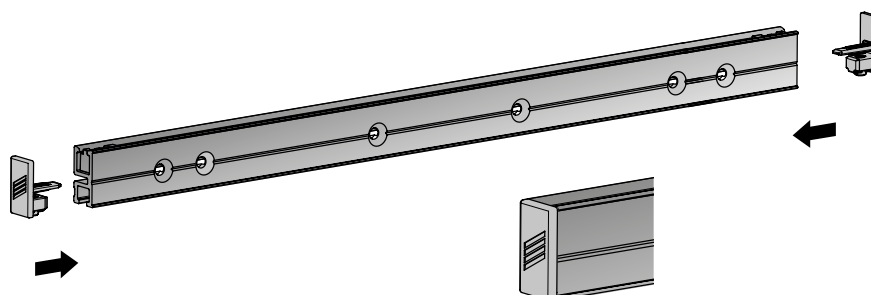

- ▶ SlideLine M / overlay door position
- ▶ Installation



Installing the runner profiles and decorative profiles

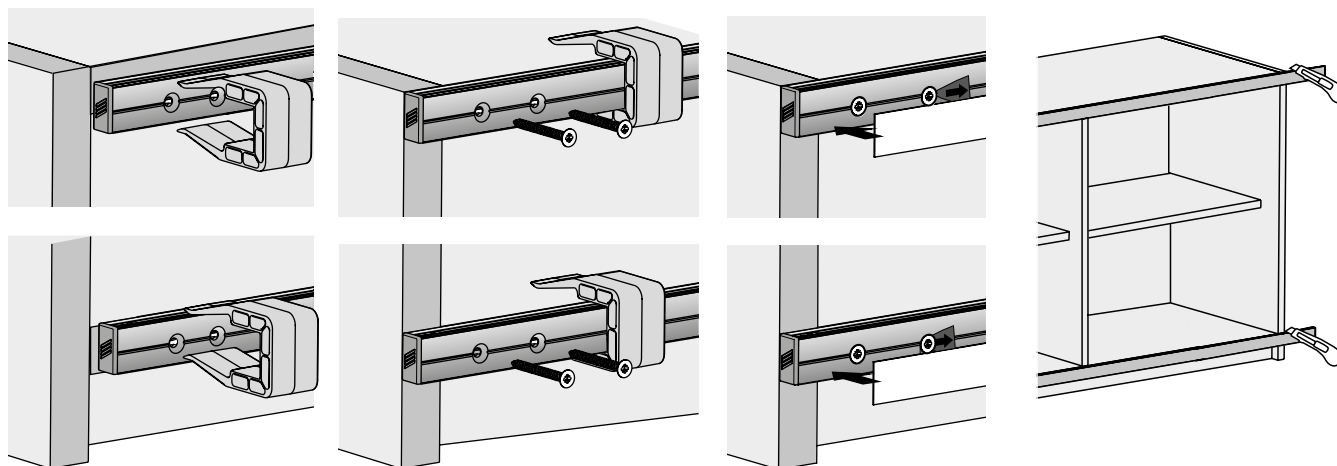

Installing the fitting and upgrade sets

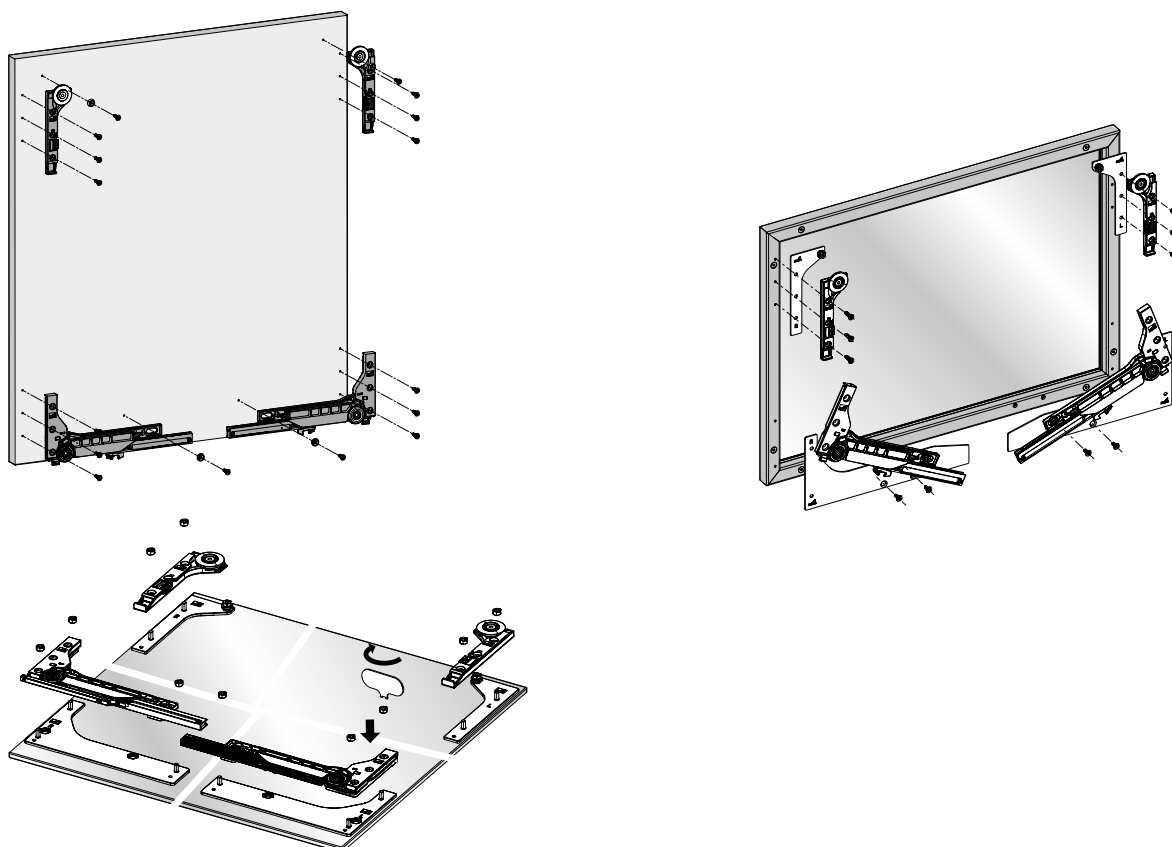

- ▶ SlideLine M / overlay door position
- ▶ Installation



Installing door

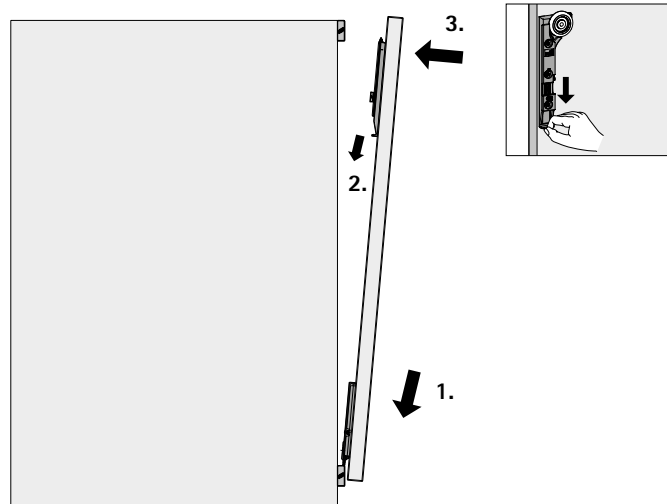
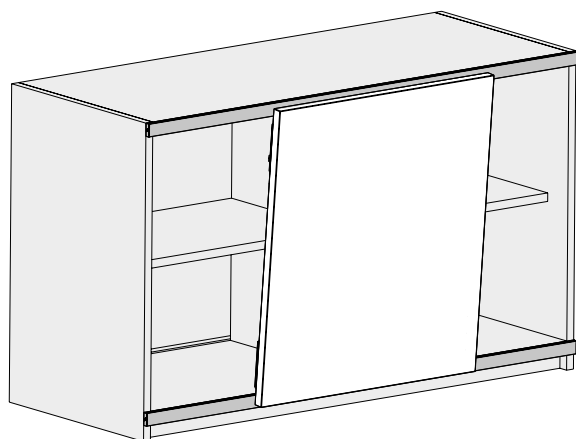

Installing several doors with soft colliding

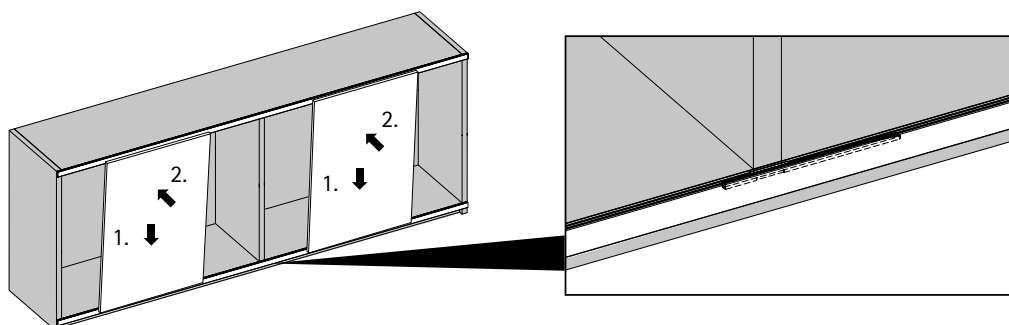
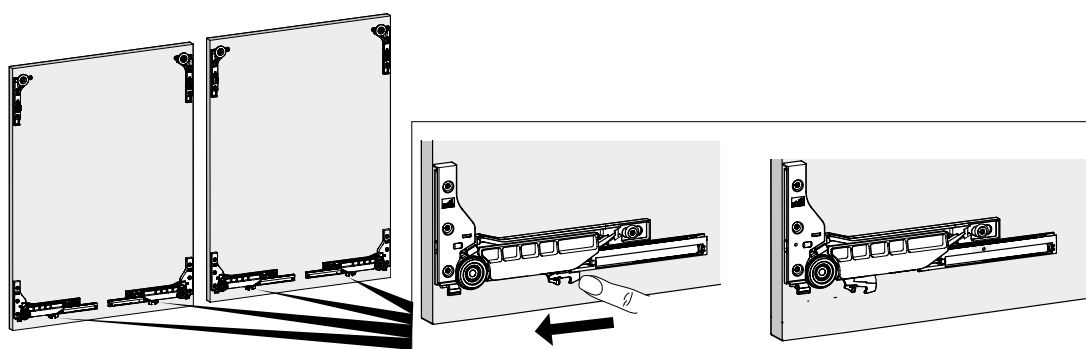

- ▶ SlideLine M / overlay door position
- ▶ Installation



Aligning door

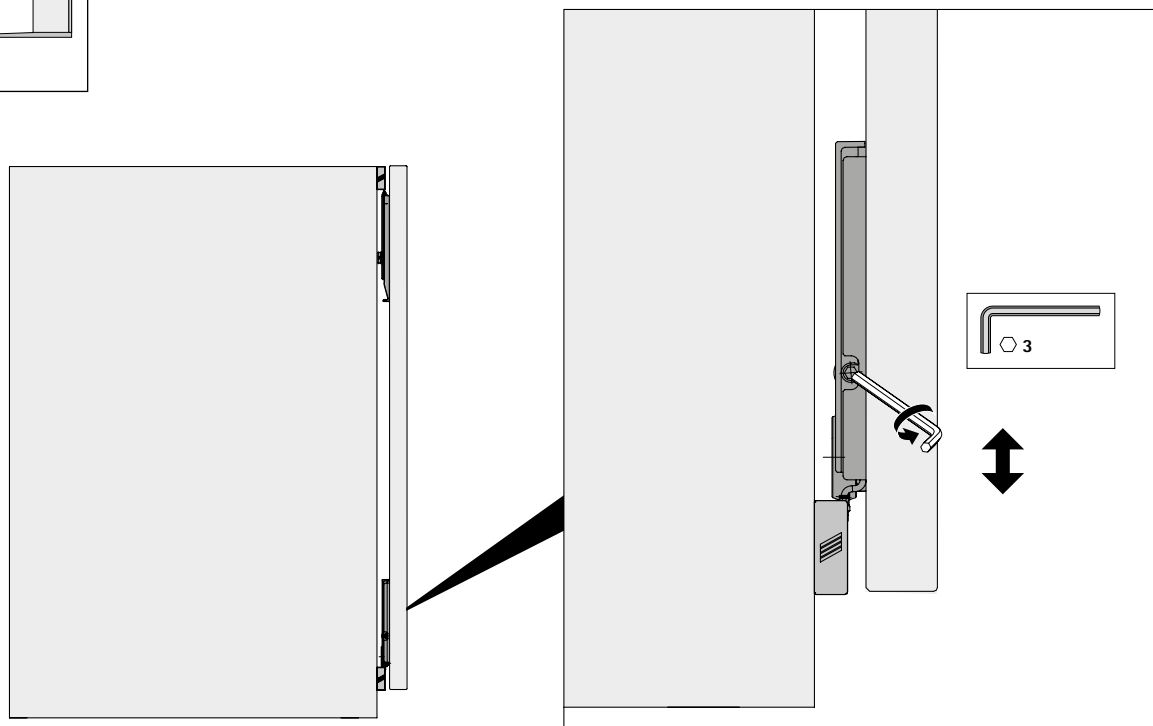
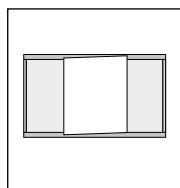

Securing door

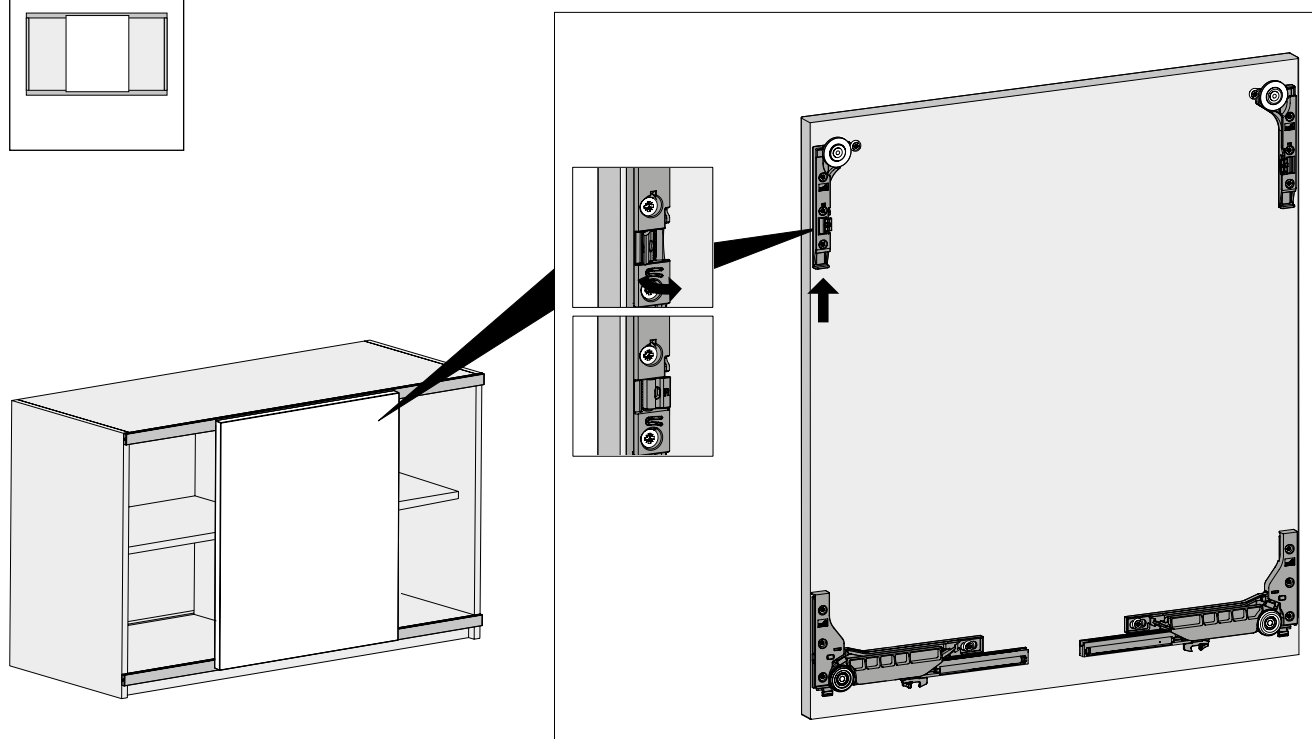
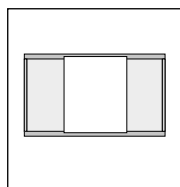

Sliding door system / bottom running

- ▶ SlideLine M / inset door position
- ▶ All the benefits at a glance



**TRADEMARK
HARDWARE**
WWW.TMHARDWARE.COM



One system, countless applications. SlideLine M makes child's play of designing and assembling 2-door or 3-door cabinets. There's no limits to your creativity. Whether in the kitchen wall unit, as a clever alcove solution, in children's bedroom furniture or in the sideboard, SlideLine M impresses with its tremendous versatility. Wooden, aluminium framed or glass doors weighing up to 30 kg are quietly and

gently slowed down in closing, opening and colliding direction. The runner and guide profiles can be installed on all sorts of carcass and worktop materials as they can either be screwed on, stuck on or groove mounted.



Design option:
Whether in the wall unit or as clever alcove solution, SlideLine M is an integral part of the modern kitchen.

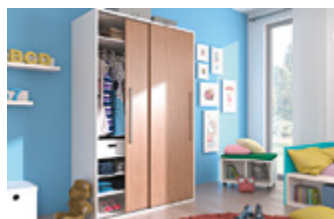

No risk of trapping: SlideLine M's inset door position and Silent System is also safe for children's little hands and feet.



Tried and tested system:
use of the standard SlideLine M fitting sets.



Installation options:
The runner and guide profiles can either be screwed on, stuck on or groove mounted.

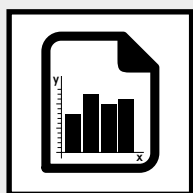

Performance summary

26 – 27

- ▶ Technical details in brief
- ▶ Door sizes
- ▶ Silent System
- ▶ Operating principle

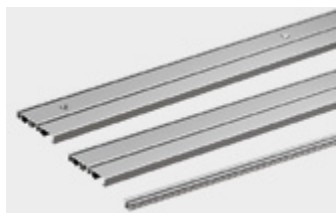

System components

28 – 30

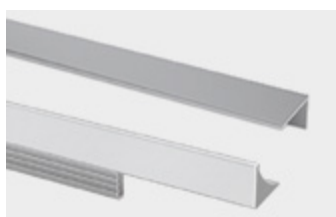

Accessories

31 – 32

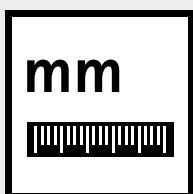

Planning dimensions

33



Installation

34 – 37



Accessories

38 – 52



Technical information

38 – 39

- ▶ Calculating door weights
- ▶ Design advice sliding door systems
- ▶ Quality criteria

40 – 42

43

Sliding door system / bottom running

- ▶ SlideLine M / inset door position
- ▶ Performance summary



**TRADEMARK
HARDWARE**
WWW.TMHARDWARE.COM

Technical details in brief

- ▶ 1-track or 2-track bottom-running sliding door system
- ▶ Inset door position
- ▶ Wooden, glass or aluminium framed doors
- ▶ 1-door, 2-door or 3-door application
- ▶ Runner and guide profile for screwing on or pressing in
- ▶ Door weight up to 30 kg
- ▶ Door height up to 2000 mm
- ▶ Door width from 300 - 1800 mm
- ▶ +/- 2 mm height adjustment
- ▶ Silent System in closing, opening and colliding direction
- ▶ Door quickly mounted without the need for tools
- ▶ Tested to EN 15706, Level 3

Door format and door weight

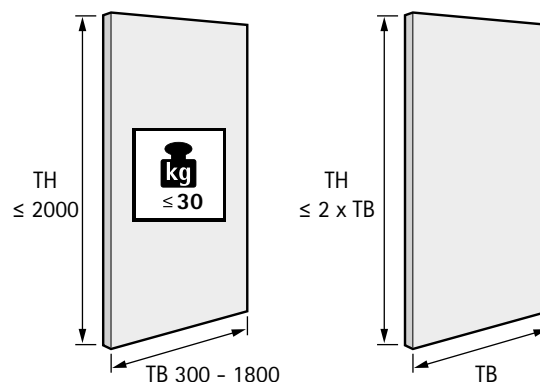

| TB | 300 | 400 | 500 | 600 | 700 | 800 | 900 | 1000 | ... | 1800 |
|------|-----|-----|------|------|------|------|------|------|-----|------|
| TH ≤ | 600 | 800 | 1000 | 1200 | 1400 | 1600 | 1800 | 2000 | ... | 2000 |



see page 38 - 39

Door material

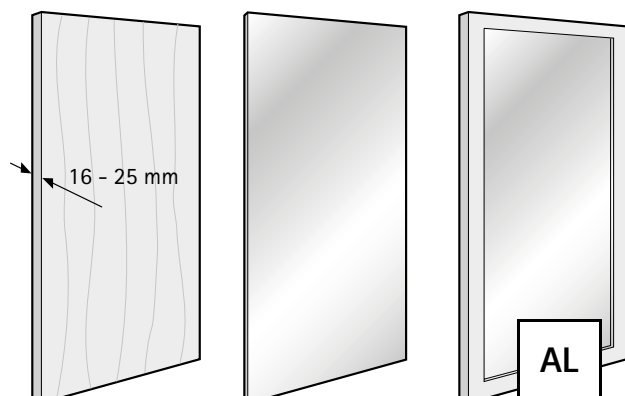

Number of door wings and door position

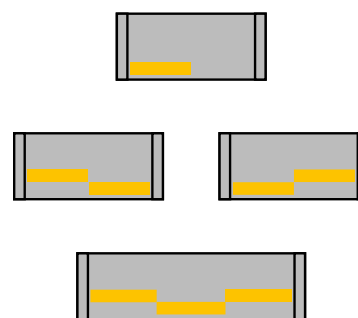

Silent System

| | 1-door | 2-door | 3-door | |
|----------------|--------|--------|--------|--|
| Soft closing | | | | |
| Soft opening | | | | |
| Soft colliding | | | | |

- ▶ SlideLine M / inset door position
- ▶ Performance summary



Operating principle / 2-track runner profile for screwing on / gluing on

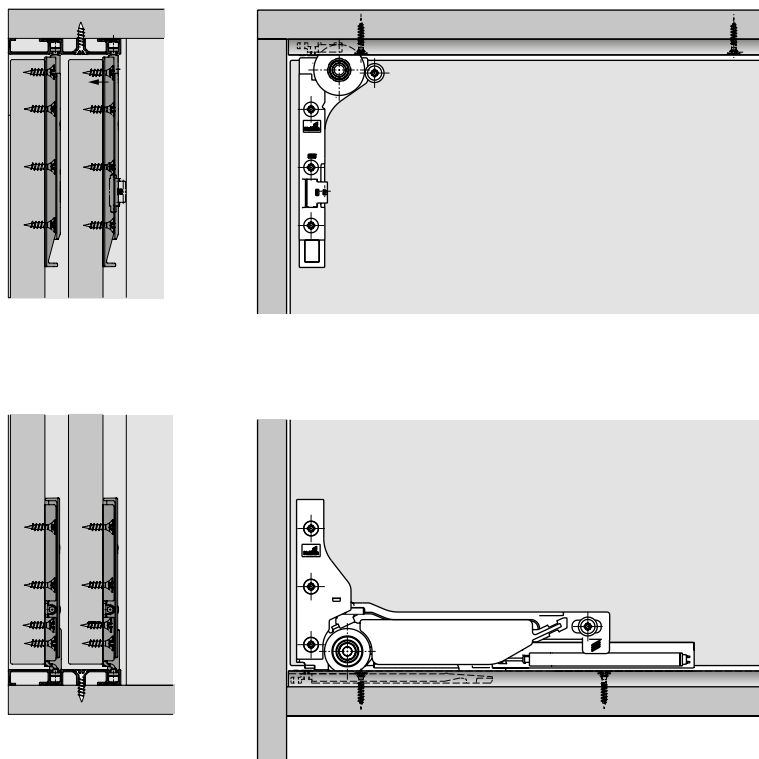

Operating principle / 1-track runner profile for pressing in

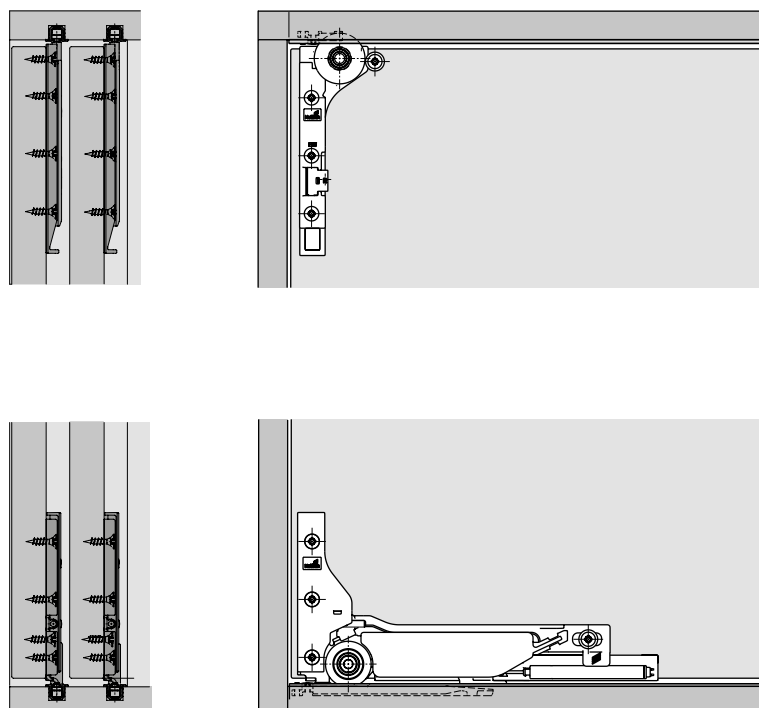

- ▶ SlideLine M / inset door position
- ▶ System components

Profile set: 2-track runner profile for screwing on / gluing on

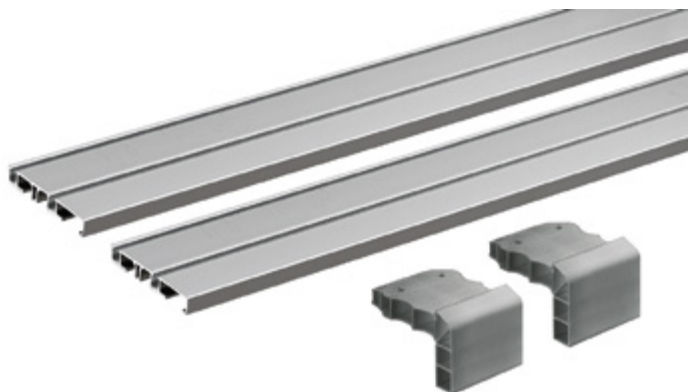

- ▶ Set contains all the profile components required for a 2-door or a 3-door cabinet
- ▶ Attachment in the screw slot or attachment using suitable adhesive tape

Set comprises:

- ▶ 2 runner profiles, aluminium, silver anodized
- ▶ 2 mounting adapters

Advice:

- ▶ Please order fitting sets separately (see page 8)
- ▶ Screws used for attachment in the screw slot must be ordered separately
- ▶ Adhesive tape for glue mounting must be ordered separately

| Length mm | Order no. | PU |
|-----------|-----------|-------|
| 2500 | 9 227 245 | 1 set |

Profile set: 1-track runner profile for pressing in



- ▶ Set contains all the profile components required for a 2-door or a 3-door cabinet
- ▶ Runner profiles for pressing in

Set comprises:

- ▶ 4 runner profiles, aluminium, silver anodized

Advice:

- ▶ Please order fitting sets separately (see page 8)

| Length mm | Order no. | PU |
|-----------|-----------|-------|
| 2500 | 9 227 246 | 1 set |



**TRADEMARK
HARDWARE**
WWW.TMHARDWARE.COM

Sliding door system / bottom running

- ▶ SlideLine M / inset door position
- ▶ System components

2-track runner profile for screwing on in the screw slot / for gluing on

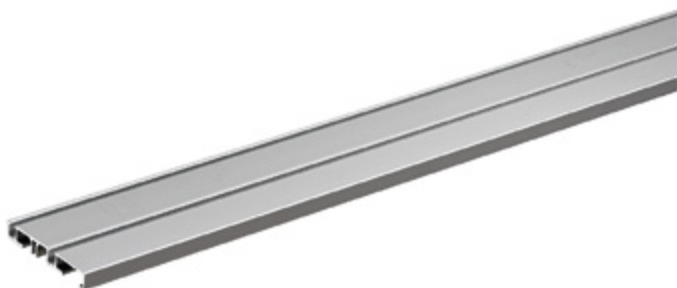

- ▶ 2-track runner profile without holes
- ▶ Attachment by screwing on in the screw slot or attachment using suitable adhesive tape
- ▶ Two runner profiles must be fitted per 2-door or 3-door cabinet
- ▶ Aluminium, silver anodized

Advice:

Customised lengths are available on request

| Length mm | Order no. | PU |
|-----------|------------------|-----------|
| 2500 | 9 227 186 | 1/100 ea. |
| 4000 | 9 236 576 | 1/100 ea. |

2-track runner profile for screwing on

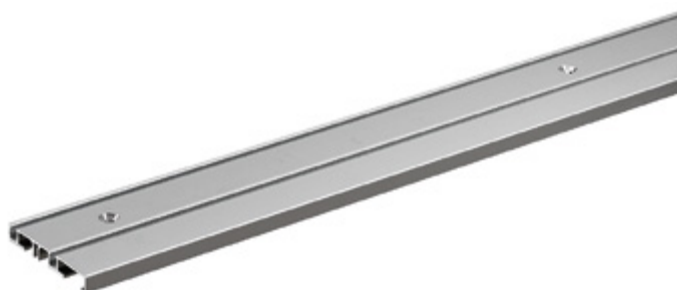

- ▶ 2-track runner profile with holes
- ▶ Screw on attachment
- ▶ Two runner profiles must be fitted per 2-door or 3-door cabinet
- ▶ Aluminium, silver anodized

Advice:

▶ Customised lengths are available on request

| Length mm | Order no. | PU |
|-----------|------------------|-----------|
| 2500 | 9 227 183 | 1/100 ea. |

1-track runner profile for pressing in



- ▶ 1-track runner profile
- ▶ For pressing into groove
- ▶ Four runner profiles must be fitted per 2-door or 3-door cabinet
- ▶ Aluminium, silver anodized

Advice:

▶ Customised lengths are available on request

| Length mm | Order no. | PU |
|-----------|------------------|-----------|
| 2500 | 9 227 188 | 1/100 ea. |
| 4000 | 9 239 329 | 1/100 ea. |



**TRADEMARK
HARDWARE**
WWW.TMHARDWARE.COM

Fixing screws

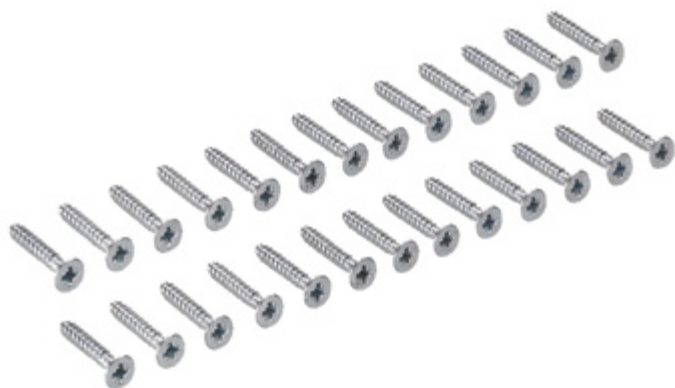

- ▶ For 2-track runner profile for invisible attachment in screw slot
- ▶ Fixing screws for max. shelf thicknesses of 16, 18 - 19 and 25 mm
- ▶ Galvanised steel
- ▶ One set of screws must be used for each profile set

Set comprises:
26 screws

| Shelf thickness mm | Order no. | PU |
|--------------------|-----------|-------|
| 16 | 9 229 240 | 1 set |
| 18 - 19 | 9 229 241 | 1 set |
| 25 | 9 229 243 | 1 set |

adhesive tape



- ▶ Double sided adhesive tape for gluing on 2-track runner profile
- ▶ 5 metres of adhesive tape must be used per runner profile in a length of 2,500 mm
- ▶ Using adhesive tape requires a suitable, cleaned surface
- ▶ Supplied on 25 m roll
- ▶ Easily shortened

| Length m | Order no. | PU |
|----------|-----------|---------|
| 25 | 9 227 006 | 1/4 ea. |

Mounting aid



- ▶ 2-track runner profile for screwing on in the screw slot / for gluing on
- ▶ Installation requires the use of 2 mounting aids

| Order no. | PU |
|-----------|---------|
| 9 229 154 | 1/4 ea. |

Screw on door stop / spacer



- ▶ 1 door application / spacer required for 2-door cabinet with a door height <1,000 mm
- ▶ 2 door stops / spacers are required for a 2-door with a door height >1,000 mm
- ▶ Plastic, grey

| Order no. | PU |
|-----------|-----------|
| 9 115 216 | 1/100 ea. |

Riaza handle profile



► Aluminium, anodised

| Length mm | Order no. | PU |
|-----------|------------------|----------|
| 295 | 9 208 097 | 1/30 ea. |
| 395 | 9 208 098 | 1/20 ea. |
| 445 | 9 208 099 | 1/20 ea. |
| 495 | 9 208 100 | 1/20 ea. |
| 595 | 9 208 101 | 1/20 ea. |
| 795 | 9 208 102 | 1/20 ea. |
| 895 | 9 208 103 | 1/20 ea. |

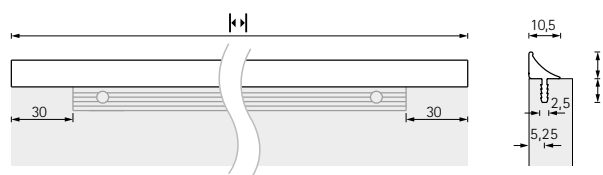

Ticinum handle profile

- Aluminium, anodised
- Drill hole spacing 8 x 224 mm
- Length or width 2000 mm

| Order no. | PU |
|-----------|----------|
| 9 131 455 | 1/12 ea. |

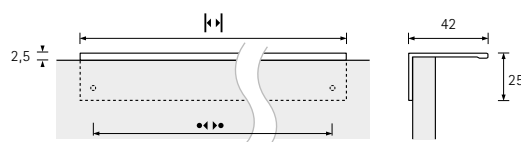

Sliding door system / bottom running

- ▶ SlideLine M / inset door position
- ▶ Planning dimensions



**TRADEMARK
HARDWARE**
WWW.TMHARDWARE.COM

Installing 2-track runner profile for screwing on / gluing on

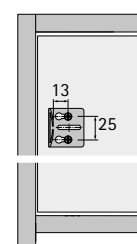
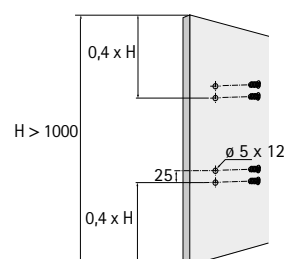
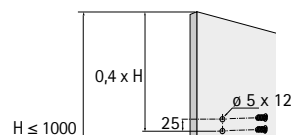
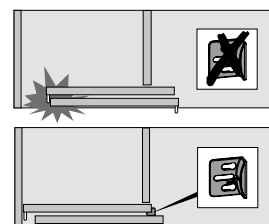
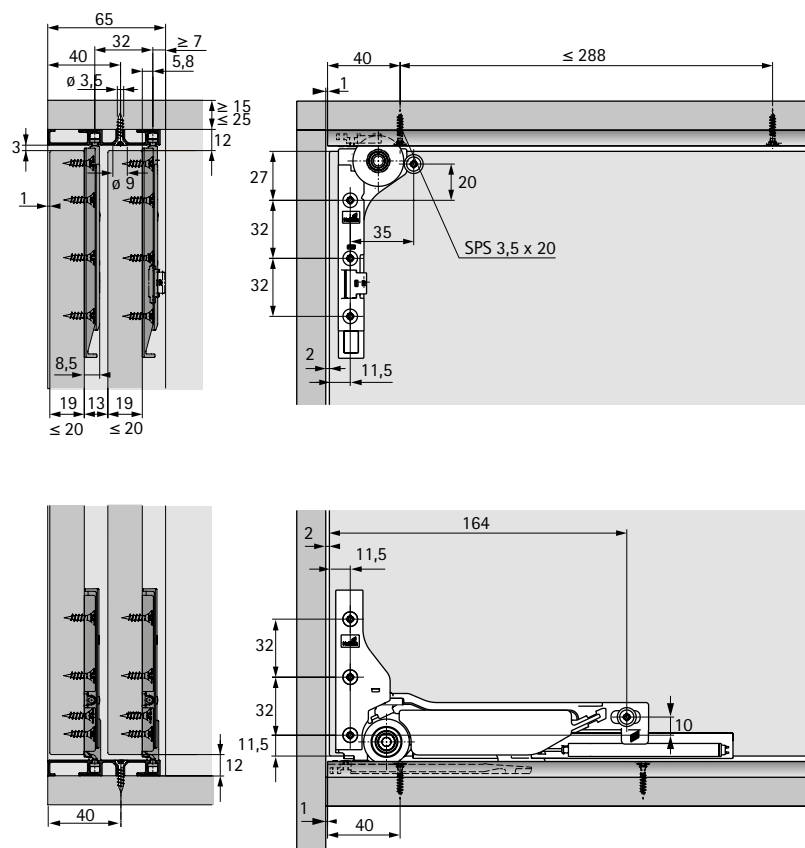

$\frac{1}{2} \geq 7,3$ / $\frac{1}{2} \geq 7,3$
 $\frac{1}{2} \geq 6,3 \times 12,5$ / $\frac{1}{2} \geq 3,5 \times 12$

Installing 1-track runner profile for pressing in

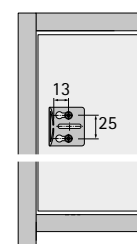
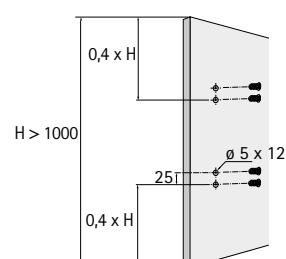
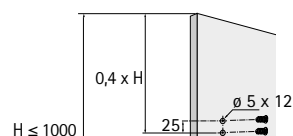
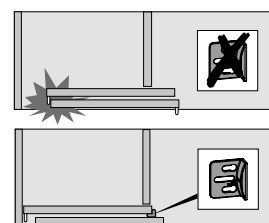
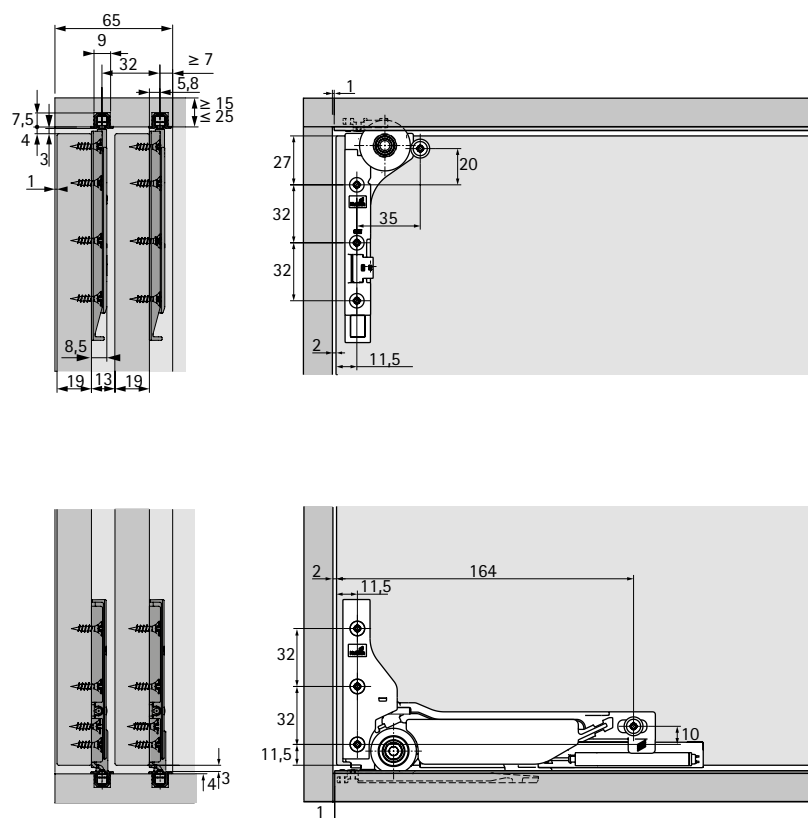

$\frac{1}{2} \geq 7,3$ / $\frac{1}{2} \geq 7,3$
 $\frac{1}{2} \geq 6,3 \times 12,5$ / $\frac{1}{2} \geq 3,5 \times 12$

Installing activators and end stops in the runner profile

Silent System: ☒

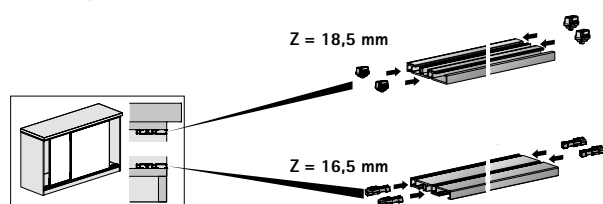

Silent System: ☒

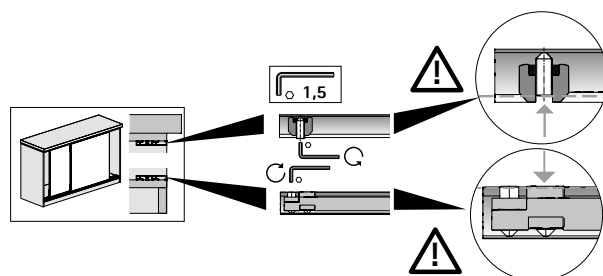
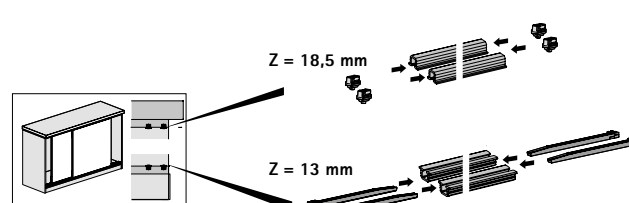
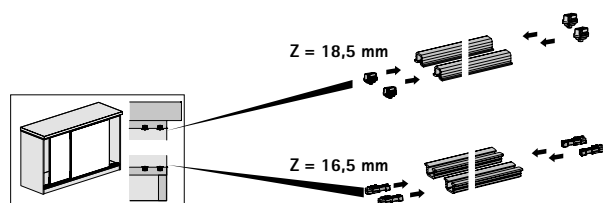
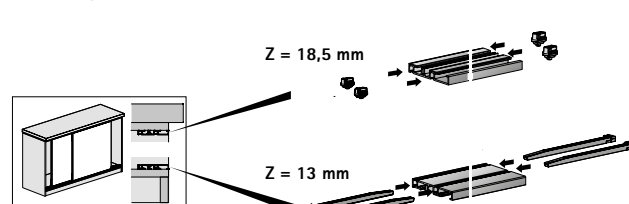

Installing 2-track runner profile for screwing on in the screw slot

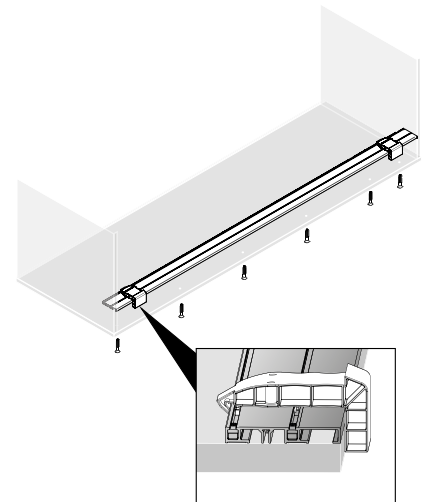
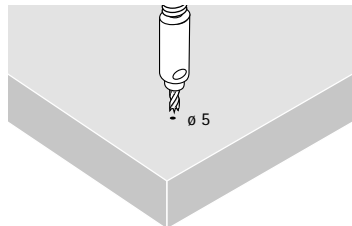
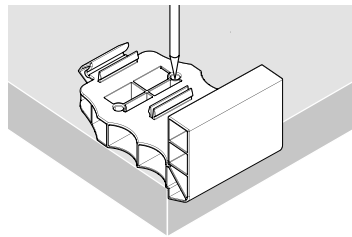
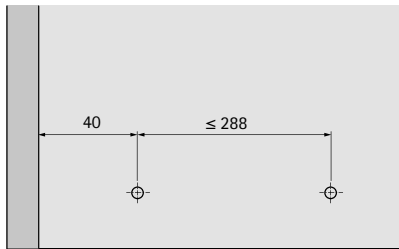

Installing 2-track runner profile for screwing on

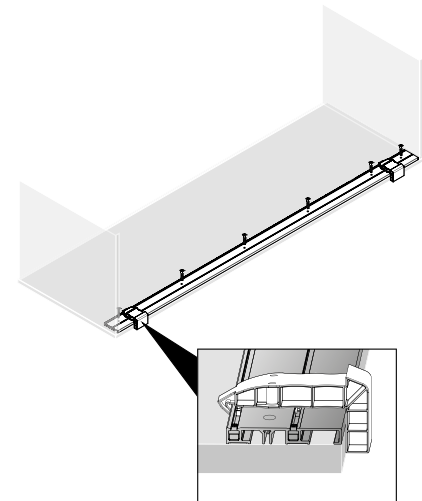
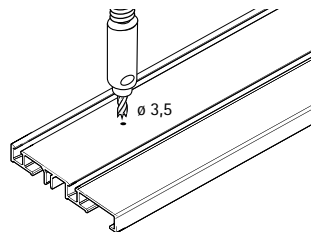
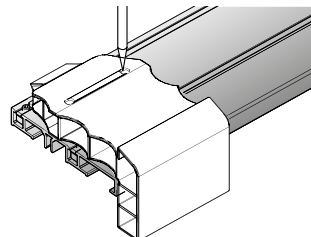
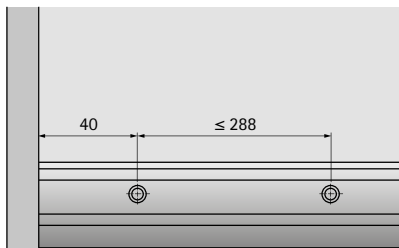

Installing 2-track runner profile for gluing on

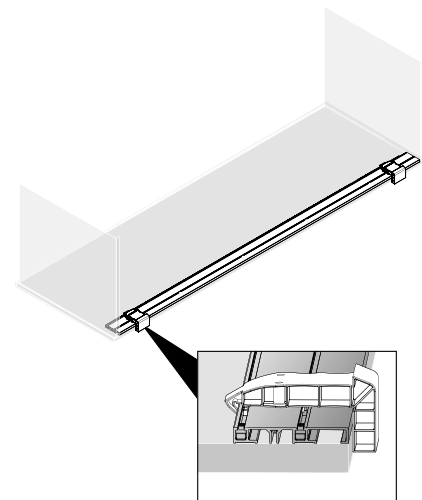
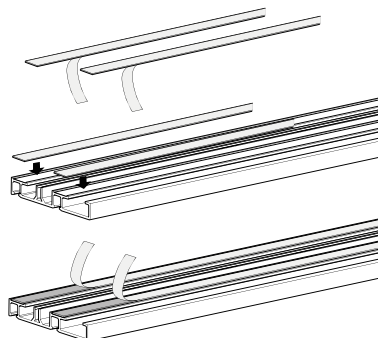
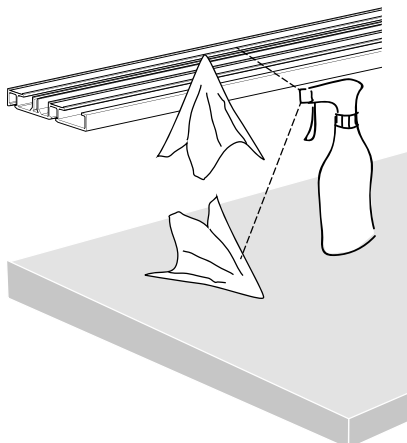

- ▶ SlideLine M / inset door position
- ▶ Installation



Installing 1-track runner profile for pressing in

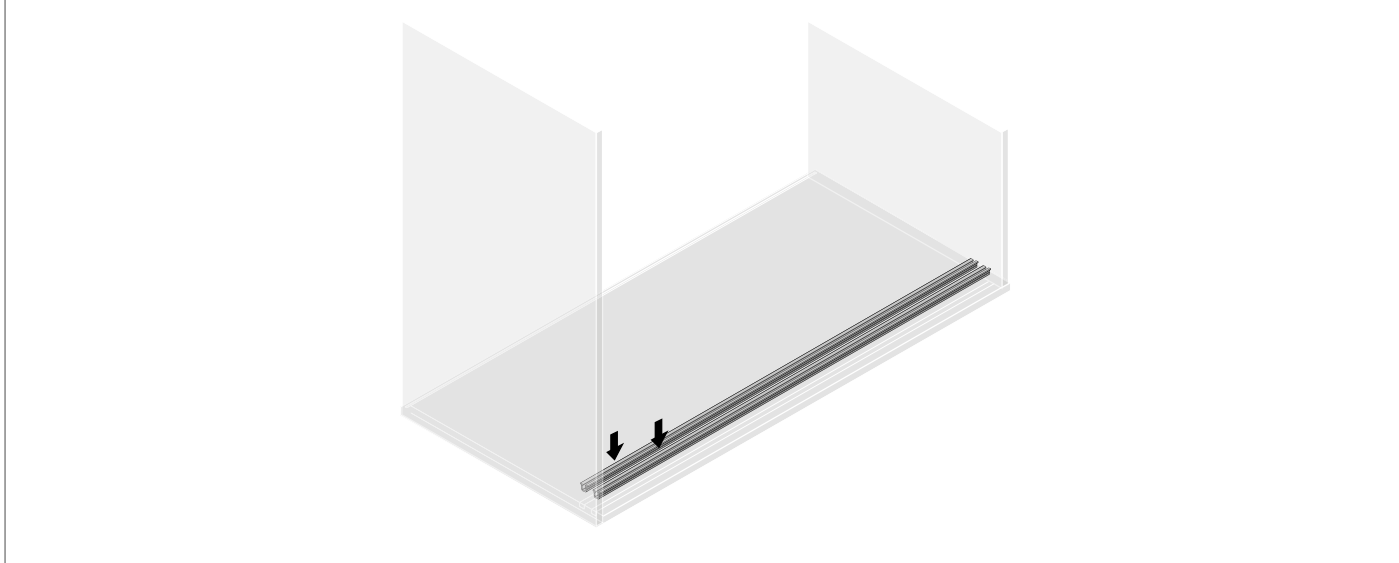

Installing the fitting and upgrade sets

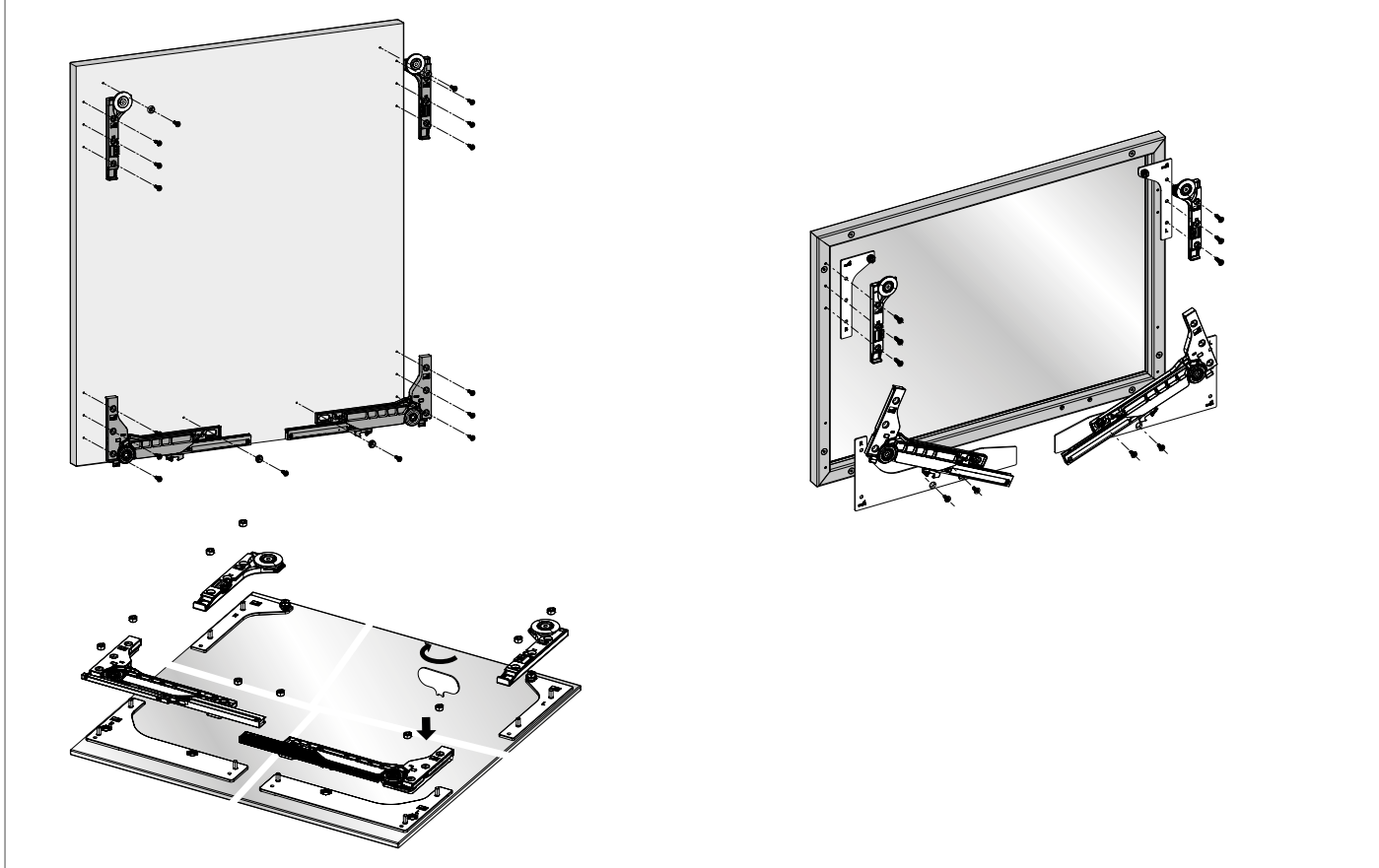

Installation the doors

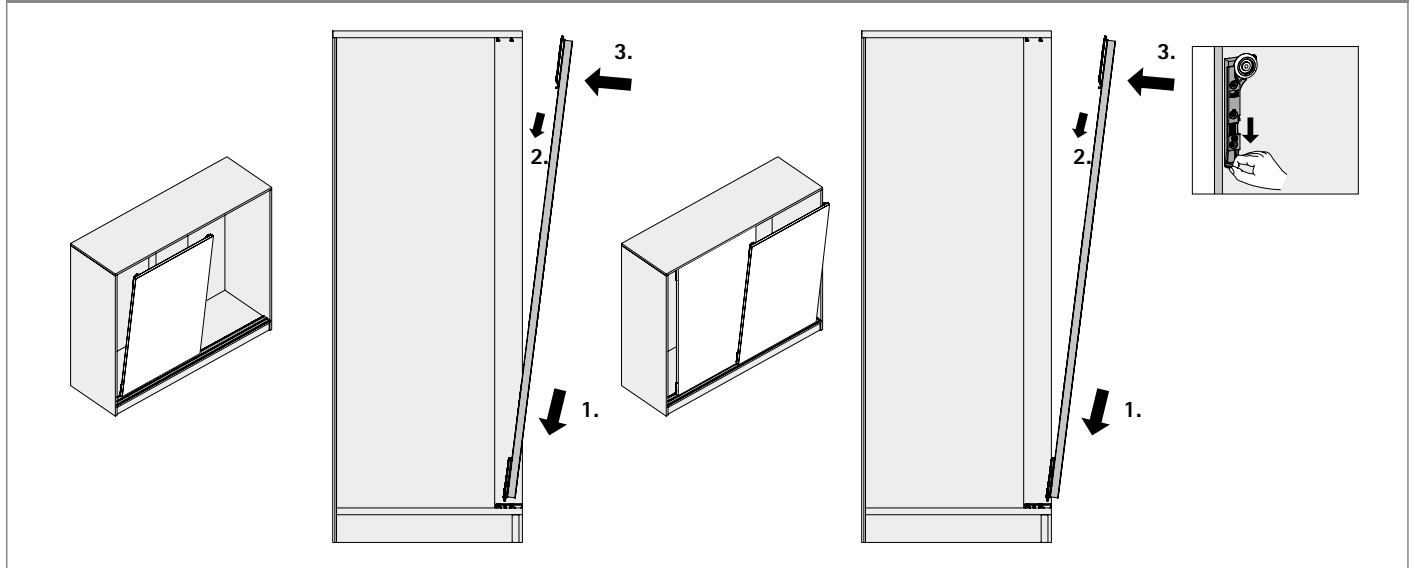

Aligning doors

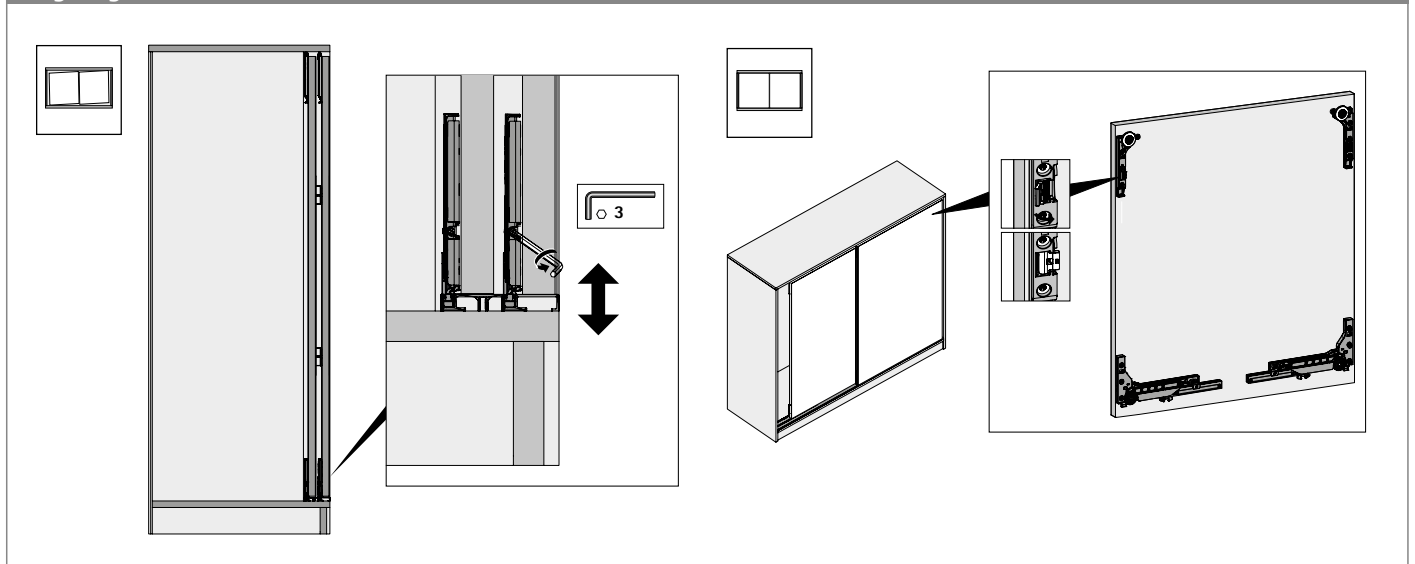

Installing spacer

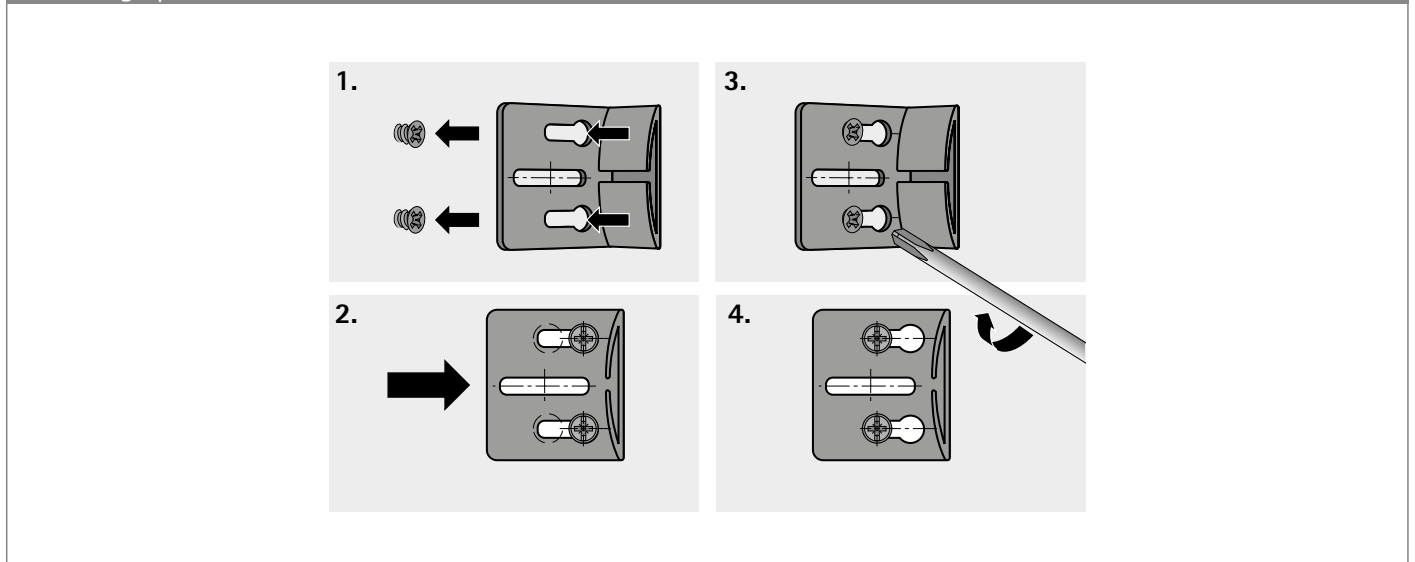



Weight table for chipboard 19 mm

Door weight in kg (density = 700 kg/m³)

| Door height mm | Door width mm | | | | | | | | | | | | | | |
|----------------|---------------|------|------|------|------|------|------|------|------|------|------|------|------|------|------|
| | 300 | 400 | 500 | 600 | 700 | 800 | 900 | 1000 | 1100 | 1200 | 1300 | 1400 | 1600 | 1800 | 2000 |
| 300 | 1,2 | 1,6 | 2,0 | 2,4 | 2,8 | 3,2 | 3,6 | 4,0 | 4,4 | 4,8 | 5,2 | 5,6 | 6,4 | 7,2 | 8,0 |
| 400 | 1,6 | 2,1 | 2,7 | 3,2 | 3,7 | 4,3 | 4,8 | 5,3 | 5,9 | 6,4 | 6,9 | 7,5 | 8,5 | 9,6 | 10,6 |
| 500 | 2,0 | 2,7 | 3,3 | 4,0 | 4,7 | 5,3 | 6,0 | 6,7 | 7,3 | 8,0 | 8,7 | 9,3 | 10,6 | 12,0 | 13,3 |
| 600 | 2,4 | 3,2 | 4,0 | 4,8 | 5,6 | 6,4 | 7,2 | 8,0 | 8,8 | 9,6 | 10,4 | 11,2 | 12,8 | 14,4 | 16,0 |
| 700 | 2,8 | 3,7 | 4,7 | 5,6 | 6,6 | 7,5 | 8,4 | 9,3 | 10,2 | 11,2 | 12,1 | 13,0 | 14,9 | 16,8 | 18,6 |
| 800 | 3,2 | 4,3 | 5,3 | 6,4 | 7,5 | 8,5 | 9,6 | 10,6 | 11,7 | 12,8 | 13,8 | 14,9 | 17,0 | 19,2 | 21,3 |
| 900 | 3,6 | 4,8 | 6,0 | 7,2 | 8,4 | 9,6 | 10,8 | 12,0 | 13,2 | 14,4 | 15,6 | 16,8 | 19,2 | 21,6 | 23,9 |
| 1000 | 4,0 | 5,3 | 6,7 | 8,0 | 9,3 | 10,7 | 12,0 | 13,3 | 14,6 | 16,0 | 17,3 | 18,6 | 21,3 | 23,9 | 26,6 |
| 1100 | 4,4 | 5,9 | 7,3 | 8,8 | 10,2 | 11,7 | 13,2 | 14,6 | 16,1 | 17,6 | 19,0 | 20,5 | 23,4 | 26,3 | 29,3 |
| 1200 | 4,8 | 6,4 | 8,0 | 9,6 | 11,2 | 12,8 | 14,4 | 16,0 | 17,6 | 19,2 | 20,8 | 22,3 | 25,5 | 28,7 | 31,9 |
| 1300 | 5,2 | 6,9 | 8,7 | 10,4 | 12,1 | 13,8 | 15,6 | 17,3 | 19,0 | 20,8 | 22,5 | 24,2 | 27,7 | 31,1 | 34,6 |
| 1400 | 5,6 | 7,5 | 9,3 | 11,2 | 13,0 | 14,9 | 16,8 | 18,6 | 20,5 | 22,3 | 24,2 | 26,1 | 29,8 | 33,5 | 37,2 |
| 1600 | 6,4 | 8,5 | 10,7 | 12,8 | 15,0 | 17,0 | 19,2 | 21,3 | 23,4 | 25,6 | 27,7 | 29,8 | 34,1 | 38,3 | 42,6 |
| 1800 | 7,2 | 9,6 | 12,0 | 14,4 | 16,8 | 19,2 | 21,6 | 24,0 | 26,3 | 28,7 | 31,1 | 33,5 | 38,3 | 43,1 | 47,9 |
| 2000 | 8,0 | 10,6 | 13,3 | 16,0 | 18,6 | 21,3 | 23,9 | 26,6 | 29,3 | 31,9 | 34,6 | 37,2 | 42,6 | 47,9 | 53,2 |
| 2200 | 8,8 | 11,7 | 14,6 | 17,6 | 20,5 | 23,4 | 26,3 | 29,3 | 32,2 | 35,1 | 38,0 | 41,0 | 46,8 | 52,7 | 58,5 |
| 2400 | 9,6 | 12,8 | 16,0 | 19,2 | 22,3 | 25,5 | 28,7 | 31,9 | 35,1 | 38,3 | 41,5 | 44,7 | 51,1 | 57,5 | 63,9 |
| 2600 | 10,4 | 13,8 | 17,3 | 20,8 | 24,2 | 27,7 | 31,1 | 34,6 | 38,0 | 41,5 | 45,0 | 48,4 | 55,3 | 62,2 | 69,2 |

Weight table for MDF 19 mm

Door weight in kg (density = 900 kg/m³)

| Door height mm | Door width mm | | | | | | | | | | | | | | |
|----------------|---------------|------|------|------|------|------|------|------|------|------|------|------|------|------|------|
| | 300 | 400 | 500 | 600 | 700 | 800 | 900 | 1000 | 1100 | 1200 | 1300 | 1400 | 1600 | 1800 | 2000 |
| 300 | 1,5 | 2,1 | 2,6 | 3,1 | 3,6 | 4,1 | 4,6 | 5,1 | 5,6 | 6,2 | 6,7 | 7,2 | 8,2 | 9,2 | 10,3 |
| 400 | 2,1 | 2,7 | 3,4 | 4,1 | 4,8 | 5,5 | 6,2 | 6,8 | 7,5 | 8,2 | 8,9 | 9,6 | 10,9 | 12,3 | 13,7 |
| 500 | 2,6 | 3,4 | 4,3 | 5,1 | 6,0 | 6,8 | 7,7 | 8,6 | 9,4 | 10,3 | 11,1 | 12,0 | 13,7 | 15,4 | 17,1 |
| 600 | 3,1 | 4,1 | 5,1 | 6,2 | 7,2 | 8,2 | 9,2 | 10,3 | 11,3 | 12,3 | 13,3 | 14,4 | 16,4 | 18,5 | 20,5 |
| 700 | 3,6 | 4,8 | 6,0 | 7,2 | 8,4 | 9,6 | 10,8 | 12,0 | 13,2 | 14,4 | 15,6 | 16,8 | 19,2 | 21,6 | 23,9 |
| 800 | 4,1 | 5,5 | 6,8 | 8,2 | 9,6 | 10,9 | 12,3 | 13,7 | 15,1 | 16,4 | 17,8 | 19,2 | 21,9 | 24,6 | 27,4 |
| 900 | 4,6 | 6,2 | 7,7 | 9,2 | 10,8 | 12,3 | 13,9 | 15,4 | 16,9 | 18,5 | 20,0 | 21,6 | 24,6 | 27,7 | 30,8 |
| 1000 | 5,1 | 6,8 | 8,6 | 10,3 | 12,0 | 13,7 | 15,4 | 17,1 | 18,8 | 20,5 | 22,2 | 23,9 | 27,4 | 30,8 | 34,2 |
| 1100 | 5,6 | 7,5 | 9,4 | 11,3 | 13,2 | 15,1 | 16,9 | 18,8 | 20,7 | 22,6 | 24,5 | 26,3 | 30,1 | 32,9 | 37,6 |
| 1200 | 6,2 | 8,2 | 10,3 | 12,3 | 14,4 | 16,4 | 18,5 | 20,5 | 22,6 | 24,6 | 26,7 | 28,7 | 32,8 | 36,9 | 41,0 |
| 1300 | 6,7 | 8,9 | 11,1 | 13,3 | 15,6 | 17,8 | 20,0 | 22,2 | 24,5 | 26,7 | 28,9 | 31,1 | 35,6 | 40,0 | 44,5 |
| 1400 | 7,2 | 9,6 | 12,0 | 14,4 | 16,8 | 19,2 | 21,6 | 23,9 | 26,3 | 28,7 | 31,1 | 33,5 | 38,3 | 43,1 | 47,9 |
| 1600 | 8,2 | 10,9 | 13,7 | 16,4 | 19,2 | 21,9 | 24,6 | 27,4 | 30,1 | 32,8 | 35,6 | 38,3 | 43,8 | 49,3 | 54,7 |
| 1800 | 9,2 | 12,3 | 15,4 | 18,5 | 21,6 | 24,6 | 27,7 | 30,8 | 33,9 | 36,9 | 40,0 | 43,1 | 49,3 | 55,4 | 61,6 |
| 2000 | 10,3 | 13,7 | 17,1 | 20,5 | 23,9 | 27,4 | 30,8 | 34,2 | 37,6 | 41,0 | 44,5 | 47,9 | 54,7 | 61,6 | 68,4 |
| 2200 | 11,3 | 15,5 | 18,8 | 22,6 | 26,3 | 30,1 | 33,9 | 37,6 | 41,4 | 45,1 | 48,9 | 52,7 | 60,2 | 67,7 | 75,2 |
| 2400 | 12,3 | 16,4 | 20,5 | 24,6 | 28,7 | 32,8 | 36,9 | 41,0 | 45,1 | 49,3 | 53,4 | 57,5 | 65,7 | 73,9 | 82,1 |
| 2600 | 13,3 | 17,8 | 22,2 | 26,7 | 31,1 | 35,6 | 40,0 | 44,5 | 48,9 | 53,4 | 57,8 | 62,2 | 71,1 | 80,0 | 88,9 |



Adjustment to different material thicknesses

The table entries refer to 19 mm thick material.
The table entries must be multiplied by a factor in order to adjust to material of different thickness.

| Material thickness mm | Factor |
|-----------------------|--------|
| 15 | 0,79 |
| 16 | 0,84 |
| 18 | 0,95 |
| 19 | 1,00 |
| 20 | 1,05 |
| 22 | 1,16 |
| 23 | 1,21 |
| 26 | 1,37 |
| 29 | 1,53 |

Formula for conversion

Door weight = weight for door in thickness of 19 mm from table above x factor

Example

Chipboard door

H x W x D = 2000 x 1800 x 16

Weight shown in table for this door size, but material in a thickness of 19 mm = 47.9 kg

Convert to 16 mm door thickness using factor of 0.84 as shown in table on left

Door weight = 47.9 kg x 0.84 = 40.2 kg

Calculating weights of doors in alternative door materials

Density of various materials in kg/m³

| Material | Density kg/m ³ |
|-----------------------|---------------------------|
| Acrylic glass | 1200 |
| Aluminium | 2700 |
| Balsa wood | 120 |
| Concrete | 2400 |
| Lead | 11300 |
| Iron | 7800 |
| Gypsum plasterboard | 900 |
| Glass | 2600 |
| Hardboard | 1000 |
| Hardwood, wet (beech) | 900 |
| Hardwood, dry (beech) | 800 |
| Cork | 300 |

To calculate the weight of doors in alternative door materials, the specific density of the door material must be taken into consideration.

Example

Door made of acrylic glass with a density of 1200 kg/m³

Door height: 2000 mm, door width: 1800 mm, material thickness: 6 mm

$$\begin{array}{c} \text{Door weight [kg]} \\ 25,9 \text{ kg} \end{array} = \begin{array}{c} \text{Height [m]} \\ 2 \end{array} \times \begin{array}{c} \text{Width [m]} \\ 1,8 \end{array} \times \begin{array}{c} \text{Material thickness [m]} \\ 0,006 \end{array} \times \begin{array}{c} \text{Density [kg/m}^3\text{]} \\ 1200 \end{array}$$

Always the best system

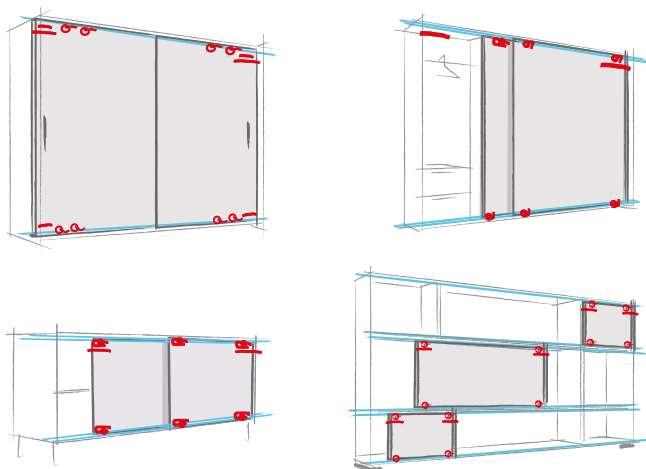

Hettich sliding door systems give you the ideal solution to meet any consumer demand, because Hettich offers you numerous system options. Each design provides its own particular benefits and creative impact on the piece of furniture. Take advantage of Hettich sliding door systems for all cabinets and shelf units. We are now going to give you a brief introduction to the various systems, so you can quickly find the main criteria for selecting the right sliding door system.

Option 1: 1-track or multi-track sliding doors



1-track sliding doors do not close off furniture completely. The door only conceals individual furniture segments and can be pushed to the side. Typical application: the living room combination in which the TV set disappears behind the sliding door after use.



Multi-track sliding doors can close off the entire furniture carcass. At least two doors run in profiles installed one behind the other. Ideal for office cabinets, wardrobes and pantry units: the closed doors conceal the cabinet's entire contents, creating a neat and tidy look in a matter of seconds.



Flush fitted sliding doors are a special innovative type that also close off the complete carcass. The closed cabinet front panel forms an absolutely flat surface, reducing reveals to a minimum. An option for the most exacting demands on design. The doors run in a single track; on opening, however, a special mechanism automatically allows them to run one behind the other.

Option 2: overlay or inset sliding doors

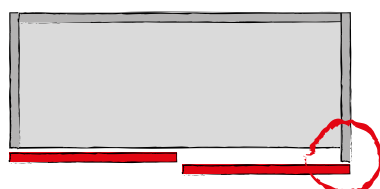

Overlay sliding doors conceal – viewed from the front – the carcass side, the top panel and bottom panel. This makes the front panels the dominant design element of a piece of furniture. Please note: for furniture designed with two doors, the two carcass sides must be produced in different depths.



Inset sliding doors, in contrast, move between the carcass sides, the top panel and the bottom panel. The carcass elements are visible from the front, also influencing the design of furniture. The carcass sides are of identical depth.

Option 3: bottom running or top running sliding doors

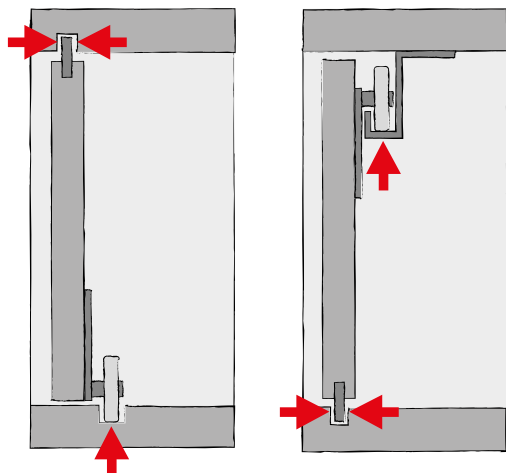

Bottom running sliding doors stand on rollers along their bottom edge and are stabilised by a guide at the top edge of the door. Given the uncomplicated carcass construction, predominantly low door weights and straightforward installation, bottom running doors are seen as the optimum gateway to constructing sliding door cabinets.

Top running sliding doors are suspended from the top panel. A guide at the bottom panel prevents the doors from wobbling. The fitting components can be positioned unobtrusively at the top and bottom panel – for furniture designed with a look of harmony. Top running sliding doors are ideal for heavy doors, e.g. in large wardrobes.

Option 4: installing sliding doors on or in front of the top panel

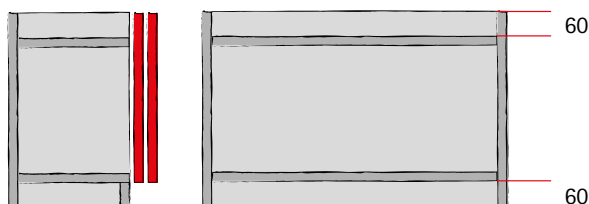

With a simple trick, the fitting technology can be installed largely **out of view on the top panel**: the top panel is lowered by 60 mm. Proviso: the piece of furniture is a tall cabinet with a top panel that is positioned out of sight.

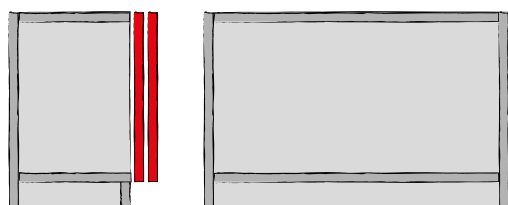

On low cabinets, the top panel is always visible. In this case, carcass and top panel are conventionally mounted at right angles and the fitting technology is either attached **in front of or in the top or bottom panel**. The doors close flush at the top – a neat looking solution. Incidentally: the cabinet here is designed in the same way as hinged door cabinets. Benefit: subsequent conversion from hinged door to sliding door system can be done with little effort.

Option 5: sliding door format and material

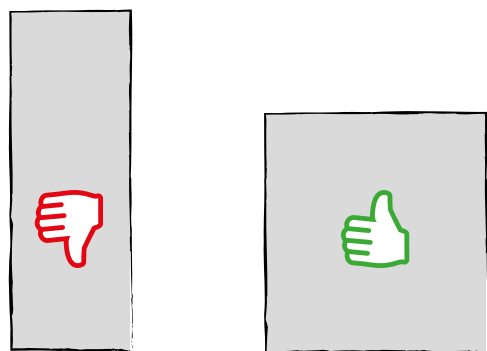

Key to selecting the appropriate system: format and material of the sliding door. In terms of format, bear in mind that wider doors run far more stably than narrow, tall sliding doors. Rule of thumb: the sliding door width should be at least half the height of the door.

Definition of important dimensions

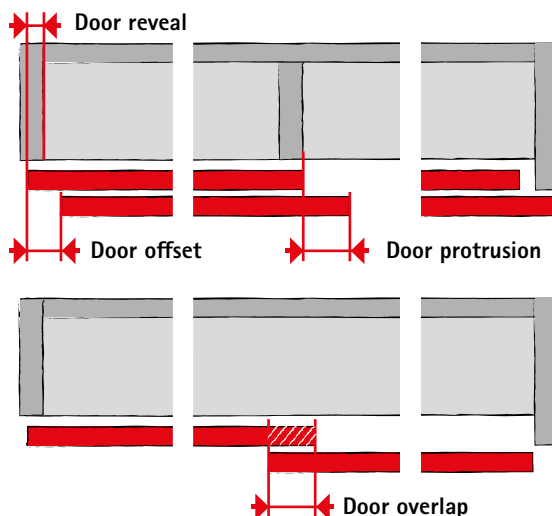

The **door reveal** is the extent to which the door overlaps the carcass side.

The **door protrusion** is the measure of opened door offset to the centre panel.

The **door offset** prevents the forward door from knocking against the handle on the rear door.

Door overlap is the surface of the rear most door that is permanently covered by the front most door. The overlap should be approx. twice as large as the gap between front most door and rear most door to avoid being able to see inside the cabinet through the gap. On aluminium framed doors, frame width is often taken as the overlap. This positions the upright frame sections of the front most door and rear most door exactly in front of one another down the middle of the cabinet.

Door reveal as a variable influencing door protrusion

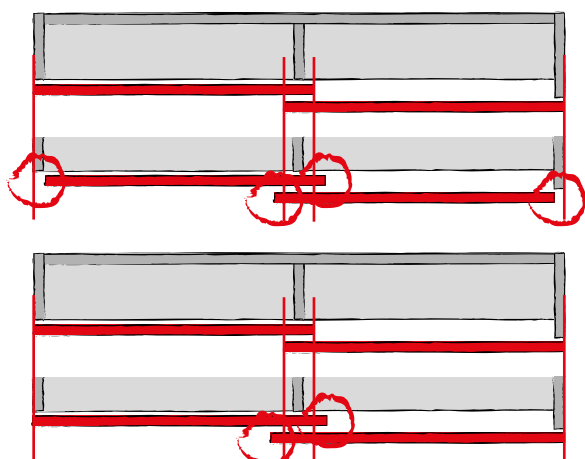

Reducing the door reveal increases the door protrusion on doors of identical width.

Increasing the door overlap on account of a larger door increases the door protrusion.

The centre panel as a variable influencing door protrusion

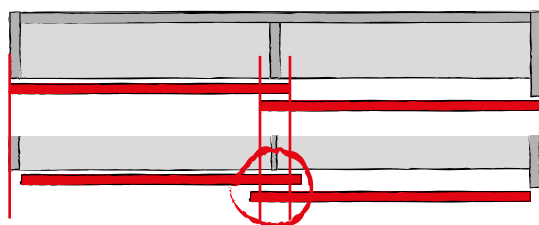

A thinner centre panel increases the door protrusion on doors of identical width.

Design with flush opening doors

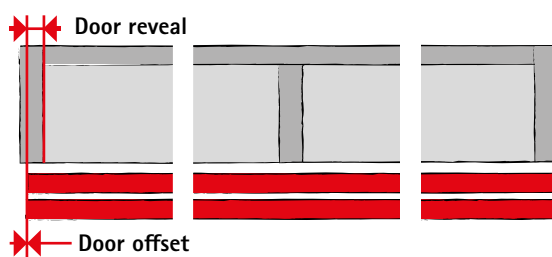

The rear door must produce the same door reveal as the forward door. It must be noted here that this requires the use of special profiles.

Quality that meets all the demands

The quality of the sliding door systems is monitored continuously. Hettich fittings comply with the national and international quality standards of the markets our customers operate in. The diagrams below show some of the tests to which Hettich fittings are subjected.

Load capacity

The values stated in the catalogue for Hettich sliding door systems comprise the permissible total weight of the door in combination with the permitted door sizes. All Hettich sliding door systems pass the overload test to EN 15706¹. The sliding door systems are suitable for furniture to EN 14749 when processed correctly as specified in the catalogue.

Corrosion test

Hettich sliding door systems satisfy the requirements on corrosion defined in EN 15706, 72-hour condensation-water test to EN 6270.

¹ TopLine 1200 / 1210 / 1230 meets the requirements of ANSI / BHMA

Endurance test

The door must withstand a defined number of opening and closing cycles at a defined speed.

Level 1: 10,000 cycles

Level 2: 20,000 cycles

Level 3: 40,000 cycles

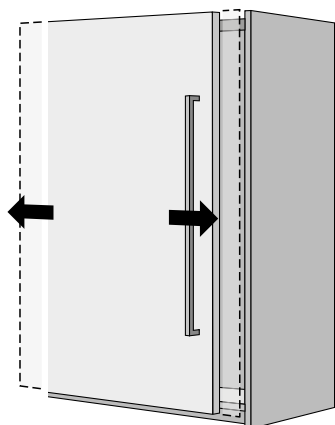

Lift off guard

The door is pulled up and forwards at an angle with a defined force and must not become detached or fall out of the cabinet

Level 1: 150 N

Level 2: 200 N

Level 3: 250 N

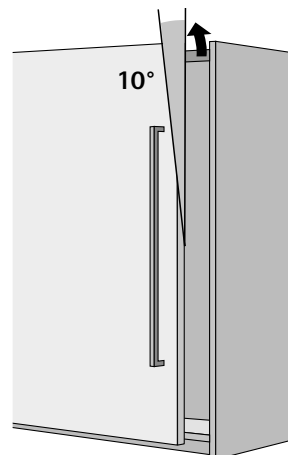

Closing test

The door must withstand a specific number of closing cycles under a defined tensile load.

Level 1: 2 kg

Level 2: 3 kg

Level 3: 4 kg

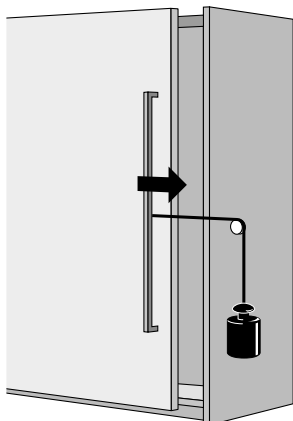

Horizontal safety test

Pressure is applied to the middle of the door with a defined force. The door must not become detached or fall out of the carcass.

Level 1: 150 N

Level 2: 200 N

Level 3: 250 N

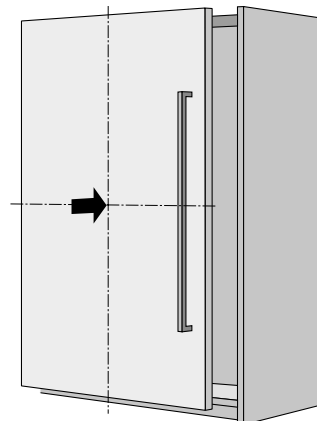

We are improving our environmental performance –
as proven by EMAS, the world's most stringent environmental management system.

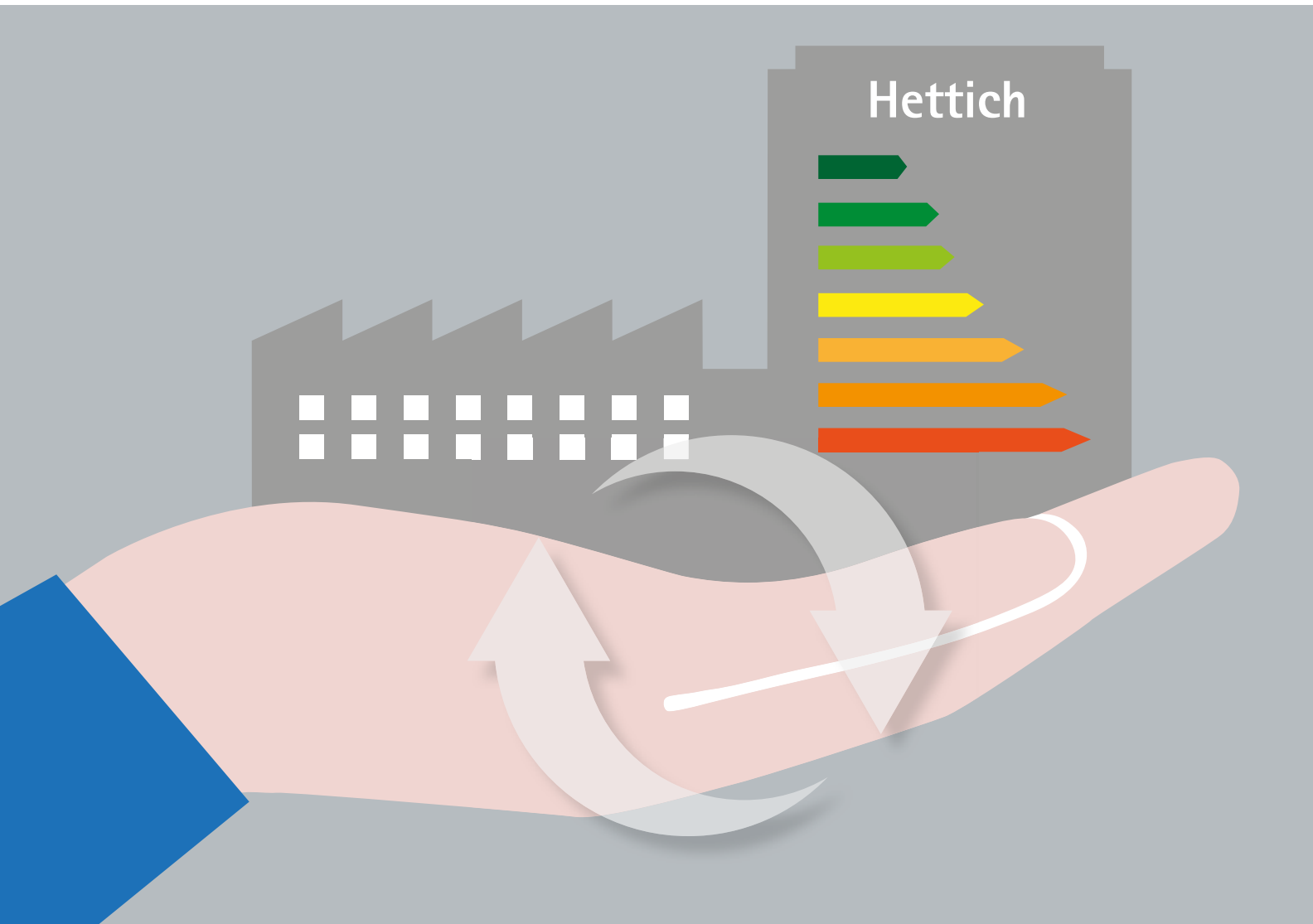

Our corporate principles include taking responsibility for preserving the natural basis of life. This is where we regard statutory provisions as minimum requirements. Over and above meeting statutory requirements, it is imperative for all members of staff to act in a way that conserves energy and resources in their own particular work environment in order to overcome the global ecological challenges of the near future. In the same way, using energy and resources efficiently also plays a key part in maintaining our competitive edge.

The group wide Environmental Department was established back in 1992, with its sustainability principles of environmental protection and occupational health and safety having consistently set the framework for leading the company group forward in this direction since 1993. Introduced in 1996, the environmental management systems complying with the European EMAS Regulation (Eco Management and Audit Scheme), including ISO 14.001, are of central impor-

tance in this context. These implemented a targeted approach to identifying and realising the potentials for using energy and resources in an efficient manner as well as to ensuring conformity with the law. The results are nothing short of impressive.

Environmentally friendly projects

Innovative projects are the mark of our approach to environmental management. For instance, the primary-energy requirement of our new production facilities is up to 75% below the specifications demanded in building legislation. The exemplary, consistent use of wood-based materials in constructing our commercial buildings puts us on the forefront of using resource-conserving, renewable building materials that take enormous quantities of climate-damaging CO₂ out of the atmosphere while they are growing.

Since 2015, we have been trying out three new vehicles, each employing different propulsion systems, to test the



practical suitability of electric mobility in a variety of usage situations. At our Indian production plant, heavy metals are absorbed from concentrated waste water using an innovative method that involves living algae. At our factory in China, a solar-powered system provides staff accommodation and the canteen with hot water.

Success stories

Between 1997 and 2015, for example, we have managed to reduce environmental pollution from manufacturing our drawer runners and drawer systems at the Kirchleugern-Bünde production facility as follows:

| | |
|-------------------------------------|------|
| ► Specific water consumption | 45 % |
| ► Specific power consumption | 10 % |
| ► Specific heat consumption | 73 % |
| ► Specific CO ₂ emission | 30 % |

Numerous awards reflect our commitment to the environment. In 2009, the European Commission gave our zero-energy Hettich Forum building the Green Building Award at national level. In 2016, we won the sustainability prize from the East Westphalian Business Environment Foundation for an environment education project carried out over 20 years.

Technik für Möbel



www.hettich.com

Technik für Möbel



Hettich