

**TRADEMARK
HARDWARE**
WWW.TMHARDWARE.COM

Vision Frames

| <u>Model</u> | <u>Description</u> | <u>Page</u> |
|------------------------|---|--------------------|
| | Vision Lites General Information | |
| PAK™ | Complete Vision Lite with Glazing & Tape Applied, Individually Packaged | V1 |
| VSL™ SLIMLINE™ | Low Profile Beveled Vision Frame | V2 |
| SLR™ | Round Low Profile Beveled Vision Frame | V2 |
| WOODLITE™ | Low Profile Beveled Vision Frame with Wood Veneer Covering | V2 |
| VSIG™ | Low Profile For Glass 1/4" to 1 11/16" Thick and Door up to 3" Thick | V3 |
| VLF-EZ™ | Beveled Vision Frame With 3/16" Return | V4 |
| VLF-EZ-IG™ | Vision Frame For Glass Up To 1 11/16" Thick and Door up to 3" Thick | V5 |
| VLF™ | Square Return Vision Frame With Thru Bolt Installation | V6 |
| VLF-IG™ | Vision Frame For Glass Up To 1-11/16" Thick and Door Up To 3" Thick | V7 |
| VLF-DG™ | Vision Frame For 2 Lites Of Glass | V8 |
| STANDARD SHAPES | Round, Half Round & Radius Vision VLF Frame | V9 |
| MULLIONS | Vision Frames With Mullions For French Door Look | V10 |
| MULLIONS | Mullions for Transoms & Sidelites — FRM | V11 |
| CUSTOM SHAPES | Vision Frames With Custom Shapes | V12 |
| VLF-S10™ | Security Vision Frame With or Without Speaker Panel | V13 |
| VLF-SG™ | Security Vision Frame with Security Grille | V14 |
| VLFIGHRC PAK™ | Hurricane Vision Frame PAK | V15 |
| VLFEZHRC PAK™ | Hurricane Vision Frame PAK | V16 |
| VLFIGHRC-F PAK™ | Hurricane and Fire-Rated Vision Frame PAK | V17 |

NEW—VELO PRIVACY SCREEN ADDS PRIVACY TO ANY MODEL VISION LITE
[View Webpage](#) or See [Separate Section on Privacy Options for Vision Lites](#)



© Activar Construction Products Group, Inc 2016

ALPDS1612

800-554-6077



FIND THE MOST CURRENT PRODUCT INFORMATION AT ACTIVARCPG.COM/AIR-LOUVERS

VISION LITES GENERAL INFORMATION REV B

MADE IN USA

All vision lites are manufactured in the USA.

QUICK SHIP

Many models of Vision Lites are available in one or more of our **10 stocking locations** in Lancaster PA, Bloomington MN, Commerce CA, Atlanta GA, Seattle WA, Fort Myers FL, Dallas TX, Omaha NE, Fargo ND or Chicago IL. [Check the Stock list at WWW.ACTIVARCPG.COM/AIR-LOUVERS](http://WWW.ACTIVARCPG.COM/AIR-LOUVERS) for the most current listing.

CUSTOM ORDERS & SPECIAL SIZES

Because we design and manufacture our own lites & louvers in our California and Minnesota facilities, we can help you with special requests including non-standard sizes, special finishes or custom colors, and fitting non-standard doors. Call Customer Service to find out more.

MATERIAL

All vision frames are fabricated from cold rolled steel unless otherwise noted. See specific model for respective gauge.

CONSTRUCTION

All vision frames have mitered and flush welded corners with a continuous, glass retainer and countersunk mounting holes.

FASTENERS

All models have pre-punched, countersunk holes for Phillips head sheet metal screws (provided with each vision frame). All screw and bolt heads match finish. Vandal or tamper-proof such as Torx head fasteners are available as well as other specialty fasteners.



FINISH

Standard finish for most steel vision lites is a powder-coat mineral bronze unless otherwise noted. Air Louvers offers **many more powder coat finishes at no additional charge for most models**. Powder coating provides complete coverage inside and out, assuring that your vision frame will provide durable service for years. Powder coating generates no VOC's during the process or after installation. Specify optional colors at the time of order. Other finishes and materials such as stainless steel and galvanized and custom color matching are available - contact Customer Service. Touch up paint available for most colors. [View Color Samples Online](#)

GLAZING

Air Louvers carries a wide selection of fire & safety-rated glazing choices to fit our vision frames. Glazing to fit each frame is noted on the product data page.

SIZES

All vision lites are made in commonly-ordered sizes to fit most door applications. The most popular model and sizes are carried in stock for immediate shipment from the factory - See our [Warehouse Stock List](#). Dimensions are always given with width first and height second. Order dimensions should represent the size of the cut-out opening in the door.

PACKAGING

Vision frames may be packaged individually or grouped in a box. Each package is marked with the respective model and size designation. Multiple unit orders may be shipped in corrugated cartons or wooden crates (on special order).

LISTING & MARKING

Each vision frame that is fire-rated carries a permanent marking with the manufacturer, rating and listing agency. **UL10B installations** do not require fire-rated glazing tape to achieve the listing, however we recommend that a PVC glazing tape be applied to both sides of glass to avoid glass to metal contact which may result in breakage.

Most vision frames have been tested and **Listed for UL 10C** and Criteria of UBC 7-2 Positive Pressure. Additional fire-rated intumescent glazing tape may be required to meet those requirements. Please request at the time of order & see detailed installation instructions [for each model](#).



GLAZING TAPE—SEE INSTALLATION INSTRUCTIONS

GTAPE2000B: Black medium density closed cell PVC glazing tape with adhesive backing - 1/16" x 3/8" x 200'

GTAPE1/8-75B: Black medium density closed cell PVC glazing tape with adhesive backing—1/8" x 3/8" x 75'

- Required only for UL10C installation instruction in USL 20 min. wood doors with a UL Label

FGS4590-7: Fire-rated intumescent tape with adhesive backing for Positive Pressure-Listed Doors - 7'

FGS4590-8: Fire-rated intumescent tape with adhesive backing for Positive Pressure-Listed Doors - 8'

Due to possible changes in the industry and manufacturing techniques, we reserve the right to modify any product without prior notification.

FIND THE MOST CURRENT PRODUCT INFORMATION AT WWW.ACTIVARCPG.COM/AIR-LOUVERS

PAK™ OPTION: PACKAGED KIT, GLAZING & TAPE APPLIED

V

STEP 1: Select One UL-Rated Vision Lite Kit—VSL OR VLFEZ

(VSL) SLIMLINE LITE KIT FOR 1-3/4" UL10B DOORS

20 gauge cold rolled steel frame with radius corners, mitered and welded, continuous glass retainer and countersunk mounting holes. Self-attaching, leaving corridor side of frame free of fasteners for aesthetic and security purposes. Durable Bronze powder coat finish. See data sheet for more information. **Order Size is Cutout Size.**



or



| 24-48 Hour Shipping for Many of these Sizes See Location Stock Listings for Availability & Shipping Schedule from Each Location | | | | | | | |
|--|----------|-----|-----------|-----|-----------|-----|--------------------------|
| QTY | SIZE | QTY | SIZE | QTY | SIZE | QTY | SIZE |
| | 5" x 35" | | 8" x 30 | | 24" x 24" | | 24" x 60" |
| | 6" x 27" | | 8" x 32 | | 24" x 30" | | 24" x 64" |
| | 7" x 22" | | 8" x 36 | | 24" x 32" | | Other Size↓ |
| | 8" x 18 | | 12" x 12" | | 24" x 36" | | ___" Width x ___" Height |

(VLFEZ) LITE KIT FOR 1-3/4" UL 10B DOORS

20 gauge cold rolled steel frame with mitered and welded corners, continuous glass retainer and countersunk mounting holes. Self-attaching, leaving corridor side of frame free of fasteners for aesthetic and security purposes. Durable Bronze powder coat finish. See data sheet for more information. **Order Size is Cutout Size.**

| 24-48 Hour Shipping for Many of these Sizes See Location Stock Listings for Availability & Shipping Schedule from Each Location | | | | | | | |
|--|----------|-----|----------|-----|-----------|-----|--------------------------|
| QTY | SIZE | QTY | SIZE | QTY | SIZE | QTY | SIZE |
| | 5" x 35" | | 8" x 18" | | 12" x 12" | | 24" x 32" |
| | 6" x 27" | | 8" x 32" | | 24" x 24" | | Other Size↓ |
| | 7" x 22 | | 8" x 36" | | 24" x 30" | | ___" Width x ___" Height |

STEP 2: Select One Glazing Choice (See Complete Descriptions and recommended Sizes in Glazing Section)

___ (WS) WireShield - Wired Glass, CAT II Impact-rated, Fire-rated - WHI Listed, for UL10B Door Assy.
Size: Any size up to 36" x 92" depending on rating desired. Glazing Tape Applied. *Available for most size frames above.*

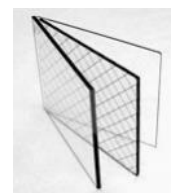

___ (TEMP) Tempered Glass - CAT II Impact-rated (Not Fire-rated)
Size: Any size up to 60" x 104". Glazing Tape Applied. *Available for most size frames above.*



___ (PPF) Pyran® Platinum F Glass (SAFTI FIRST)- CAT II Impact-rated, Fire-rated - UL Listed, for UL10B Door Assy.
Size: Any size up to 36" x 77"* depending on rating desired. Glazing Tape Applied. *Available for selected frame sizes above.*



___ (KFRF) KeraShield® CAT II Impact-rated, Fire-rated - UL Listed, for UL10B Door Assy.
Size: Any size up to 36" x 75"* depending on rating desired. Glazing Tape Applied. *Available for selected frame sizes above.*



STEP 3: We Size the Glazing for the Kits You Select, Apply Glazing Tape and Package

[Click Here to Check Stock List for My Combination of Vision Lite & Glazing](#)



DON'T SEE YOUR SIZE OR VISION LITE HERE? We can Make up a PAK for any Vision Lite. [Click Here for Online Order Form](#)

If Not Submitting Order on this Form: Format as follows: **Kit Size Glazing PAK**. Example: VSL 1212 WS PAK

Interpretation of Fire and Building Codes May Vary. Consult with the Local Authority Having Jurisdiction (AHJ) to determine appropriate standards.

| | | |
|--|--------------|---|
|  © 2017 Activar Construction Products Group, Inc. | Distributor: | Use 1 Page Per PAK Glass type |
| | Architect: | Select PAK Above in Steps 1-2 |
| | Contractor: | View Online Custom Order Form |
| | Project: | Date: Version: ALPDS1612 |
| 800-554-6077 QUOTES@ACTIVARCPG.COM ORDERS@ACTIVARCPG.COM SALES@ACTIVARCPG.COM FAX: 952-835-2218 VISIT WWW.ACTIVARCPG.COM FOR THE MOST UPDATED PRODUCT INFORMATION BEFORE ORDERING MFG: COMMERCE CA, BLOOMINGTON, MN • WAREHOUSES: LANCASTER PA, ATLANTA GA, CHICAGO IL, SEATTLE WA, FORT MYERS FL, DALLAS TX, FARGO ND, OMAHA NE | | |

V2 SLIMLINE™ VISION KITS FOR 3/16-1/4" GLASS: VSL, SLR, VWL - REV A

Low Profile Beveled Vision Lite For Fire Rated Doors. Self-Attaching for Glass 3/16" to 1/4"
Frame Has Single-side Fasteners. Available in Round Shapes or Wood Veneer

SPECIFICATIONS:

| | |
|---|---|
| Material: | 20 gauge CRS frame. Min Size 3" x 3", Max 60" x 104". See Fire Rating Below. |
| Construction: | 1-1/4" trim with radius corners, mitered and welded. Continuous glass retainer, countersunk mounting holes in the bevel on non-corridor side. |
| Door: | For 1-3/4" door. For other sizes, see models VLFIG and VLFEZIG. Door cutout = order size. |
| Fasteners: | #8 x 1" flathead phillips SMS to match finish. Woodlite has wood veneer plugs covering screw heads. |
| Powder Coat Finishes: | <input type="checkbox"/> (B) Mineral Bronze <input type="checkbox"/> (G) Gray (stock colors for VSL) <input type="checkbox"/> (BK) Black <input type="checkbox"/> (FBK) Flat Black <input type="checkbox"/> (W) White <input type="checkbox"/> (SB) SC Beige <input type="checkbox"/> (SI) Silver <input type="checkbox"/> (R) Red <input type="checkbox"/> (S) Sand <input type="checkbox"/> (AB) AMS Beige <input type="checkbox"/> (GH) Gray Hammertone View Color Samples Online |
| Glass: | 3/16" - 1/4" glazing to be ordered separately from Glazing Section of catalog. Use fire rated glazing with Warnock Hersey (WHI) or UL classification markings for fire rated applications. Visible light is 2" under rough opening size. Glass size is 1" under order size. Fire-Rated Air Louvers Glazing to fit this Product: WS, KFRF, PPF, VSL and SLF. |
| Fire-Rating, Testing & Listings: | When installed in properly rated and approved door, ratings up to 3 hours can be achieved for VSL and SLR, depending on the glazing used . See glazing ratings for max exposed area. Tested and Listed for UL 10C and Criteria of UBC 7-2 Positive Pressure. See detailed installation instructions. |

OPTIONS AT ADDITIONAL COST:

| | |
|----------------------------------|---|
| PAK: | Includes Vision Lite, Glass Sized to Fit, Applied Glazing tape for UL10B Installations, Securely Packaged Individually. See First Page in Vision Lite Catalog to order. |
| ULC 7-2 Installation: | <input type="checkbox"/> Additional intumescent tape for Positive Pressure UL10C for UL Listing. See detailed installation instructions. NOTE: Intumescent tape NOT needed for 20 Minute Wood doors. |
| Finishes & Materials: | <input type="checkbox"/> (S) 20 Gauge Stainless Steel: #4 Finish. <input type="checkbox"/> (G) Galvanized Sheet for Exterior Applications. <input type="checkbox"/> (E) Electro Zinc Plating for Maximum Corrosion Resistance. |
| Woodlite Wood Veneers: | <input type="checkbox"/> VWL .010 Wood Veneer to Match Wood Finish. (excludes SLR) Rated 90 mins <input type="checkbox"/> Veneer Type: (WV-07) Maple, (WV-06) White Birch, (WV-05) Red Oak. See website for more wood type codes and photos. Samples available upon request. |
| Fasteners: | <input type="checkbox"/> Torx <input type="checkbox"/> Other: _____ |
| Mullions: | Factory welded to vision lite & painted. See Mullions Page in this section to order. |
| Round Vision Lite: | <input type="checkbox"/> SLR-12: One piece, 18 gauge construction. 11" glazing. (n/a (S) material) <input type="checkbox"/> SLR-18: One piece, 18 gauge construction. 17" glazing. (n/a (S) material) |
| Privacy Screen: | Add the New Privacy Screen to This Vision Lite— See Web Page for Details |
| Custom: | Smaller or larger size or other options; Contact Customer Service for special orders. |

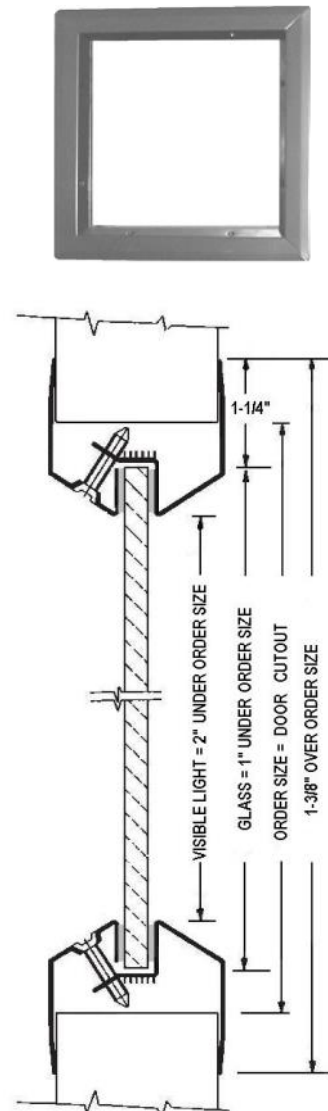

STOCK ITEM - MANY STANDARD SIZES OF VSL FRAMES IN STOCK FOR NEXT DAY SHIPMENT FROM ALL WAREHOUSES - LINK

Order Format:

VSL, SLR, VWL Option S,G,EG W H Color

Example: VSL 1212GH

Interpretation of Fire and Building Codes May Vary. Consult with the Local Authority Having Jurisdiction (AHJ) to determine appropriate standards.

| | | |
|---|---------------------|--|
| <p>© 2017 Activar Construction Products Group, Inc.</p> | Distributor: | Width: _____ x Height: _____ |
| | Architect: | Quantity: |
| | Contractor: | Model: |
| | Project: | Date: _____ Version: ALPDS1612 |

800-554-6077 QUOTES@ACTIVARCPG.COM ORDERS@ACTIVARCPG.COM SALES@ACTIVARCPG.COM Fax: 952-835-2218

VISIT WWW.ACTIVARCPG.COM FOR THE MOST UPDATED PRODUCT INFORMATION BEFORE ORDERING

MFG: COMMERCE CA, BLOOMINGTON, MN • WAREHOUSES: LANCASTER PA, ATLANTA GA, CHICAGO IL, SEATTLE WA, FORT MYERS FL, DALLAS TX, FARGO ND, OMAHA NE

SLIMLINE™ VISION LITE FOR 5/16" - 1-11/16" GLASS: VSIG - REV A

V3

Low Profile Beveled Vision Lite For Fire Rated Doors. Corridor Side of Door is Free of Fasteners
For Glazing thickness of 5/16" to 1 11/16". UL-Listed Models Now Available for 1" to 3" Thick Doors.

SPECIFICATIONS:

| | |
|---|---|
| Material: | 20 gauge CRS frame. Min. size 3" x 3", max. 60" x 104". See Fire Rating Below. |
| Construction: | 1-1/4" trim with radius corners, mitered and welded. Continuous glass retainer, countersunk mounting holes in the bevel on non-corridor side. |
| Door: | ___ UL Listing: 1" to 3". Specify door thickness: ____ ___ WHI Listing: For 1-3/4" door. Door cutout = order size. |
| Fasteners: | #8 x 1" flathead phillips SMS to match finish. |
| Powder Coat Finishes: | ___ (B) Mineral Bronze (stock color) ___ (BK) Black ___ (FBK) Flat Black ___ (W) White ___ (SB) SC Beige ___ (SI) Silver ___ (R) Red ___ (S) Sand ___ (G) Gray ___ (AB) AMS Beige ___ (GH) Gray Hammertone View Color Samples Online |
| Glass: | " Glass Thickness Will Be Used for this Order. Select Door Above. 5/16"-1" glazing to be ordered separately from Glazing Section of catalog. Use fire rated glazing with Warnock Hersey (WHI) or UL classification markings for fire rated applications. Visible light is 2" under rough opening size. Glass is 1" under order size. Must specify glass thickness above. If glazing is being provided by a supplier other than Air Louvers, coordinate with the supplier to ensure compatibility with IG kits. Fire-Rated Air Louvers Glazing to fit this vision frame: KFRL, KRFU, CONTRA45, CONTRA 60, ARMRSIELD, LGSHIELD. |
| Fire-Rating, Testing & Listings: | When installed in properly rated and approved door, ratings up to 3 hours can be achieved for VSIG, depending on the glazing used. See glazing ratings for max exposed area. Tested and Listed for UL 10C and Criteria of UBC 7-2 Positive Pressure. |

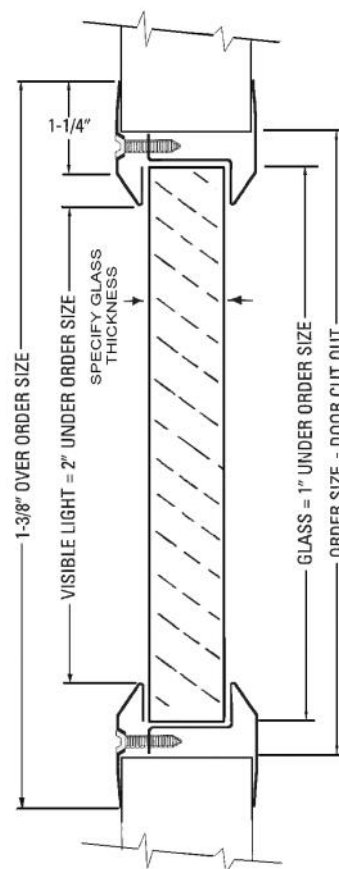

OPTIONS AT ADDITIONAL COST:

| | |
|----------------------------------|---|
| UBC 7-2 Installation: | ___ Fire Rating can be achieved for VSIG. See detailed installation instructions. |
| Finishes & Materials: | ___ (S) 20 Gauge Stainless Steel: #4 Finish. ___ (G) Galvanized Sheet for Exterior Applications. ___ (E) Electro Zinc Plating for Maximum Corrosion Resistance. ___ VWLIG —Wood Veneer Finish (up to 90 minutes)— View Selection Here |
| Fasteners: | ___ Torx ___ Other: _____ |
| Mullions: | Factory welded to vision lite & painted. See Mullions Page in this section to order. |
| Privacy Screen: | Add the New Privacy Screen to This Vision Lite— See Web Page for Details |
| Custom: | PAK, smaller or larger sizes, or other options, contact Customer Service for special orders. |
| Miniblind in Vision Lite: | Blinds are sealed between the two lites of glass. See separate VSLIGMB page in this section |

STOCK ITEM - MANY STANDARD SIZES OF VSIG IN STOCK FOR NEXT DAY SHIPMENT FROM SEVERAL WAREHOUSES - LINK

Order Format: VSIG

Option S,G,EG W H Color Glass Thickness

Example: VSIG 1818B 01

Interpretation of Fire and Building Codes May Vary. Consult with the Local Authority Having Jurisdiction (AHJ) to determine appropriate standards.

| | | | |
|---|---------------------|---|---------------------------|
| <p>© 2017 Activar Construction Products Group, Inc.</p> | Distributor: | Width: ____ x Height: ____ | |
| | Architect: | Quantity: ____ Door Thickness: ____ | |
| | Contractor: | Glass Thickness: ____ | |
| | Project: | Date: ____ | Version: ALPDS1612 |
| <p>800-554-6077 QUOTES@ACTIVARCPG.COM ORDERS@ACTIVARCPG.COM SALES@ACTIVARCPG.COM FAX: 952-835-2218</p> <p>VISIT WWW.ACTIVARCPG.COM FOR THE MOST UPDATED PRODUCT INFORMATION BEFORE ORDERING</p> <p>MFG: COMMERCE CA, BLOOMINGTON, MN • WAREHOUSES: LANCASTER PA, ATLANTA GA, CHICAGO IL, SEATTLE WA, FORT MYERS FL, DALLAS TX, FARGO ND, OMAHA NE</p> | | | |

V4 BEVELED VISION LITE FOR 3/16"-1/4" GLAZING: VLFEZ™ - REV A

Self-Attaching, Beveled Vision Lite with Single Side Fasteners For Fire Rated Doors for 3/16" to 1/4" Glass

SPECIFICATIONS:

| | |
|---|---|
| Material: | 20 gauge CRS frame. Min Size 3" x 3", Max 60" x 104". See Fire Rating Below. |
| Construction: | 1-1/4" trim, with mitered and welded corners. Continuous glass retainer, counter-sunk mounting holes in the bevel on non-corridor side. 3/8" projection from door. |
| Door: | For 1-3/4" door. For other sizes, see VLFIG & VLFEZIG. Door cutout = order size. |
| Fasteners: | #8 x 1" flathead phillips SMS to match finish. |
| Powder Coat Finishes: | ____ (B) Mineral Bronze ____ (G) Gray (stock colors) ____ (BK) Black ____ (FBK) Flat Black ____ (W) White ____ (SB) SC Beige ____ (SI) Silver ____ (R) Red ____ (S) Sand ____ (AB) AMS Beige ____ (GH) Gray Hammertone View Colors Online |
| Glass: | 3/16" - 1/4" glazing to be ordered separately from Glazing Section of catalog. Use fire rated glazing with Warnock Hersey (WHI) or UL classification markings for fire rated applications. Visible light is 2" under rough opening size. <u>Glass is 1" under order size.</u> Fire-Rated Air Louvers Glazing to fit this vision frame: WS, KFRF, PPF. |
| Fire-Rating, Testing & Listings: | When installed in properly rated and approved door, ratings up to 3 hours can be achieved, depending on the glazing used. See glazing ratings for max exposed area. Tested and Listed for UL 10C and Criteria of UBC 7-2 Positive Pressure. See detailed installation instructions. |



OPTIONS AT ADDITIONAL COST:

| | |
|----------------------------------|--|
| PAK: | Includes Vision Lite, Glass Sized to Fit, Applied Glazing tape for UL10B Installations, Securely Packaged Individually. See First Page in Vision Lite Catalog. |
| UBC 7-2 Installation: | ____ Additional intumescent tape for Positive Pressure UL10C. See detailed installation instructions. |
| Finishes & Materials: | ____ (S) 20 Gauge Stainless Steel: #4 Finish. ____ (G) Galvanized Sheet for Exterior Applications. ____ (E) Electro Zinc Plating for Maximum Corrosion Resistance. |
| Fasteners: | ____ Torx ____ Other: _____ |
| Mullions: | Factory welded to vision lite & painted. See Mullions Page in this section to order. |
| Privacy Screen: | Add the New Privacy Screen to This Vision Lite— See Web Page for Details |
| Custom: | Smaller or larger sizes. Leadlined. Contact Customer Service for special orders. |

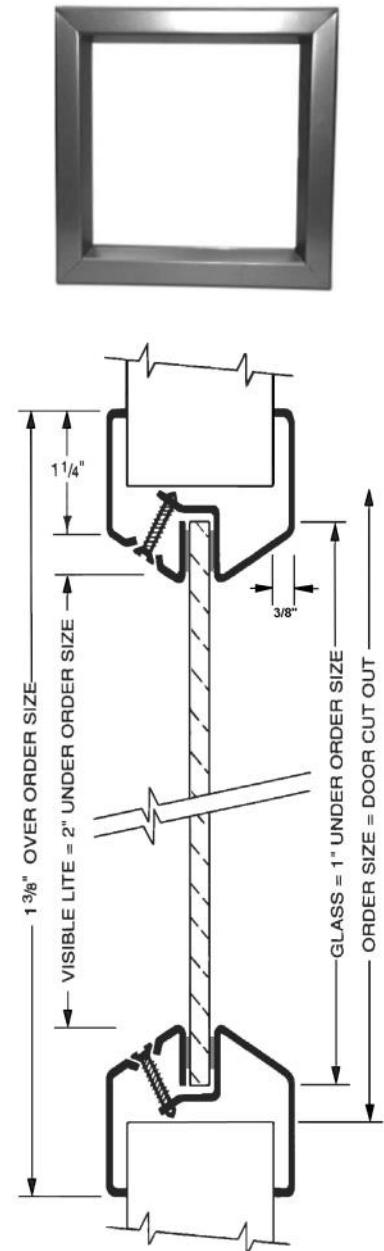

STOCK ITEM - MANY STANDARD SIZES OF VLFEZ IN STOCK FOR NEXT DAY SHIPMENT FROM ALL WAREHOUSES - LINK

Order Format: VLFEZ

Option S,G,EG W H Color

Example: VLFEZ 1212AB

Interpretation of Fire and Building Codes May Vary. Consult with the Local Authority Having Jurisdiction (AHJ) to determine appropriate standards.

| | | |
|---|---------------------|---|
| <p>© 2017 Activar Construction Products Group, Inc.</p> | Distributor: | Width: ____ x Height: ____ |
| | Architect: | Quantity: |
| | Contractor: | Model: |
| | Project: | Date: ____ Version: ALPDS1612 |
| <p>800-554-6077 QUOTES@ACTIVARCPG.COM ORDERS@ACTIVARCPG.COM SALES@ACTIVARCPG.COM Fax: 952-835-2218</p> <p>VISIT WWW.ACTIVARCPG.COM FOR THE MOST UPDATED PRODUCT INFORMATION BEFORE ORDERING</p> <p>MFG: COMMERCE CA, BLOOMINGTON, MN • WAREHOUSES: LANCASTER PA, ATLANTA GA, CHICAGO IL, SEATTLE WA, FORT MYERS FL, DALLAS TX, FARGO ND, OMAHA NE</p> | | |

BEVELED VISION LITE FOR 5/16" - 1- 11/16" GLAZING & UP TO 3" DOOR: VLFEZIG™-REV A

V5

Recommended for Applications Requiring Fire Rated, Safety, and or Insulated Glazing 5/16" to 1 11/16" Thick

SPECIFICATIONS:

| | |
|---|---|
| Material: | 20 gauge CRS frame. Min Size 3" x 3", Max 60" x 104". See Fire Rating Below. |
| Construction: | 1-1/4" trim with radius corners, mitered and welded. Continuous glass retainer, countersunk mounting holes either in the bevel or on the face of the non-corridor side, depending on thickness required. Frame projects 3/8". |
| Door: | UL: 1" - 3" door. Specify door thickness: _____ Door cutout = order size. WHI: 1 3/8" to 2 1/2" |
| Fasteners: | #8 x 1" flathead phillips SMS to match finish. |
| Powder Coat Finishes: | ____ (B) Mineral Bronze (standard color) ____ (BK) Black ____ (FBK) Flat Black ____ (W) White ____ (SB) SC Beige ____ (SI) Silver ____ (R) Red ____ (S) Sand ____ (G) Gray ____ (AB) AMS Beige ____ (GH) Gray Hammertone View Colors Online |
| Glass: | ____ " Glass Thickness Will Be Used for this Order 5/16" - 1 11/16" glazing to be ordered separately from Glazing Section of catalog. Use fire rated glazing with Warnock Hersey (WHI) or UL classification markings for fire rated applications. Visible light is 2" under rough opening size. <u>Glass is 1" under order size.</u> Must specify glass thickness above. Fire-Rated Air Louvers Glazing to fit this vision frame: KFRF, KFRFU, CONTRA45, CONTRA60, ARMRSIELD, LGSHIELD. If glazing is being provided by a supplier other than Air Louvers, coordinate with the supplier to ensure compatibility with IG kits. |
| Fire-Rating, Testing & Listings: | When installed in properly rated and approved door, ratings up to 3 hours can be achieved, depending on the glazing used. See glazing ratings for max exposed area. Tested and Listed for UL 10C and Criteria of UBC 7-2 Positive Pressure. |

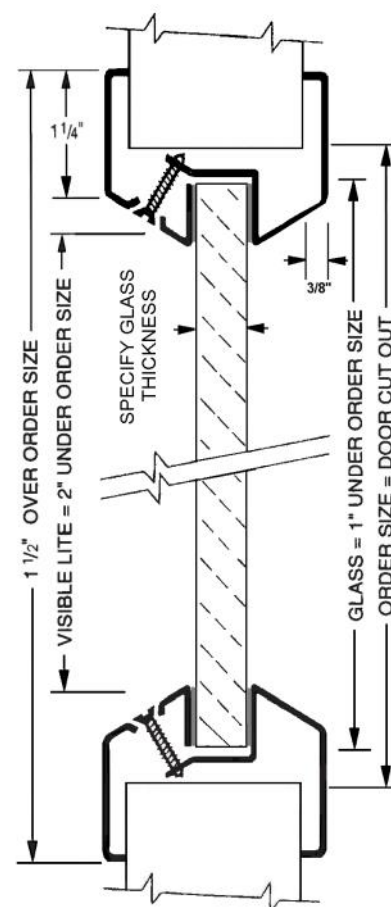

OPTIONS AT ADDITIONAL COST:



| | |
|----------------------------------|--|
| UBC 7-2 Installation: | ____ Additional intumescent tape for Positive Pressure UL10C. See detailed installation instructions. |
| Finishes & Materials: | ____ (S) 20 Gauge Stainless Steel: #4 Finish. ____ (G) Galvanized Sheet for Exterior Applications. ____ (E) Electro Zinc Plating for Maximum Corrosion Resistance. |
| Fasteners: | ____ Torx ____ Other: _____ |
| Mullions: | Factory welded to vision lite & painted. See Mullions Page in this section to order. |
| Custom: | PAK, smaller or larger sizes. Leadlined. Contact Customer Service for Special Orders. |
| Miniblind in Vision Lite: | Blinds are sealed between the two lites of glass. See separate VLFEZIGMB page in this section to view options. |

Order Format: VLFEZIG

Option S,G,EG W H Color Glass Thickness

Example: VLFEZIG 1212S 01

Interpretation of Fire and Building Codes May Vary. Consult with the Local Authority Having Jurisdiction (AHJ) to determine appropriate standards.

| | | | |
|--|---------------------|---|---------------------------|
|  © 2017 Activar Construction Products Group, Inc. | Distributor: | Width: _____ x Height: _____ | |
| | Architect: | Quantity: _____ Door Thickness: _____ | |
| | Contractor: | Glass Thickness: _____ | |
| | Project: | Date: _____ | Version: ALPDS1612 |
| 800-554-6077 QUOTES@ACTIVARCPG.COM ORDERS@ACTIVARCPG.COM SALES@ACTIVARCPG.COM Fax: 952-835-2218 VISIT WWW.ACTIVARCPG.COM FOR THE MOST UPDATED PRODUCT INFORMATION BEFORE ORDERING MFG: COMMERCE CA, BLOOMINGTON, MN • WAREHOUSES: LANCASTER PA, ATLANTA GA, CHICAGO IL, SEATTLE WA, FORT MYERS FL, DALLAS TX, FARGO ND, OMAHA NE | | | |

Standard, Multi-Purpose, Thru-Bolted Square Profile Vision Lite for Up to 1/4" Thick Glazing

SPECIFICATIONS:

| | |
|---|--|
| Material: | 18 gauge CRS frame. Min Size 3" x 3", Max 60" x 104". See Fire Rating Below. |
| Construction: | 1-1/4" trim with radius corners, mitered and welded. Countersunk mounting holes on both sides. |
| Door: | For 1-3/4" door. Door cutout = order size. |
| Fasteners: | #8 x 32 flathead phillips head thrubolts with blank heads one side to match finish. |
| Powder Coat Finishes: | ____ (B) Mineral Bronze (standard color) ____ (G) Gray ____ (BK) Black ____ (FBK) Flat Black ____ (W) White ____ (SB) SC Beige ____ (SI) Silver ____ (R) Red ____ (S) Sand ____ (AB) AMS Beige ____ (GH) Gray Hammertone View Colors Online |
| Glass: | 3/16" - 1/4" glazing to be ordered separately from Glazing Section of catalog. Use fire rated glazing with Warnock Hersey (WHI) or UL classification markings for fire rated applications. Visible light is 1" under rough opening size. <u>Glass size is 1/4" under order size.</u> Fire-Rated Air Louvers Glazing to fit this vision frame: WS, KFRF, PPF. |
| Fire-Rating, Testing & Listings: | When installed in properly rated and approved door, ratings up to 3 hours can be achieved, depending on the glazing used. See glazing ratings for max exposed area. Tested and Listed for UL 10C and Criteria of UBC 7-2 Positive Pressure. See detailed installation instructions. |

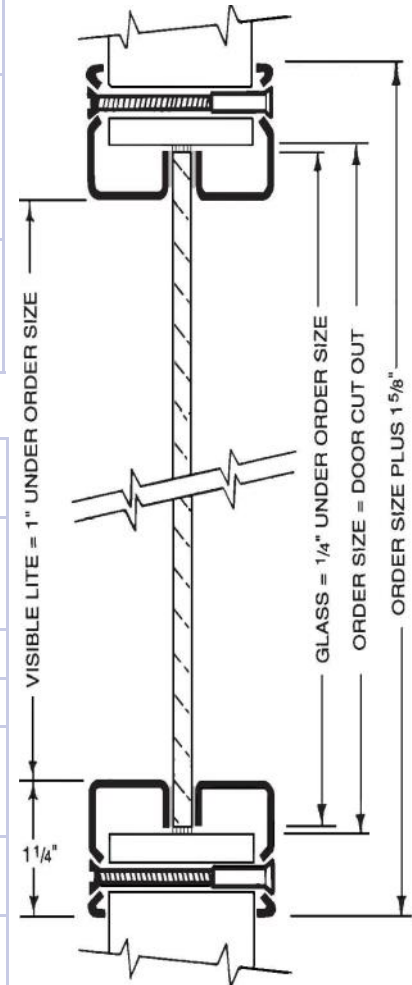

OPTIONS AT ADDITIONAL COST:



| | |
|----------------------------------|---|
| UBC 7-2 Installation: | ____ Additional intumescent tape for Positive Pressure UL10C . See detailed installation instructions. |
| Finishes & Materials: | ____ (S) 18 Gauge Stainless Steel: #4 Finish. ____ (G) Galvanized Sheet for Exterior Applications. ____ (E) Electro Zinc Plating for Maximum Corrosion Resistance. |
| Fasteners: | ____ Torx ____ Other: _____ |
| Mullions: | Factory welded to vision lite & painted. See Mullions Page in this section to order. |
| Custom: | PAK, smaller or larger sizes. Leadlined. Please consult Customer Service for Special Orders. See Page 14 for Custom Shapes. See Page 9 for Round, Half-Round & Radius Frames in this Catalog. |
| Privacy Door: | VLFPVC 16 gauge door on continuous hinges welded to vision lite. (Not F.R.) Minimum size 4" x 4", max size 60" x 60". See Privacy Options Tab. |
| Privacy Screen: | Add the New Privacy Screen to This Vision Lite— See Web Page for Details |

Order Format: VLF

Option S,G,EG W H Color

Example: VLF 1212FBK

Interpretation of Fire and Building Codes May Vary. Consult with the Local Authority Having Jurisdiction (AHJ) to determine appropriate standards.

| | | |
|--|---------------------|---|
| © 2017 Activar Construction Products Group, Inc. | Distributor: | Width: ____ x Height: ____ |
| | Architect: | Quantity: |
| | Contractor: | Model: |
| | Project: | Date: ____ Version: ALPDS1612 |
| 800-554-6077 QUOTES@ACTIVARCPG.COM ORDERS@ACTIVARCPG.COM SALES@ACTIVARCPG.COM Fax: 952-835-2218 VISIT WWW.ACTIVARCPG.COM FOR THE MOST UPDATED PRODUCT INFORMATION BEFORE ORDERING MFG: COMMERCE CA, BLOOMINGTON, MN • WAREHOUSES: LANCASTER PA, ATLANTA GA, CHICAGO IL, SEATTLE WA, FORT MYERS FL, DALLAS TX, FARGO ND, OMAHA NE | | |

VISION LITE FOR 5/16" TO 1-11/16" GLASS & UP TO 3" DOOR: VLFIG™ - REV A V7

Square Profile Vision Lite for Glass Thicker than 5/16" - Recommended for Applications Requiring Fire-Rated, Safety, and/or Insulated Glazing up to 1-11/16" Thick.

SPECIFICATIONS:

| | |
|---|---|
| Material: | 18 gauge CRS frame. Min. size 3" x 3", max 60" x 104". See Fire Rating Below. |
| Construction: | 1-1/4" trim with mitered and welded corners, square return with countersunk mounting holes on both sides. |
| Door: | For 1" - 3" thick. Specify door thickness: _____ Door cutout = order size. |
| Fasteners: | #8 x 32 flathead Phillips head thru-bolts with blank head one side to match finish. |
| Powder Coat Finishes: | ____ (B) Mineral Bronze (standard color) ____ (BK) Black ____ (FBK) Flat Black ____ (W) White ____ (SB) SC Beige ____ (SI) Silver ____ (R) Red ____ (S) Sand ____ (G) Gray ____ (AB) AMS Beige ____ (GH) Gray Hammertone View Colors Online |
| Glass: | _____ " Glass Thickness Will Be Used for this Order 5/16" - 1-11/16" glazing to be ordered separately from Glazing Section of catalog. Use fire rated glazing with Warnock Hersey (WHI) or UL classification markings for fire rated applications. Visible light is 1" under rough opening size. <u>Glass size is 1/4" under order size.</u> Must specify glass thickness above. If glazing is being provided by a supplier other than Air Louvers, coordinate with the supplier to ensure compatibility with IG kits. Fire-Rated Air Louvers Glazing to fit this vision frame: KFRL, KFRFU, CONTRA45, CONTRA60, CONTRA90, ARMRSIELD, LGSHIELD. |
| Fire-Rating, Testing & Listings: | When installed in properly rated and approved door, ratings up to 3 hours can be achieved, depending on the glazing used. See glazing ratings for max exposed area. Tested and Listed for UL 10C and Criteria of UBC 7-2 Positive Pressure. See detailed installation instructions. |

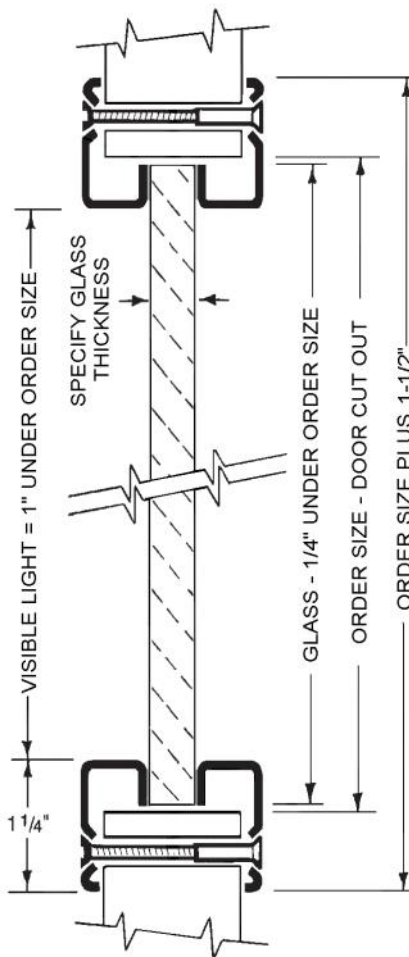

OPTIONS AT ADDITIONAL COST:



| | |
|----------------------------------|--|
| UBC 7-2 Installation: | ____ Additional intumescent tape for Positive Pressure UL10C . See detailed installation instructions. |
| Finishes & Materials: | ____ (S) 18 Gauge Stainless Steel: #4 Finish. ____ (G) Galvanized Sheet for Exterior Applications. ____ (E) Electro Zinc Plating for Maximum Corrosion Resistance. |
| Mullions: | Factory welded to vision lite & painted. See Mullions Page in this section to order. |
| Fasteners: | ____ Torx ____ Other: _____ |
| Round: | ____ VLFIGR12 ____ VLFIGR18 ____ Custom _____" |
| Privacy Screen: | Add the New Privacy Screen to This Vision Lite— See Web Page for Details |
| Custom: | PAK, smaller or larger sizes. Leadlined. Consult Customer Service for Special orders. |

Order Format: VLFIG

Option S,G,EG W H Color Glass Thickness

Example: VLFIG 1227 BK 01

Interpretation of Fire and Building Codes May Vary. Consult with the Local Authority Having Jurisdiction (AHJ) to determine appropriate standards.

| | | | |
|--|---------------------|---|---------------------------|
| © 2017 Activar Construction Products Group, Inc. | Distributor: | Width: _____ x Height: _____ | |
| | Architect: | Quantity: _____ Door Thickness: _____ | |
| | Contractor: | Glass Thickness: _____ | |
| | Project: | Date: _____ | Version: ALPDS1612 |
| 800-554-6077 QUOTES@ACTIVARCPG.COM ORDERS@ACTIVARCPG.COM SALES@ACTIVARCPG.COM FAX: 952-835-2218 VISIT WWW.ACTIVARCPG.COM FOR THE MOST UPDATED PRODUCT INFORMATION BEFORE ORDERING MFG: COMMERCE CA, BLOOMINGTON, MN • WAREHOUSES: LANCASTER PA, ATLANTA GA, CHICAGO IL, SEATTLE WA, FORT MYERS FL, DALLAS TX, FARGO ND, OMAHA NE | | | |

V8

DOUBLE GLAZED VISION LITE: VLFDG™ - REV A

Recommended for Applications Where Two Lites of Glass are Required

SPECIFICATIONS:

| | |
|---|---|
| Material: | 18 gauge CRS frame. Min Size 3" x 3", max size 60" x 104". |
| Construction: | 1-1/4" trim with mitered and welded corners, square return with counter-sunk mounting holes, 1/4" x 1/4" continuous steel spacer provided. |
| Door: | For 1-3/4" door. Door cutout = order size. |
| Fasteners: | #8 x 32 Phillips head thru bolts with blank head one side to match finish. |
| Powder Coat Finishes: | ____ (B) Mineral Bronze (standard color) ____ (G) Gray ____ (BK) Black ____ (FBK) Flat Black ____ (W) White ____ (SB) SC Beige ____ (SI) Silver ____ (R) Red ____ (S) Sand ____ (AB) AMS Beige ____ (GH) Gray Hammertone View Colors Online |
| Glass: | 3/16" - 1/4" glazing to be ordered separately from Glazing Section of catalog. Glass pocket is 3/4" inch allowing for 2 panes of 1/4" glass and 1/4" spacer plus glazing tape 2 sides. Visible light is 1" under rough opening size. <u>Glass is 1/4" under order size.</u> Air Louvers Glazing to fit this Product: WS, KFRF, PPF. |
| Fire-Rating, Testing & Listings: | When installed in properly rated and approved door, ratings up to 3 hours can be achieved, depending on the glazing used. See glazing ratings for max exposed area. Tested and Listed for UL 10C and Criteria of UBC 7-2 Positive Pressure. See detailed installation instructions. |



OPTIONS AT ADDITIONAL COST:

| | |
|----------------------------------|--|
| UBC 7-2 Installation: | ____ Additional intumescent tape for Positive Pressure UL10C . See detailed installation instructions. |
| Finishes & Materials: | ____ (S) 18 Gauge Stainless Steel: #4 Finish. ____ (G) Galvanized Sheet for Exterior Applications. ____ (E) Electro Zinc Plating for Maximum Corrosion Resistance. |
| Mullions: | Factory welded to vision lite & painted. See Mullions Page in this section to order. View Mullions Page Online |
| Fasteners: | ____ Torx ____ Other: _____ |
| Privacy Screen: | Add the New Privacy Screen to This Vision Lite— See Web Page for Details |
| Custom: | Order this with Glass as a "PAK". Available in leadlined. Consult Customer Service for Special Orders. |

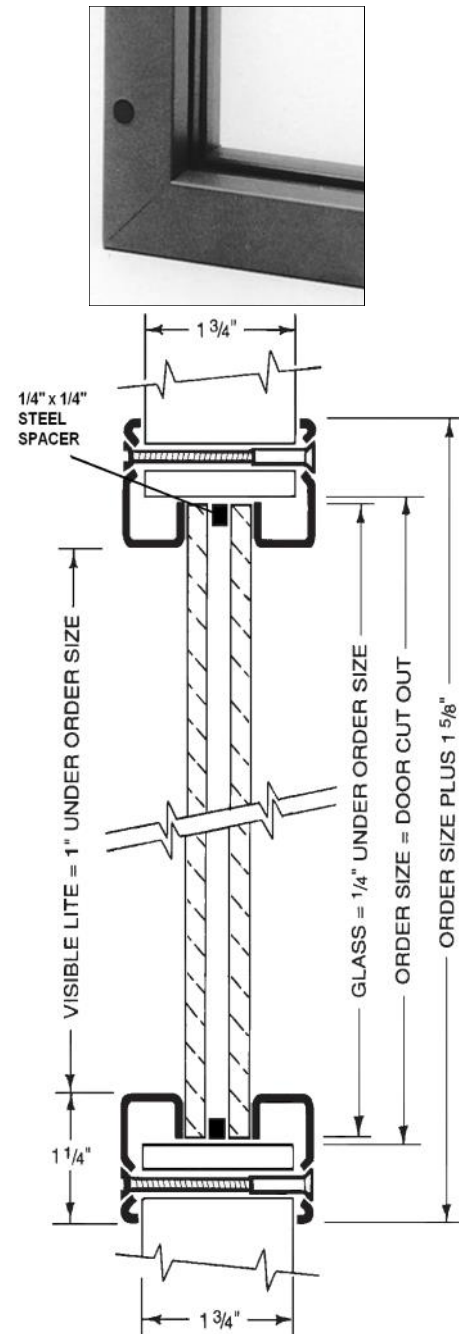

Order Format: VLFDG

Option S,G,EG

W

H

Color

Example: VLFDG 1212 B

Interpretation of Fire and Building Codes May Vary. Consult with the Local Authority Having Jurisdiction (AHJ) to determine appropriate standards.

| | | |
|---|---------------------|---|
| <p>© 2017 Activar Construction Products Group, Inc.</p> | Distributor: | Width: ____ x Height: ____ |
| | Architect: | Quantity: |
| | Contractor: | Model: |
| | Project: | Date: ____ Version: ALPDS1612 |
| <p>800-554-6077 QUOTES@ACTIVARCPG.COM ORDERS@ACTIVARCPG.COM SALES@ACTIVARCPG.COM Fax: 952-835-2218</p> <p>Visit WWW.ACTIVARCPG.COM FOR THE MOST UPDATED PRODUCT INFORMATION BEFORE ORDERING</p> <p>MFG: COMMERCE CA, BLOOMINGTON, MN • WAREHOUSES: LANCASTER PA, ATLANTA GA, CHICAGO IL, SEATTLE WA, FORT MYERS FL, DALLAS TX, FARGO ND, OMAHA NE</p> | | |

VLF - STANDARD SHAPES - ROUND, RADIUS, HALF ROUND- REV A

V9

SPECIFICATIONS:

| | |
|---|---|
| Material: | 18 gauge CRS frame. |
| Construction: | Circular - one piece construction with no joints. Radius and half round are constructed with radius corners, mitered and welded with no exposed joints and countersunk holes both sides. |
| Door: | For 1-3/4" door. Door cutout = order size. |
| Fasteners: | #8 x 32 Phillips head thru bolts with blank head one side to match finish. |
| Powder Coat Finishes: | ____ (B) Mineral Bronze (standard color) ____ (BK) Black ____ (FBK) Flat Black ____ (W) White ____ (SB) SC Beige ____ (SI) Silver ____ (R) Red ____ (S) Sand ____ (G) Gray ____ (AB) AMS Beige ____ (GH) Gray Hammertone View Colors Online |
| Glass: | 3/16" - 1/4" glazing to be ordered separately from Glazing Section of catalog. Use fire rated glazing with (WHI) or UL classification markings for fire rated applications. Visible light is 1" under rough opening size. Glass is 1/4" under order size. Fire-Rated Air Louvers Glazing to fit this vision frame: WS, KFRF, PPF, Non Fire-Rated Glazing: TEMP |
| Fire-Rating, Testing & Listings: | When installed in properly rated and approved door, ratings up to 3 hours can be achieved, depending on the glazing used. See glazing ratings for max exposed area. Tested and Listed for UL 10C and Criteria of UBC 7-2 Positive Pressure. See detailed installation instructions. |



VLFR



VLFRC



VLFRD



VLFRI

MODELS:

| | |
|---------------------------------|---|
| Round: | ____ VLFR12 ____ VLFR18 ____ VLFR24 ____ Custom ____" Standard widths shown above (Min size 6", max size 60" diameter) |
| Radius Top & Bottom: | ____ VLFRI-6 ____ VLFRI-12 ____ VLFRI-18 ____ VLFRI-24 ____ Custom ____" Standard widths shown above. (Min size 6 x 6", max size 60 x 104") |
| Radius Corner 6" Radius: | ____ VLFRC12 ____ VLFRC18 ____ VLFRC24 ____ Custom ____" Standard widths shown above. (Min size 8" x 8", max size 60 x 104") |
| Half Round: | ____ VLFRD18 Dimensions: 46-1/2" x 18" Standard widths shown at left. ____ VLFRD20 Dimensions: 50-5/8" x 20" Min size 6" x 18" max size 36" x 60") ____ VLFRD24 Dimensions: 58-3/4" x 24" Custom ____"W x ____" H |



OPTIONS AT ADDITIONAL COST:

| | |
|----------------------------------|--|
| UBC 7-2 Installation: | ____ Additional intumescent tape for Positive Pressure UL10C . See detailed installation instructions. |
| Finishes & Materials: | ____ (S) 18 Gauge Stainless Steel: #4 Finish. ____ (G) Galvanized Sheet for Exterior Applications. ____ (E) Electro Zinc Plating for Maximum Corrosion Resistance. |
| Fasteners: | Torx ____ Other: ____ |
| Custom: | Custom frame sizes, leadlined. Contact Customer Service for special orders. |

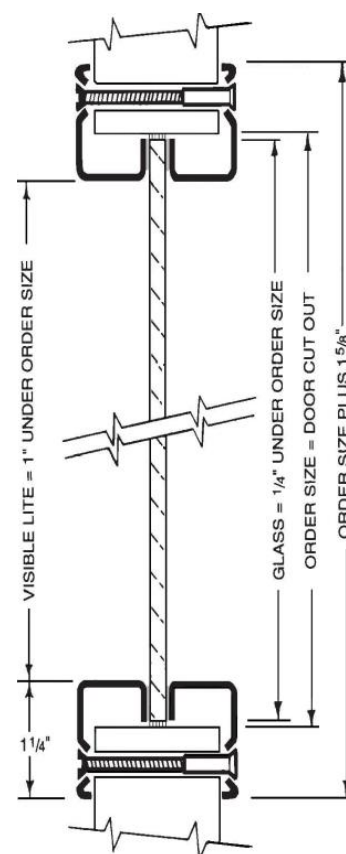

Order Format:

Model

Option S,G,E

Color

Example: VLFRD S 24

Interpretation of Fire and Building Codes May Vary. Consult with the Local Authority Having Jurisdiction (AHJ) to determine appropriate standards.

| | | |
|--|---------------------|----------------------------|
| © 2017 Activar Construction Products Group, Inc. | Distributor: | Width: ____ x Height: ____ |
| | Architect: | Quantity: |
| | Contractor: | Model: |
| | Project: | Date: Version: ALPDS1612 |
| 800-554-6077 QUOTES@ACTIVARCPG.COM ORDERS@ACTIVARCPG.COM SALES@ACTIVARCPG.COM FAX: 952-835-2218 VISIT WWW.ACTIVARCPG.COM FOR THE MOST UPDATED PRODUCT INFORMATION BEFORE ORDERING MFG: COMMERCE CA, BLOOMINGTON, MN • WAREHOUSES: LANCASTER PA, ATLANTA GA, CHICAGO IL, SEATTLE WA, FORT MYERS FL, DALLAS TX, FARGO ND, OMAHA NE | | |

V10

MULLIONS FOR VISION LITES: VSL / VLF/ VLFEZ - REV A

Square or Beveled Vision Lite with Mullions for Added Security or the "French Door" Look

SPECIFICATIONS:

| | |
|---|---|
| Material: | 18 gauge CRS for VLF & VLFIG, 20 gauge for VLF-EZ, VLFEZIG, Slimline (VSL) and Slimline IG (VSIG). |
| Construction: | Mullions are welded to both sides of vision lite at heads, sills and jambs, and butt to glass. Only one glass lite required. |
| Mullions: | 1" x 5/8" formed steel See Page V11 to view selections. |
| Door: | For 1-3/4" door. Door cutout = order size. |
| Fasteners: | See individual vision lite pages for fasteners. |
| Glass: | Use fire-rated glazing with UL or WHI classification marking for fire rated applications. See individual data pages for glazing choices. |
| Powder Coat Finishes: | ____ (B) Mineral Bronze (standard color) ____ (BK) Black ____ (FBK) Flat Black ____ (W) White ____ (SB) SC Beige ____ (SI) Silver ____ (S) Sand ____ (AB) AMS Beige ____ (R) Red ____ (GH) Gray Hammertone ____ (G) Gray View Colors Online |
| Fire-Rating, Testing & Listings: | When installed in properly rated and approved door, ratings up to 3 hours can be achieved, depending on the glazing used . See glazing ratings for max exposed area. All models of vision lites for mullioned-vision lites are tested and listed for UL 10C and Criteria of UBC 7-2 Positive Pressure. See Individual Data Sheets for full rating information. See detailed installation instructions. |



VLFB2

VSLB2

OPTIONS AT ADDITIONAL COST:

| | |
|----------------------------------|--|
| UBC 7-2 Installation: | ____ Additional intumescent tape for Positive Pressure UL10C . See detailed installation instructions. |
| Mullions: | ____ 1/2" x 1/2", 1/2 x 3/4", other sizes, contact Cust. Service. |
| Finishes & Materials: | ____ (S) 20 Gauge Stainless Steel: #4 Finish. ____ (G) Galvanized Sheet for Exterior Applications. ____ (E) Electro Zinc Plating for Maximum Corrosion Resistance. |
| Fasteners: | ____ Torx ____ Other: _____ |
| Custom: | Custom frame sizes or specials. Contact Customer Service. |



| Vision Frames - Mullions on Two Sides | | | |
|--|-----------|-----------|-------------|
| # Mullions (See page V11 for examples) | VSL Model | VLF Model | VLFEZ Model |
| 1 | VSLA2 | VLFA2 | VLFEZA2 |
| 2 | VSLA3 | VLFA3 | VLFEZA3 |
| 2 | VSLB2 | VLFB2 | VLFEZB2 |
| 3 | VSLB3 | VLFB3 | VLFEZB3 |
| 4 | VSLB4 | VLFB4 | VLFEZB4 |
| 4 | VSLC3 | VLFC3 | VLFEZC3 |
| 3 | VSLA4 | VLFA4 | VLFEZA4 |
| 4 | VSLA5 | VLFA5 | VLFEZA5 |
| 5 | VSLB5 | VLFB5 | VLFEZB5 |
| 5 | VSLC4 | VLFC4 | VLFEZC4 |
| 6 | VSLC5 | VLFC5 | VLFEZC5 |
| Mullions are Constructed of 1" W x 5/8" Formed Steel. See Page V11 for Illustration. | | | |

Order Format:

VLF, VLFIG, VSL, VSIG, VLFEZ, VLFEZIG MULLION Option S,G,E W H Color Code

Example: VLFB4 1836G

Interpretation of Fire and Building Codes May Vary. Consult with the Local Authority Having Jurisdiction (AHJ) to determine appropriate standards.

| | | |
|--|---------------------|----------------------------|
| <p>© 2017 Activar Construction Products Group, Inc.</p> | Distributor: | Width: ____ x Height: ____ |
| | Architect: | Quantity: |
| | Contractor: | Model: |
| | Project: | Date: Version: ALPDS1612 |
| 800-554-6077 QUOTES@ACTIVARCPG.COM ORDERS@ACTIVARCPG.COM SALES@ACTIVARCPG.COM Fax: 952-835-2218 VISIT WWW.ACTIVARCPG.COM FOR THE MOST UPDATED PRODUCT INFORMATION BEFORE ORDERING MFG: COMMERCE CA, BLOOMINGTON, MN • WAREHOUSES: LANCASTER PA, ATLANTA GA, CHICAGO IL, SEATTLE WA, FORT MYERS FL, DALLAS TX, FARGO ND, OMAHA NE | | |

FRAMED MULLIONS FOR TRANSOMS & SIDELITES: FRM REV A

V11

Framed mullions for Transom and Sidelites Recommended for Divided Glass Look in Transom and Sidelites

SPECIFICATIONS:

| | |
|---------------------------------------|---|
| Material: | 16 ga cold rolled steel |
| Construction: | Mullions are welded at heads, sills and jambs, and butt to glass. Pre-drilled mounting holes are provided on the perimeter mullions. (fasteners by others) |
| Mullions: | 3/4" x 3/4" steel tubes. Visible light is 1 1/2" under opening size. Transom or sidelite opening = order size. |
| Std. Finish: | Baked on powder coat gray prime for field painting. |
| Optional Powder Coat Finishes: | ____ (B) Mineral Bronze (standard color) ____ (BK) Black ____ (FBK) Flat Black ____ (W) White ____ (SB) SC Beige ____ (SI) Silver ____ (S) Sand ____ (AB) AMS Beige ____ (R) Red ____ (GH) Gray Hammertone ____ (G) Gray View Color Samples Online |



Transoms & Sidelites- Mullions for One Side

| # Mullions | Model |
|---|-------|
| 1 | FRMA2 |
| 2 | FRMA3 |
| 2 | FRMB2 |
| 3 | FRMB3 |
| 4 | FRMB4 |
| 4 | FRMC3 |
| 3 | FRMA4 |
| 4 | FRMA5 |
| 5 | FRMB5 |
| 5 | FRMC4 |
| 6 | FRMC5 |
| Mullions are Constructed of 3/4" x 3/4" Steel Tubes | |

OPTIONS AT ADDITIONAL COST:

| | |
|----------------------------------|---|
| Mullions: | ____ Other sizes available, consult Customer Service |
| Finishes & Materials: | ____ Galvanized steel. |
| Fasteners: | ____ Torx ____ Other: _____ |
| Custom: | Custom frame sizes or specials. Contact Customer Service. |

NOTE: NEW CODES FOR MULLIONS SHOWN BELOW

| A2 | A3 | B2 | B3 | B4 | C3 | A4 | A5 | B5 | C4 | C5 |
|----|----|----|----|----|----|----|----|----|----|----|
| | | | | | | | | | | |
| | | | | | | | | | | |
| | | | | | | | | | | |
| | | | | | | | | | | |
| | | | | | | | | | | |
| | | | | | | | | | | |
| | | | | | | | | | | |
| | | | | | | | | | | |
| | | | | | | | | | | |

Select Mullion Layout Here for Pages V10 and V11

Order Format: FRM

MULLION W H Color Code

Example: FRMB5 2880B

Interpretation of Fire and Building Codes May Vary. Consult with the Local Authority Having Jurisdiction (AHJ) to determine appropriate standards.

| | | |
|---|---------------------|---|
| <p>© 2017 Activar Construction Products Group, Inc.</p> | Distributor: | Width: ____ x Height: ____ |
| | Architect: | Quantity: |
| | Contractor: | Model: |
| | Project: | Date: ____ Version: ALPDS1612 |
| <p>800-554-6077 QUOTES@ACTIVARCPG.COM ORDERS@ACTIVARCPG.COM SALES@ACTIVARCPG.COM FAX: 952-835-2218</p> <p>VISIT WWW.ACTIVARCPG.COM FOR THE MOST UPDATED PRODUCT INFORMATION BEFORE ORDERING</p> <p>MFG: COMMERCE CA, BLOOMINGTON, MN • WAREHOUSES: LANCASTER PA, ATLANTA GA, CHICAGO IL, SEATTLE WA, FORT MYERS FL, DALLAS TX, FARGO ND, OMAHA NE</p> | | |

V12

VLF CUSTOM SHAPES

Many Specialty Designs Can be Manufactured Using the VLF Profile Including the Examples Shown

SPECIFICATIONS:

| | |
|---|---|
| Material: | 18 gauge CRS frame. |
| Construction: | Radius and half round are constructed with radius corners, mitered and welded with no exposed joints. Holes are countersunk on both sides. |
| Door: | For 1-3/4" door. Door cutout = order size. |
| Fasteners: | #8 x 32 Phillips head thru bolts with blank head one side to match finish. |
| Powder Coat Finishes: | ____ (B) Mineral Bronze (standard color) ____ (BK) Black ____ (FBK) Flat Black ____ (W) White ____ (SB) SC Beige ____ (SI) Silver ____ (R) Red ____ (S) Sand ____ (AB) AMS Beige ____ (G) Gray ____ (GH) Gray Hammertone View Colors Online |
| Glass: | 3/16" - 1/4" glazing to be ordered separately from Glazing Section of catalog. Use fire rated glazing with Warnock Hersey (WHI) or UL classification markings for fire rated applications. Visible light is 1" under rough opening size. Glass is 1/4" under order size. Fire-Rated Air Louvers Glazing to fit this vision frame: WS, KFRF, PPF. Non Fire-Rated Glazing: TEMP. Not all glazing types available for all shapes. |
| Fire-Rating, Testing & Listings: | When installed in properly rated and approved door, ratings up to 3 hours can be achieved, depending on the glazing used. See glazing ratings for max exposed area. Tested and Listed for UL 10C and Criteria of UBC 7-2 Positive Pressure. See detailed installation instructions. |

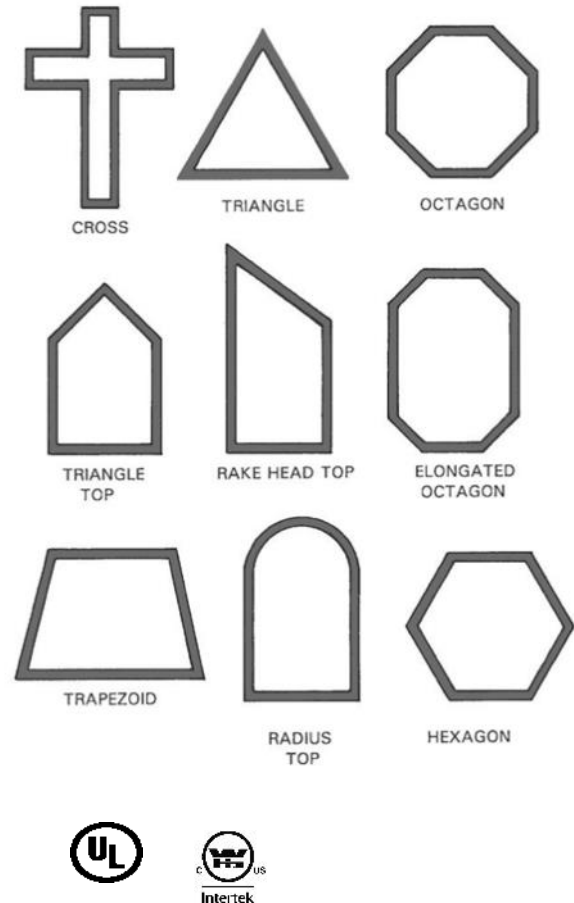

OPTIONS AT ADDITIONAL COST:

| | |
|----------------------------------|--|
| UBC 7-2 Installation: | ____ Additional intumescent tape for Positive Pressure UL10C . See detailed installation instructions. |
| Finishes & Materials: | ____ (S) 18 Gauge Stainless Steel: #4 Finish. ____ (G) Galvanized Sheet for Exterior Applications. ____ (E) Electro Zinc Plating for Maximum Corrosion Resistance. |
| Fasteners: | ____ Torx ____ Other: _____ |
| Custom: | Custom frame sizes, leadlined. Contact Customer Service & Provide Detailed Dimensions Information. |

DETAILED DRAWING WITH DIMENSIONS IS TO BE ATTACHED TO THIS PAGE

Interpretation of Fire and Building Codes May Vary. Consult with the Local Authority Having Jurisdiction (AHJ) to determine appropriate standards.

| | | |
|---|---------------------|--|
| <p>© 2017 Activar Construction Products Group, Inc.</p> | Distributor: | Width: ____ x Height: ____ |
| | Architect: | Quantity: |
| | Contractor: | Model: |
| | Project: | Date: Version: ALPDS1612 |
| <p>800-554-6077 QUOTES@ACTIVARCPG.COM ORDERS@ACTIVARCPG.COM SALES@ACTIVARCPG.COM Fax: 952-835-2218</p> <p>VISIT WWW.ACTIVARCPG.COM FOR THE MOST UPDATED PRODUCT INFORMATION BEFORE ORDERING</p> <p>MFG: COMMERCE CA, BLOOMINGTON, MN • WAREHOUSES: LANCASTER PA, ATLANTA GA, CHICAGO IL, SEATTLE WA, FORT MYERS FL, DALLAS TX, FARGO ND, OMAHA NE</p> | | |

10 GAUGE SECURITY VISION LITE: VLFS10™ & VLFS10SP™ - REV A

V13

Security & Detention Vision Frame - Optional Speaker Port. Accommodates Glazing 1/4" - 1-11/16"
Including Our Bullet-Resistant Glazing Selections

SPECIFICATIONS:

| | |
|---|---|
| Material: | 10 gauge CRS frame and 10 gauge perforated steel panel. Min size 4" x 4", Max 60" x 104". See Fire Rating Below. |
| Construction: | 1-1/4" trim with mitered and welded corners, countersunk mounting holes both sides, and 1" wide glazing retainer. |
| Door: | For 1 to 3" thick door. Specify door thickness: ____ Door cutout = order size. Note: If glass thickness > door thickness, frame will be designed to fit the glass. |
| Powder Coat Finishes: | ____ (B) Mineral Bronze (standard color) View Colors Online ____ (BK) Black ____ (FBK) Flat Black ____ (W) White ____ (R) Red ____ (SB) SC Beige ____ (SI) Silver ____ (S) Sand ____ (AB) AMS Beige ____ (GH) Gray Hammertone ____ (G) Gray |
| Fasteners: | #8 x 32 Torx head security binder bolt with blank head one side to match finish. |
| Glass: | ____ " Glass Thickness Will Be Used for this Order. 1/4" - 1 11/16" glazing to be ordered separately from Glazing Section of catalog. Use fire rated glazing with Warnock Hersey (WHI) or UL classification markings for fire rated applications. Visible light is 2-1/2" under rough opening size. Specify glass above. <u>Glass is 1/4" under order size.</u> If glazing is being provided by a supplier other than Air Louvers, coordinate with the supplier to ensure compatibility with IG kits. See note in Door section above. Air Louvers Glazing to fit this vision frame: WS, KFRF, PPF, KFRL, KFRFU, CONTRA45, CONTRA 60, 90, ARMRSIELD, LGSIELD. |
| Fire-Rating, Testing & Listings: | When installed in properly rated and approved door, ratings up to 90 minutes can be achieved for model VLFS10 only, depending on the glazing used. See glazing ratings for max exposed area. Tested and Listed for UL 10C and Criteria of UBC 7-2 Positive Pressure. VLFS10SP not fire-rated. |

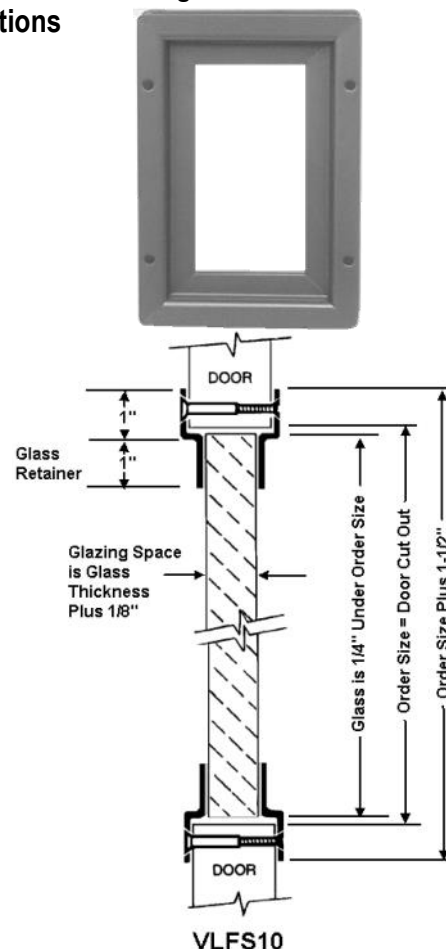

OPTIONS AT ADDITIONAL COST:



| | |
|--|--|
| Finishes & Materials: | ____ (G) Galvanized Sheet for Exterior Applications. ____ (E) Electro Zinc Plating for Maximum Corrosion Resistance. |
| Fasteners: | ____ Other: _____ |
| Speaker Panel/ Glass Combination: | ____ (S10SP) 10 gauge CRS frame and 10 gauge perforated steel speaker panel with staggered holes. Speaker panel not fire, or pressure-rated. Complete Info Below: ____ W x ____ H Glass ____ W x ____ H Speaker Panel—Total of both is to equal order size minus 1/4". Example: if order size is 7" x 21", Glass could be 6-3/4" x 10 & Speaker Panel could be 6-3/4" x 10-3/4". Total W = 6-3/4" and Total H = 20-3/4" |
| Privacy Screen: | Add the New Privacy Screen to This Vision Lite— See Web Page for Details |
| Custom: | Smaller or larger sizes, or other options. Contact Customer Service for special orders. |



S10SP With Optional Speaker Panel

Order Format: VLFS10

Option G,E W H Color Glass Thickness

Example: VLFS10 1212G 01

Interpretation of Fire and Building Codes May Vary. Consult with the Local Authority Having Jurisdiction (AHJ) to determine appropriate standards.

| | | |
|--|---------------------|-------------------------------------|
| © 2017 Activar Construction Products Group, Inc. | Distributor: | Width: ____ x Height: ____ |
| | Architect: | Quantity: ____ Door Thickness: ____ |
| | Contractor: | Glass Thickness: ____ |
| | Project: | Date: ____ Version: ALPDS1612 |
| 800-554-6077 QUOTES@ACTIVARCPG.COM ORDERS@ACTIVARCPG.COM SALES@ACTIVARCPG.COM FAX: 952-835-2218 VISIT WWW.ACTIVARCPG.COM FOR THE MOST UPDATED PRODUCT INFORMATION BEFORE ORDERING | | |
| MFG: COMMERCE CA, BLOOMINGTON, MN • WAREHOUSES: LANCASTER PA, ATLANTA GA, CHICAGO IL, SEATTLE WA, FORT MYERS FL, DALLAS TX, FARGO ND, OMAHA NE | | |

V14 VISION FRAME WITH 12 GAUGE SECURITY GRILLES: VLF-SG™ - REV A

Security Vision Frame With Security Grille Each Side of Glass

SPECIFICATIONS:

| | |
|---|---|
| Material: | 18 gauge CRS frame. Min size 4" x 4", Max 60" x 72". See Fire Rating Below. |
| Grille: | 12 gauge CRS with 13/16" square openings 1" on center. |
| Construction: | Mitered and welded corners, countersunk mounting holes both sides, security grille welded to frame. |
| Powder Coat Finishes: | ____ (B) Mineral Bronze (standard color) ____ (BK) Black ____ (FBK) Flat Black ____ (W) White ____ (SB) SC Beige ____ (SI) Silver ____ (R) Red ____ (S) Sand ____ (AB) AMS Beige ____ (G) Gray ____ (GH) Gray Hammetone View Colors Online |
| Door: | For 1-3/4" door. Door cutout = order size. |
| Fasteners: | #8 x 32 Phillips head thru bolts with blank head one side to match finish. |
| Glass: | 3/16" - 1/4" glazing to be ordered separately from Glazing Section of catalog. Use fire rated glazing with Warnock Hersey (WHI) or UL classification markings for fire rated applications. Visible light is 1" under rough opening size. Glass size is 1/4" under order size. Fire-Rated Air Louvers Glazing to fit this vision frame: WS, KFRF, PPF |
| Fire-Rating, Testing & Listings: | When installed in properly rated and approved door, ratings up to 90 minutes can be achieved, depending on the glazing used. See glazing ratings for max exposed area. Tested and Listed for UL 10C and Criteria of UBC 7-2 Positive Pressure. See detailed installation instructions. |

OPTIONS AT ADDITIONAL COST:



| | |
|----------------------------------|--|
| UBC 7-2 Installation: | ____ Additional intumescent tape for Positive Pressure UL10C . See detailed installation instructions. |
| Finishes & Materials: | ____ (S) Stainless Steel: #4 Finish - Contact Manufacturer for Details. ____ (G) Galvanized Sheet for Exterior Applications. ____ (E) Electro Zinc Plating for Maximum Corrosion Resistance. |
| Fasteners: | ____ Torx ____ Other: _____ |
| Privacy Screen: | Add the New Privacy Screen to This Vision Lite— See Web Page for Details |
| Custom: | Smaller or larger sizes, leadlined. Consult Customer Service. |



VLF-SG

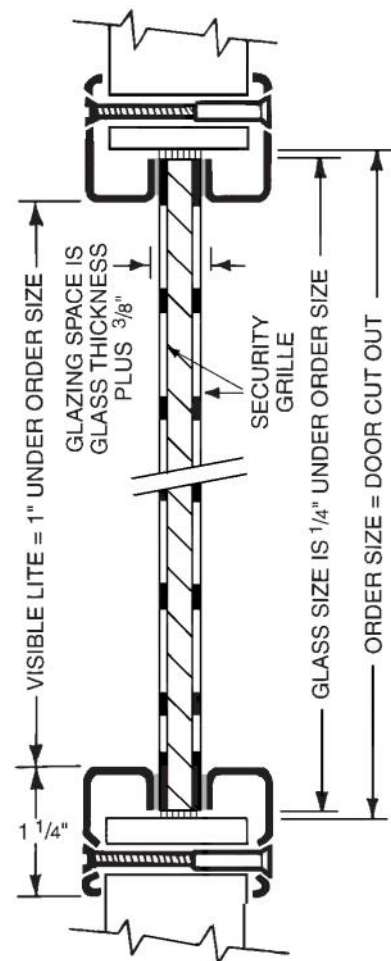

Order Format: VLF-SG

Option S,G,E

W

H

Color

Example: VLFSG 1212 W

Interpretation of Fire and Building Codes May Vary. Consult with the Local Authority Having Jurisdiction (AHJ) to determine appropriate standards.

| | | |
|--|---------------------|---|
| © 2017 Activar Construction Products Group, Inc. | Distributor: | Width: ____ x Height: ____ |
| | Architect: | Quantity: |
| | Contractor: | Model: |
| | Project: | Date: ____ Version: ALPDS1612 |
| 800-554-6077 QUOTES@ACTIVARCPG.COM ORDERS@ACTIVARCPG.COM SALES@ACTIVARCPG.COM Fax: 952-835-2218 VISIT WWW.ACTIVARCPG.COM FOR THE MOST UPDATED PRODUCT INFORMATION BEFORE ORDERING MFG: COMMERCE CA, BLOOMINGTON, MN • WAREHOUSES: LANCASTER PA, ATLANTA GA, CHICAGO IL, SEATTLE WA, FORT MYERS FL, DALLAS TX, FARGO ND, OMAHA NE | | |

HURRICANE & HIGH WIND VELOCITY PAK: VLFIGHRC PAK™

V15

Recommended for Applications Requiring Safety From Wind-Borne Debris.
Includes Tested and Approved, Glazing Components as Listed Below.

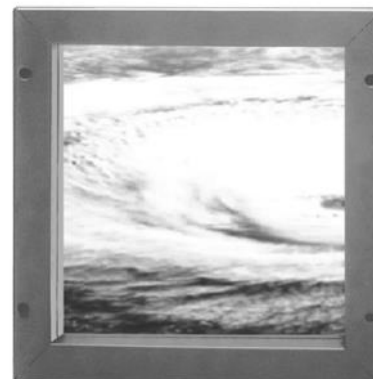

SPECIFICATIONS:

| | |
|------------------------------|---|
| Material: | 18 gauge galvalume steel frame. Min size 3" x 3". Max size 30" x 60-1/2" |
| Construction: | 1-1/2" trim with mitered and welded corners, square return and countersunk mounting holes on both sides. |
| Sealing: | <p>Between Frame & Glass: Sponge rubber, EPDM, neoprene press-on glazing tape 1/8" x 3/8". Dow Corning #995 (or equal) silicone structural glazing sealant applied per Dow Corning instructions.</p> <p>Between Door & Frame Perimeter: Closed cell EPDM press-on glazing tape 1/4" x 3/8" applied to inside face of lite kit frame.</p> <p>Screw Entry Points: Includes Neoprene "O"-Rings, 7/32" I.D. with 1/16" wall, 50-70 Durometer, to be used at each screw head.</p> <p>Setting Blocks to Suit: EPDM or neoprene setting blocks 1/16" minimum thickness at quarter points of bottom of glass and elsewhere as needed.</p> |
| Powder Coat Finishes: | <p>____ (B) Mineral Bronze (standard color)</p> <p>____ (BK) Black ____ (FBK) Flat Black ____ (W) White</p> <p>____ (SB) SC Beige ____ (SI) Silver ____ (R) Red</p> <p>____ (S) Sand ____ (AB) AMS Beige ____ (G) Gray</p> <p>____ (GH) Gray Hammertone View Colors Online</p> |
| Door: | For 1-3/4" to 3" door. Door Size: ____ Door cutout = order size. |
| Fasteners: | #8 x 32 Phillips head thru bolts with blank head one side to match finish. |
| Glass: | Glass in Included with Each Unit: Glass 5/16" thick configuration; (2) 1/8" heat-strengthened glass lites separated by 0.075" interlayer. |
| Privacy Screen: | Add the New Privacy Screen to the interior side of this Vision Lite— See Web Page for Details |

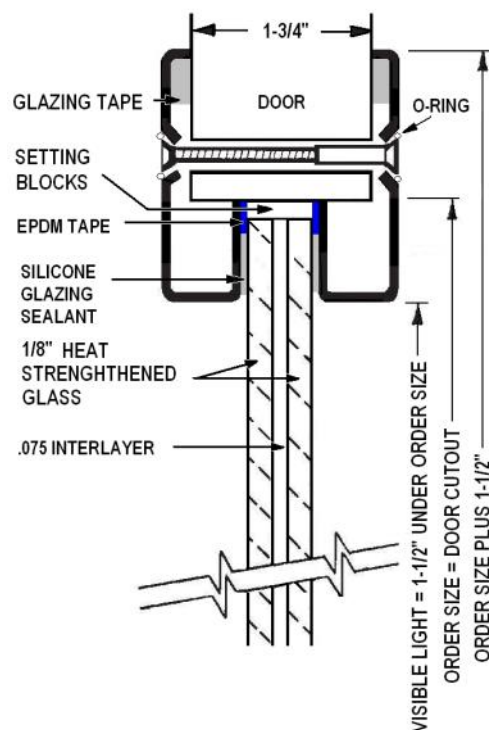

Severe Windstorm Approved Vision Frame

Tested in Accordance with
ASTM E330, ASTM E1886, ASTM E1996
ANSI A250.13
Impact (ft lb) 350
Missile Level D Structural (PSF) +/- 70



Interpretation of Fire and Building Codes May Vary. Consult with the Local Authority Having Jurisdiction (AHJ) to determine appropriate standards.

| | | |
|--|---------------------|-------------------------------|
| © 2017 Activar Construction Products Group, Inc. | Distributor: | Width: ____ x Height: ____ |
| | Architect: | Quantity: |
| | Contractor: | Door Thickness: |
| | Project: | Date: ____ Version: ALPDS1612 |
| 800-554-6077 QUOTES@ACTIVARCPG.COM ORDERS@ACTIVARCPG.COM SALES@ACTIVARCPG.COM FAX: 952-835-2218 VISIT WWW.ACTIVARCPG.COM FOR THE MOST UPDATED PRODUCT INFORMATION BEFORE ORDERING | | |
| MFG: COMMERCE CA, BLOOMINGTON, MN • WAREHOUSES: LANCASTER PA, ATLANTA GA, CHICAGO IL, SEATTLE WA, FORT MYERS FL, DALLAS TX, FARGO ND, OMAHA NE | | |

V16 REV A HURRICANE & HIGH WIND VELOCITY PAK: VLFEZHRC PAK™

Beveled Vision Lite With Continuous Glass Retainer. Recommended for Applications Requiring Safety From Wind-Borne Debris. Includes Tested and Approved Polycarbonate Glazing and Caulking.
Now Miami Dade, County Florida and Florida Building Code Approved!

SPECIFICATIONS:

| | |
|--|---|
| Material: | 20 gauge galvalume steel frame. Min size 3" x 3", max 23 5/8" x 61 3/8". See Windstorm Rating Below |
| Construction: | 1-1/4" trim with mitered and welded corners, beveled return, and countersunk mounting holes in the bevel. Screws fasten from room side into pre-punched mounting holes. This mounting method leaves corridor side of frame free of fasteners for aesthetic and security purposes. |
| Powder Coat Finishes: | ____ (B) Mineral Bronze (standard color) ____ (BK) Black ____ (FBK) Flat Black ____ (W) White ____ (SB) SC Beige ____ (SI) Silver ____ (R) Red ____ (S) Sand ____ (AB) AMS Beige ____ (G) Gray ____ (GH) Gray Hammetone View Colors Online |
| Door: | For 1-3/4" door. Door cutout = order size. |
| Fasteners: | #8 x 1" flathead phillips head screws to match finish. |
| Glazing: | 1/4" Lexan® Glazing Included Glass size is 1" under order size |
| Caulking: | Dow Corning 995® for caulking on both sides of glazing. |
| Glazing & Caulking included with Vision Frame | |

Severe Windstorm Approved Vision Frame

Tested in Accordance with W/N 14475

ASTM E283, ASTM E331, A870, AAMA 1304

Cyclic wind Pressure Loading: FBC & TAS 203-94

Large Missile Impact Test: FBC & TAS 201-94.

Air Infiltration Test, Uniform Static Air Pressure Test-Loading, Water Resistance

Test, Forced Entry Test: FBC 2411, 3.2.1 & TAS 202-94

Impact (ft lb) 350

Missile Level D, DP Rating (PSF) 55

Florida Building Code Approval File # FL13187-R2



**New Miami Dade, County
Florida Approval!**
NOA: 17-0404.01
Expires 7/03/2020

OPTIONS AT ADDITIONAL COST:

Fasteners: ____ Torx ____ Other: ____

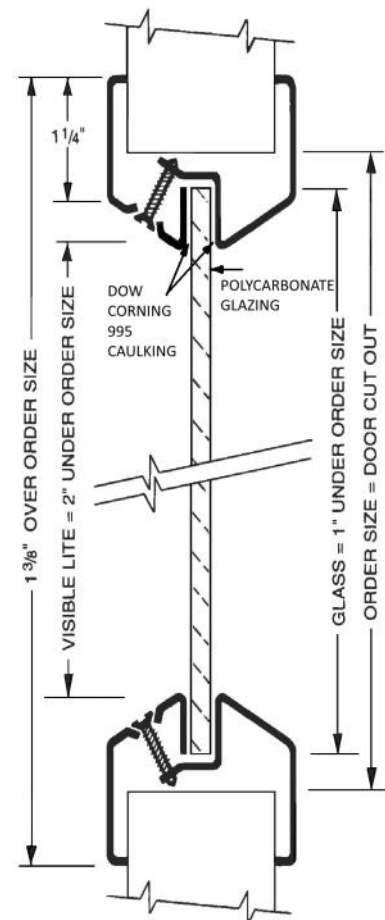
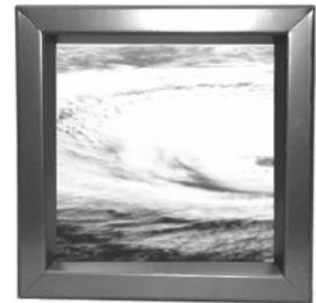

Order Format: VLFEZHRC

____ W ____ H ____ Color

Example: VLFEZHRC 1212B PAK

Interpretation of Fire and Building Codes May Vary. Consult with the Local Authority Having Jurisdiction (AHJ) to determine appropriate standards.

| | | |
|--|---------------------|--|
| © 2017 Activar Construction Products Group, Inc. | Distributor: | Width: ____ x Height: ____ |
| | Architect: | Quantity: |
| | Contractor: | Model: |
| | Project: | Date: Version: ALPDS1612 |
| 800-554-6077 QUOTES@ACTIVARCPG.COM ORDERS@ACTIVARCPG.COM SALES@ACTIVARCPG.COM Fax: 952-835-2218 VISIT WWW.ACTIVARCPG.COM FOR THE MOST UPDATED PRODUCT INFORMATION BEFORE ORDERING MFG: COMMERCE CA, BLOOMINGTON, MN • WAREHOUSES: LANCASTER PA, ATLANTA GA, CHICAGO IL, SEATTLE WA, FORT MYERS FL, DALLAS TX, FARGO ND, OMAHA NE | | |

COMBINATION HURRICANE & FIRE-RATED PAK: VLFIGHRC-F PAK™ REV A V17

Now Miami Dade County Florida and Florida Building Code Approved! Recommended for Applications Requiring Safety From Wind-Borne Debris. Includes Tested and Approved, Fire-Rated Glazing.

SPECIFICATIONS:

| | |
|------------------------------|--|
| Material: | 18 gauge galvalume steel frame. |
| Sizes: | Minimum Size: Width 5", Height 12.25". See Glass for maximum sizes. |
| Construction: | 1-1/2" trim with mitered and welded corners, square return and counter-sunk mounting holes on both sides. |
| Sealing: | Between Frame & Glass: EPDM-Neoprene glazing tape. Structural silicone glazing sealant applied per mfg. instructions. Screw Entry Points: Neoprene "O"-Ring, 7/32" and 5/32" I.D. with 1/16" wall, are provided to be used at each screw head. |
| Powder Coat Finishes: | ____ (B) Mineral Bronze (standard color) ____ (BK) Black ____ (FBK) Flat Black ____ (W) White ____ (SB) SC Beige ____ (SI) Silver ____ (R) Red ____ (S) Sand ____ (AB) AMS Beige ____ (G) Gray ____ (GH) Gray Hammettone View Colors Online |
| Door: | For 1-3/4" door. Door cutout = order size. |
| Fasteners: | #8 x 32 Phillips head thru bolts with blank head one side matching finish. |
| Glass: | Special 1-7/16" lamination of Safti-First® II-XL 60 hurricane-rated glazing with Dupont Sentry Plus® interlayer and 60 minute fire-rated glazing. Visible light is 1-1/2" under rough opening size. Glass size is 1/4" under order size. Maximum Visible Light 20/45 Minute: 1209.94 in ² Maximum Visible Light 60 Minute: 100 in ² . See supplemental size chart for details on sizes and ratings. |

Each lite of glazing will be permanently labeled with the product and manufacturer's name, testing laboratory, fire rating period and safety glazing standards.

Tested in Accordance with:

ASTM E283, E331, ASTM A370, AAMA1304

NFPA 252, UL10C, Can/ULC S104

Cyclic wind Pressure Loading: FBC & TAS 203-94

Large Missile Impact Test: FBC & TAS 201-94.

Air Infiltration Test, Uniform Static Air Pressure Test-Loading, Water Resistance

Test, Forced Entry Test: FBC & TAS 202-94

Forced Entry Test: FBC2441, 3.2.1, TAS202-94

FLORIDA BUILDING CODE APPROVAL: FL13187-R2

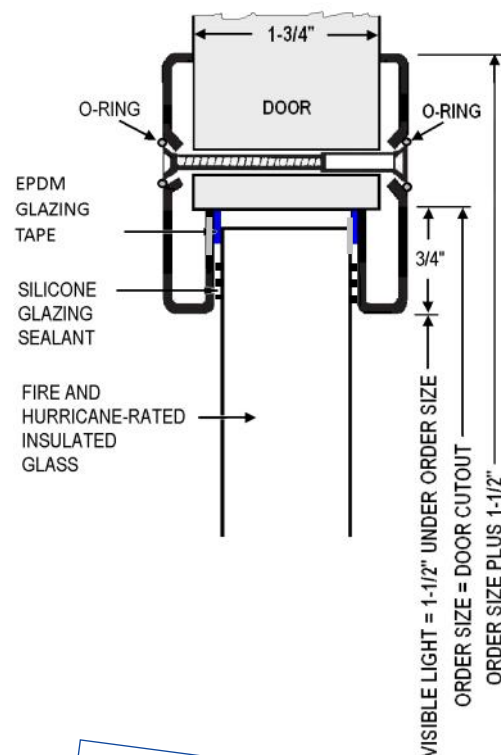

**Miami Dade, County
Florida Approval!**
NOA: 17-0404.01
Expires 7/03/2020

See supplemental sheet for details on sizes and ratings.

Interpretation of Fire and Building Codes May Vary. Consult with the Local Authority Having Jurisdiction (AHJ) to determine appropriate standards.

| | | | |
|--|---------------------|--|---------------------------|
| © 2017 Activar Construction Products Group, Inc. | Distributor: | Width: ____ x Height: ____ | |
| | Architect: | Quantity: | |
| | Contractor: | 20/40 Minute ____ 60 Minute ____ | |
| | Project: | Date: | Version: ALPDS1612 |
| 800-554-6077 QUOTES@ACTIVARCPG.COM ORDERS@ACTIVARCPG.COM SALES@ACTIVARCPG.COM FAX: 952-835-2218 VISIT WWW.ACTIVARCPG.COM FOR THE MOST UPDATED PRODUCT INFORMATION BEFORE ORDERING MFG: COMMERCE CA, BLOOMINGTON, MN • WAREHOUSES: LANCASTER PA, ATLANTA GA, CHICAGO IL, SEATTLE WA, FORT MYERS FL, DALLAS TX, FARGO ND, OMAHA NE | | | |

Velo™ - An Innovative Concept for Adding Privacy to Doors and Windows

Air Louver's "Velo" Privacy Screen™ is a cost-effective system to add privacy to doors and windows blocking all light and vision.



Velo Privacy Screen Key Benefits:

- Fits all manufacturer's vision lites
- Pulls down for privacy and retracts with a push of a button
- Maximum size has been increased to fit half-light size of 30" x 36"
- Less expensive than vision kits with mini-blinds encased in glass
- Installs in minutes
- Tested to 10,000 cycles
- Patent-Pending
- UL-Listed for use on up to 90 min. doors on metal vision frames.

For Use on Fire-Rated and Non-Rated Doors and Windows

- Educational Facilities
- Hospitals and Clinics
- Conference Rooms
- Laboratories
- Warehouses
- Offices

Typical Vision Lite with Privacy Screen Installed Side View

