



Attractive retrofit solution for
moderate-to-high traffic applications

Norton®

ASSA ABLOY

ASSA ABLOY, the global leader
in door opening solutions

410
S E R I E S

DOOR CLOSER

CATALOG

INTRODUCTION

The Norton 410 Series Cast Iron Door Closers provide an attractive retrofit solution for retail, office, government and other commercial facilities. Heavy-duty and hold open arms, along with adjustable spring size, backcheck, closing and latch speed, provide a flexible and economical closer that you can trust. The 410 Series is certified to ANSI/BHMA Grade 1 requirements for long life and reliability, and offers a 10 year warranty.



TABLE OF CONTENTS

Features, Functions, Certifications3

Applications4-5

Parts, Cover Dimensions, Accessories6-7

How to Order8



FEATURES

- » Adjustable spring sizes 1–6
- » Cast iron closer body
- » Standard and heavy-duty arms available as hold open or non-hold open
- » Adjustments for backcheck, closing and latch speed
- » Tri-packed for regular, parallel or top jamb installation
- » Sleeve nuts and bolts provided with each closer
- » Retrofit for LCN 4040XP
- » Non-handed
- » Plastic cover
- » 10 year warranty

FUNCTIONS

- » Backcheck
- » Closing speed
- » Latching speed
- » Delayed Action (optional)

CERTIFICATIONS

- » Certified for ANSI/BHMA A156.4 Grade 1 
- » UL/cUL listed for use on fire rated doors 
- » UL10C listed for positive pressure fire test
- » Meets requirements for Americans with Disabilities Act (ADA) and ANSI/BHMA A117.1 

APPLICATIONS

Standard Arms



TPN arm shown (regular mounting)

- » Pull-side application
- » Closer mounted on the door



TPN arm shown (top jamb mounting)

- » Push-side application
- » Closer mounted on the frame
- » Minimum top rail = 2-1/4" (57mm)
- » Maximum frame reveal = 2-3/4" (70mm)



TPN arm shown (parallel mounting)

- » Push-side application
- » Closer mounted on the door

Heavy Duty Arms



HDH arm (with stop) shown

- » Push-side application
- » Heavy-duty arm
- » Stop is removable



HDN arm (without stop) shown

- » Push-side application
- » Heavy-duty arm
- » Stop is removable

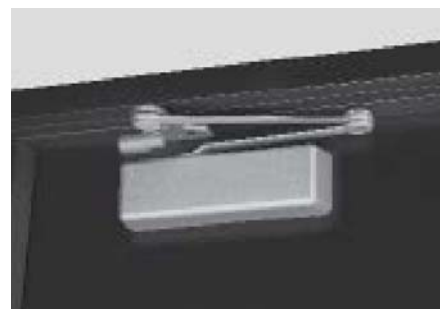

CPS arm shown

- » Push-side application
- » Heavy-duty arm
- » Buffer spring provides greater protection at the end of door opening cycle
- » Spring is removable

NOTE: Arms are not interchangeable with Norton's premium line of closers.

410 SERIES DOOR CLOSER

MODEL/PART NUMBERS

Model #	Description
410xTPN	Non-Hold Open, Tri-Packed
410DAxTPN	Non-Hold Open, Delayed Action, Tri-Packed
410xTPH	Hold Open, Tri-Packed
410xHDN	Heavy-Duty, Non-Hold Open with Removable Stop
410xHDH	Heavy-Duty, Hold Open with Removable Stop
410xCPS	Heavy-Duty, Non-Hold Open with Removable Stop and Spring Buffer
410xCPST	Heavy-Duty, Hold Open with Removable Stop and Spring Buffer

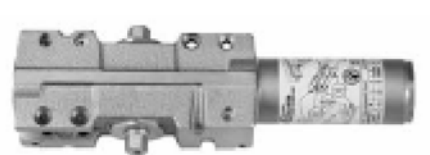

MISCELLANEOUS PARTS*

Part Number	Description
410COV	Cover
SP410	Screw Pack
CPSK6770	CPS Kit

*Specify finish when ordering



CPS Kit

COVER DIMENSIONS

Cover Dimensions		
Width	Length	Projection
3-1/2" (89mm)	12-1/4" (311mm)	2-1/4" (57mm)



OPTIONAL FASTENERS

Part Number	Description
SN-134	Sex Nuts
TBGN134-47	Through-Bolts & Grommet Nuts

Note: Sex nuts furnished standard with all models.

ACCESSORIES

Closer Mounting Plates

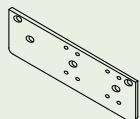

410RDP Narrow Frame Drop Plate (regular arm): Required for hinge side mount where top rail is less than 3-3/4" (95mm). Plate requires 2" (51mm) minimum top rail.

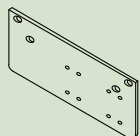

410PDP Narrow Top Rail Drop Plate (parallel arm): Required for parallel arm mounting where top rail is less than 5-1/2" (140mm), measured from the stop. Plate requires 2" (51mm) minimum top rail.

410 SERIES
DOOR CLOSER

HOW TO ORDER

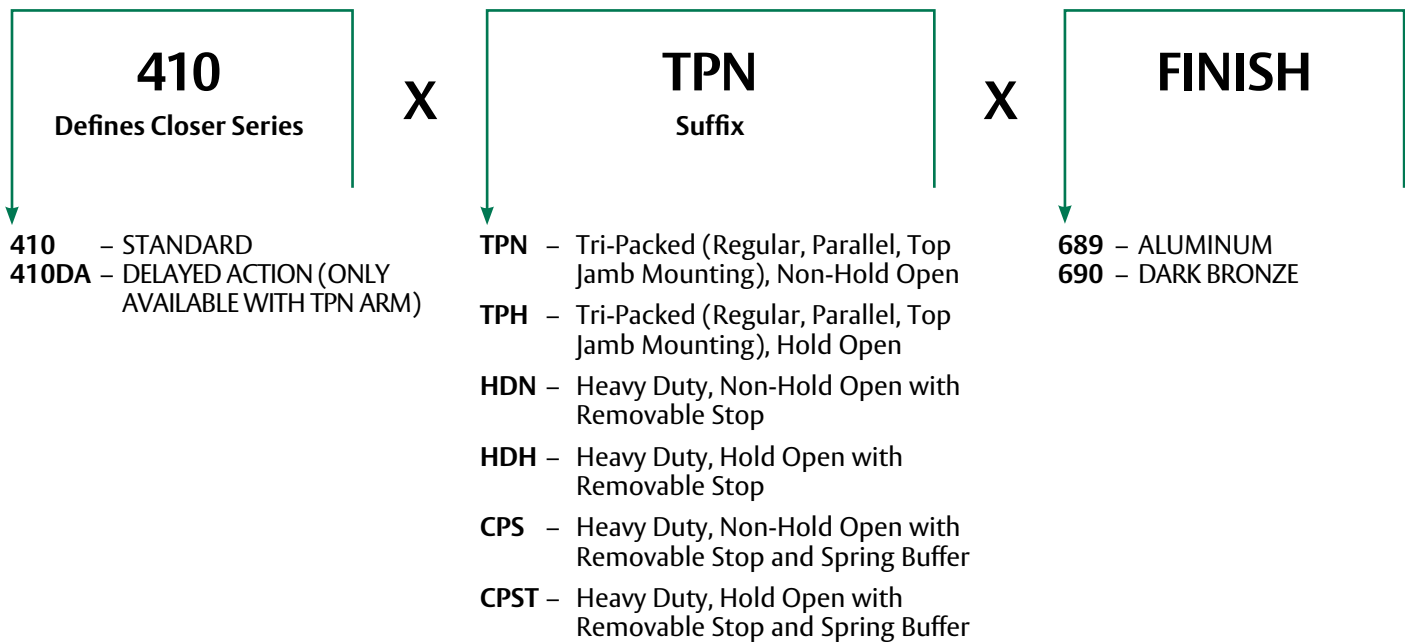

Notes:

- » Warranty becomes void if door closer is installed on the exterior side of a door in the exterior wall of a building.
- » It is strongly recommended, and required on fire door assemblies, that doors having a door closer be hung on ball bearing or anti-friction hinges or pivots; unless an alternate method is identified in the door manufacturer's listing.
- » Failure to use the correct type and size fasteners may void factory warranty.
- » Fasteners for fire/smoke door assemblies must conform to NFPA 80. In some applications additional fasteners may be mandated by NFPA 80 that are not shipped with standard Norton® product, such as sleeve-nuts/sex-nuts or through-bolts and grommet nuts.
- » Contact factory if door weight exceeds 250 lbs.

Norton®
ASSA ABLOY

ASSA ABLOY is the global leader in door opening solutions, dedicated to satisfying end-user needs for security, safety and convenience

Since 1880, Norton door controls have been an integral part of schools, hospitals and businesses around the globe. When you need products and people that perform at the highest level, rely on Norton – From Open to Close.

Norton Door Controls | www.nortondoорcontrols.com

3000 Highway 74 East | Monroe, NC 28112 | Tel: 1-877-974-2255 | Fax: 1-800-338-0965

ASSA ABLOY Door Security Solutions Canada | www.assaabloy.ca

160 Four Valley Drive | Vaughan, Ontario, L4K 4T9 Canada | Tel: 800-461-3007 | Fax: 1-905-738-2478

Norton is a brand associated with Yale Security Inc., an ASSA ABLOY Group company. Copyright © 2012–2017, Yale Security Inc. All rights reserved. Reproduction in whole or in part without the express written permission of Yale Security Inc. is prohibited.